

RS-455PA



Carbon-brush motors

OUTPUT : 3.0W~65W (APPROX)

WEIGHT : 145g (APPROX)

Typical Applications Office Automation Equipment : Printer

MODEL	VOLTAGE		NO LOAD		AT MAXIMUM EFFICIENCY				STALL			
	OPERATING RANGE	NOMINAL	SPEED r/min	CURRENT A	SPEED r/min	CURRENT A	TORQUE mN·m	TORQUE g·cm	OUTPUT W	TORQUE mN·m	TORQUE g·cm	CURRENT A
RS-455PA-15200	12~42	*42V CONSTANT	6300	0.058	5350	0.33	15.8	161	8.83	105	1070	1.85
RS-455PA-18140	12~30	21V CONSTANT	4500	0.078	3730	0.38	13.0	132	5.06	76.0	775	1.84

*This operating voltage indicates the peak value in case of pulse-width modulation (PWM) power supply. Besides, as withstand voltage, 1800V for one second can not be guaranteed.

DIRECTION OF ROTATION

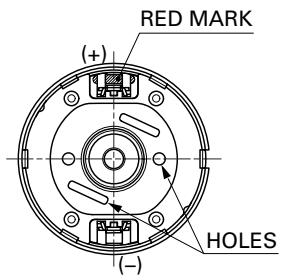
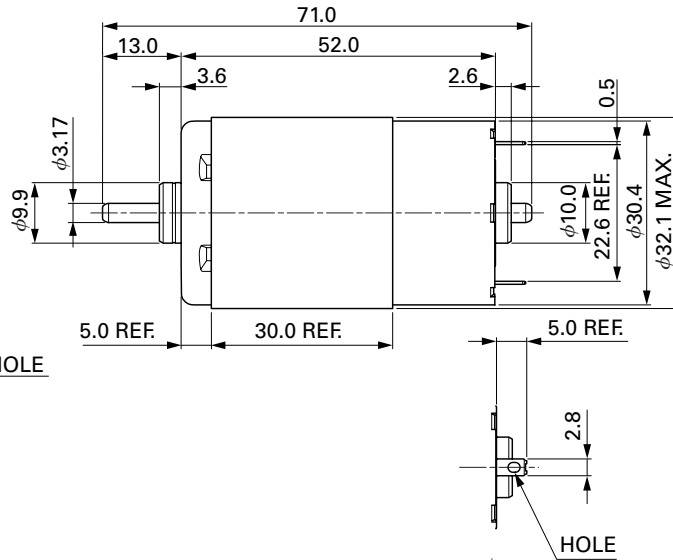
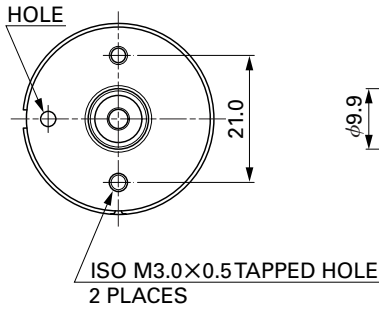

Usable machine screw length 4.0 max. from motor mounting surface.

UNIT: MILLIMETERS

RS-455PA-15200

42.0V

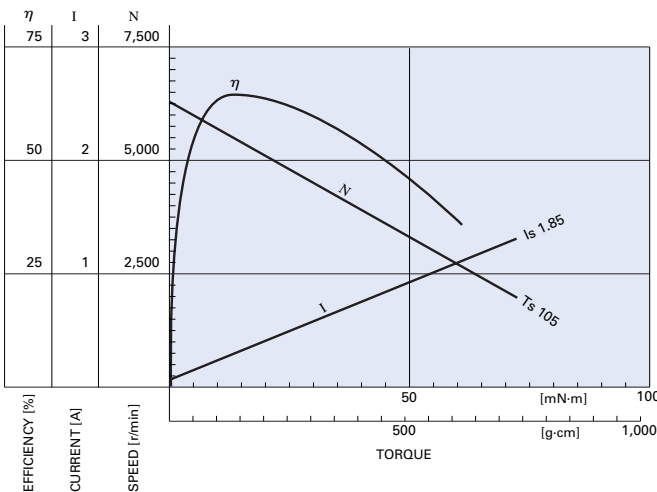

RS-455PA-18140

21.0V

