



Solid State Devices, Inc.

14701 Firestone Blvd * La Mirada, CA 90638
 Phone: (562) 404-4474 * Fax: (562) 404-1773
 ssdi@ssdi-power.com * www.ssdi-power.com

**SDR100S20
 Thru
 SDR100S50**

Electrical Characteristics		Symbol	Max	Typ	Units
Instantaneous Forward Voltage Drop ($T_A = 25^\circ\text{C}$, 300 μs pulse)	$I_F = 10\text{A}_{dc}$	V_{F1}	990	850	mV_{DC}
	$I_F = 25\text{A}_{dc}$	V_{F2}	1100	900	
	$I_F = 50\text{A}_{dc}$	V_{F3}	1200	950	
	$I_F = 75\text{A}_{dc}$	V_{F4}	1250	990	
	$I_F = 100\text{A}_{dc}$	V_{F5}	1325	1030	
Instantaneous Forward Voltage Drop ($T_A = -55^\circ\text{C}$, 300 μs pulse)	$I_F = 10\text{A}_{dc}$	V_{F6}	-	950	mV_{DC}
	$I_F = 25\text{A}_{dc}$	V_{F7}	-	1000	
	$I_F = 50\text{A}_{dc}$	V_{F8}	1290	1040	
	$I_F = 75\text{A}_{dc}$	V_{F9}	-	1080	
	$I_F = 100\text{A}_{dc}$	V_{F10}	1310	1110	
Instantaneous Forward Voltage Drop ($T_A = 100^\circ\text{C}$, 300 μs pulse)	$I_F = 10\text{A}_{dc}$	V_{F11}	-	750	mV_{DC}
	$I_F = 25\text{A}_{dc}$	V_{F12}	-	815	
	$I_F = 50\text{A}_{dc}$	V_{F13}	-	875	
	$I_F = 75\text{A}_{dc}$	V_{F14}	-	930	
	$I_F = 100\text{A}_{dc}$	V_{F15}	-	975	
Instantaneous Forward Voltage Drop ($T_A = 125^\circ\text{C}$, 300 μs pulse)	$I_F = 10\text{A}_{dc}$	V_{F16}	-	720	mV_{DC}
	$I_F = 25\text{A}_{dc}$	V_{F17}	-	780	
	$I_F = 50\text{A}_{dc}$	V_{F18}	1100	850	
	$I_F = 75\text{A}_{dc}$	V_{F19}	-	900	
	$I_F = 100\text{A}_{dc}$	V_{F20}	1250	950	
Instantaneous Forward Voltage Drop ($T_A = 150^\circ\text{C}$, 300 μs pulse)	$I_F = 10\text{A}_{dc}$	V_{F21}	-	680	mV_{DC}
	$I_F = 25\text{A}_{dc}$	V_{F22}	-	750	
	$I_F = 50\text{A}_{dc}$	V_{F23}	-	810	
	$I_F = 75\text{A}_{dc}$	V_{F24}	-	870	
	$I_F = 100\text{A}_{dc}$	V_{F25}	-	920	
Reverse Leakage Current (Rated V_R , $T_A = 25^\circ\text{C}$, 300 μs pulse minimum)		I_{R1}	10	0.1	μA
Reverse Leakage Current (Rated V_R , $T_A = 100^\circ\text{C}$, 300 μs pulse minimum)		I_{R2}	-	10	μA
Reverse Leakage Current (Rated V_R , $T_A = 125^\circ\text{C}$, 300 μs pulse minimum)		I_{R3}	1000	25	μA
Reverse Leakage Current (Rated V_R , $T_A = 150^\circ\text{C}$, 300 μs pulse minimum)		I_{R4}	-	75	μA
Reverse Recovery Time ($I_F = 500\text{mA}$, $I_R = 1\text{Amp}$, $I_{RR} = 250\text{mA}$, $T_A = 25^\circ\text{C}$)		t_{RR}	3	5	μsec
Junction Capacitance ($T_A = 25^\circ\text{C}$, $f = 1\text{MHz}$)	$V_R = 5V_{DC}$	C_J	-	420	pF
	$V_R = 10V_{DC}$		450	330	

Code	Configuration	Terminal	Stud
—	Normal	Anode	Cathode
R	Reverse	Cathode	Anode

NOTE: All specifications are subject to change without notification.
 SSD's for these devices should be reviewed by SSDI prior to release.

DATA SHEET #: RC0153A

DOC



Solid State Devices, Inc.

14701 Firestone Blvd * La Mirada, CA 90638
Phone: (562) 404-4474 * Fax: (562) 404-1773
ssdi@ssdi-power.com * www.ssdi-power.com

SDR100S20 Thru SDR100S50

DO-5 Outline (Normal Pin Configuration Shown):

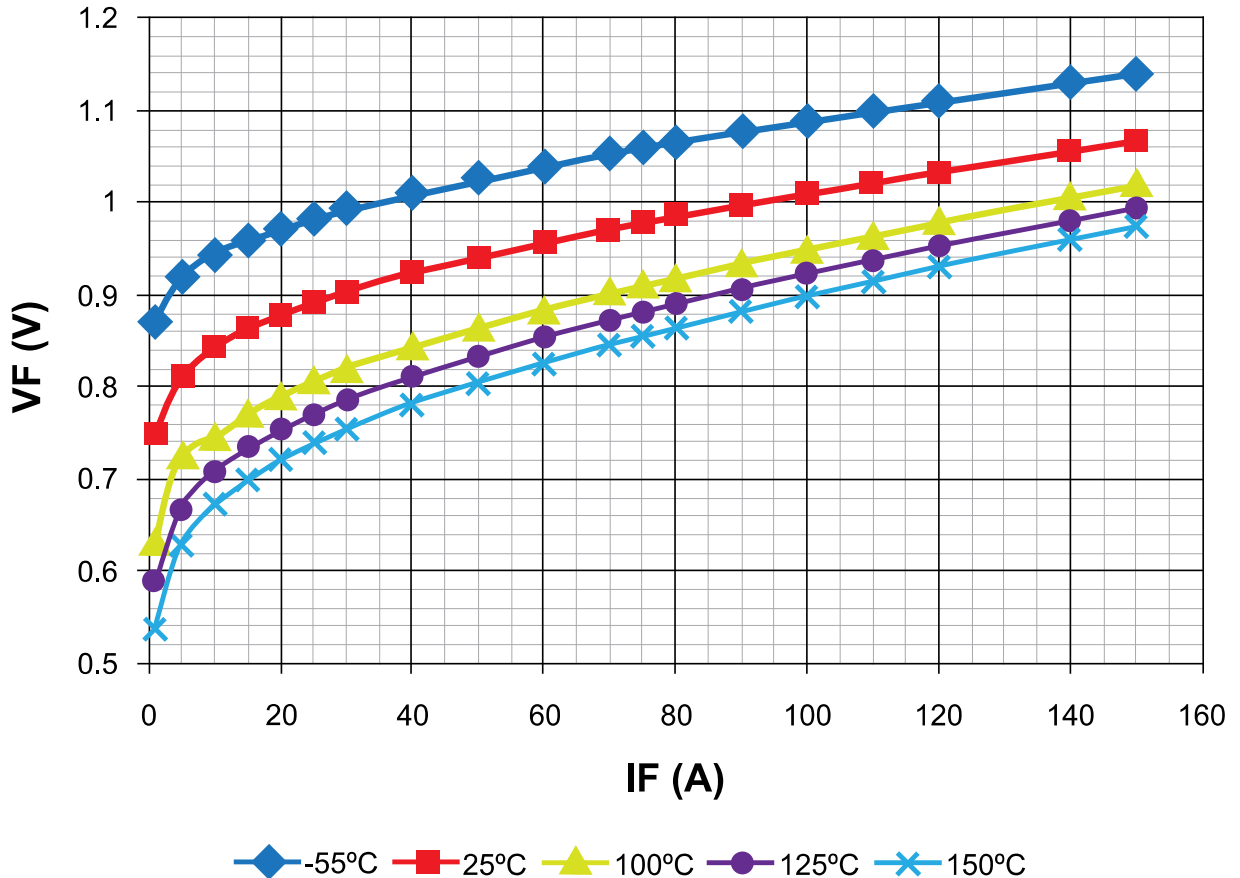
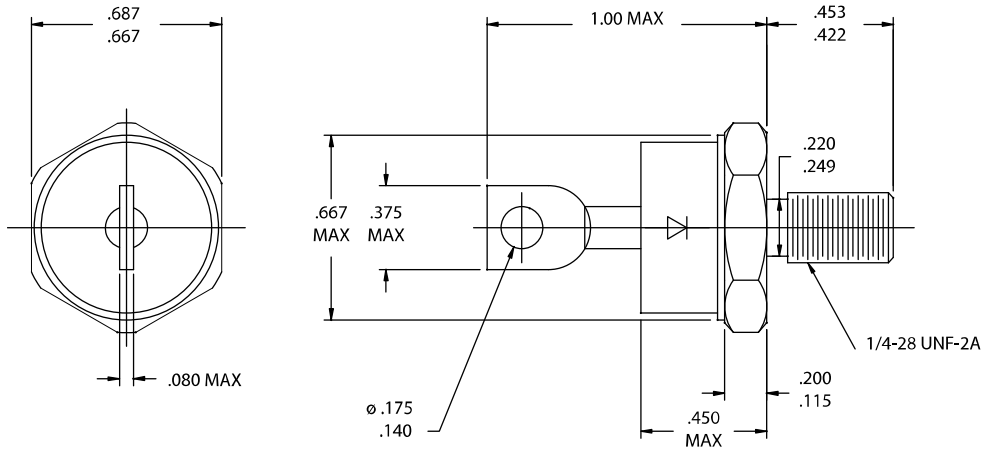

NOTE: All specifications are subject to change without notification. SCD's for these devices should be reviewed by SSDI prior to release.

DATA SHEET #: RC0153A

DOC