

**NEW!**

# Adapters, SMA-F to SMA-M

**SF-SM 50**

50Ω, DC to 18 GHz



## Features

- flat response
- excellent VSWR, 1.05:1 typ. up to 12.4 GHz and 1.15:1 typ. up to 18 GHz
- gold plated
- low cost adapters, available from stock

## Applications

- connector saver
- cable extender

## Electrical Specifications

MODEL NO.	CONNECTOR TYPE		FREQUENCY (GHz) $f_L$ - $f_U$	VSWR (:1) Max.			IMPEDANCE (OHMS)	CASE STYLE	PRICE \$ Qty. (1-49)
	CONN 1	CONN 2		DC-8 GHz	8-12.4 GHz	12.4-18 GHz			
SF-SM 50	SMA-Female	SMA-Male	DC-18	1.10	1.28	1.30	50	DJ836	8.95

## Maximum Ratings

Operating Temperature	-55°C to 100°C
Storage Temperature	-55°C to 100°C

## Outline Drawing

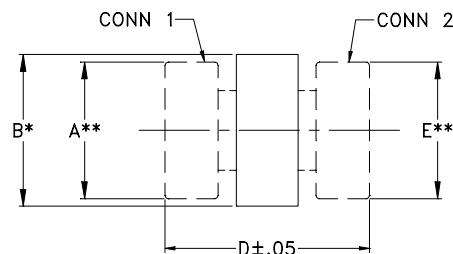

- \* MAX FOR DJ826, 827, 836.
- \*\* DIM IS ACROSS FLATS
- B - OVERALL ADAPTER DIMENSION  
BODY/CONNECTOR SHAPE VARIES

## Outline Dimensions (inch mm)

A	B	C	D	E	wt.
—	.36	—	0.72	.312	grams
—	9.14	—	18.29	7.92	3.2



Distribution Centers NORTH AMERICA 800-654-7949 • 417-335-5935 • Fax 417-335-5945 • EUROPE 44-1252-832600 • Fax 44-1252-837010

ISO 9001 CERTIFIED

INTERNET <http://www.minicircuits.com>

P.O. Box 350166, Brooklyn, New York 11235-0003 (718) 934-4500 Fax (718) 332-4661

REV. A  
M79447  
EC-9245A  
SF-SM50  
RS/TD/CP  
011217