



SF2098G

**915.00 MHz
SAW Filter**

- **Low-loss SAW Filter**
- **2.5 x 2.0 x 1.05 mm Surface-mount Case**
- **No Matching Circuit Required**
- **Complies with Directive 2002/95/EC (RoHS)**



Absolute Maximum Ratings

| Rating | Value | Units |
|--|-----------------|-------|
| Maximum Incident Power in Passband | +15 | dBm |
| Maximum DC voltage between any Two Terminals | 3 | VDC |
| Storage Temperature Range in Tape and Reel | -40 to +85 | °C |
| Maximum Reflow Soldering Profile | 265 °C for 10 s | |

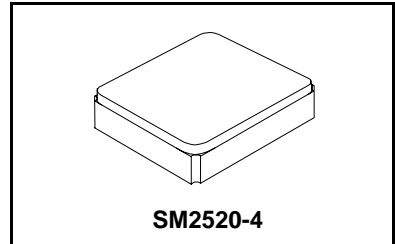

Electrical Characteristics

| Characteristic | Sym | Notes | Min | Typ | Max | Units |
|---|-------|-------|-----|-------|-------|-------------------|
| Center Frequency | f_c | | | 915 | | MHz |
| Insertion Loss, 902 to 928 MHz | IL | | | 2.2 | 3.0 | dB |
| Amplitude Ripple, 902 to 928 MHz | | | | 0.5 | 1.5 | dB _{p-p} |
| VSWR, 902 to 928 MHz | | | | 1.6:1 | 2.2:1 | |
| Attenuation (Reference level from 0 dB) | | | | | | dB |
| DC to 800 MHz | | | 45 | 63 | | |
| 800 to 870 MHz | | | 40 | 53 | | |
| 960 to 1080 MHz | | | 30 | 40 | | |
| 1080 to 2000 MHz | | | 35 | 53 | | |
| 2000 to 3000 MHz | | | 22 | 28 | | |
| Source impedance | Z_s | | | 50 | | Ω |
| Load impedance | Z_L | | | 50 | | Ω |
| Operating Temperature | T_A | | -40 | | +85 | °C |

| | |
|---|---|
| Single Ended Input / Output, Impedance match | No matching network required for operation at 50 ohms |
| Case Style | SM2520-4 |
| Lid Symbolization (2C=SF2098G Y=year, W=week) | 2C, YW |

Electrical Connections

| Connection | Terminals |
|------------|------------|
| Input | 1 |
| Output | 3 |
| Ground | All others |

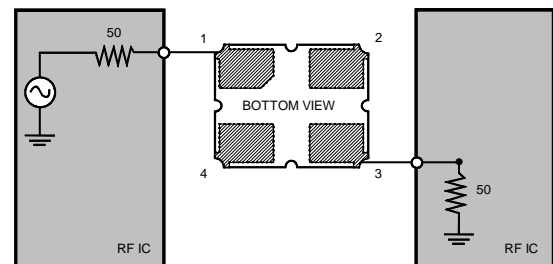

CAUTION: Electrostatic Sensitive Device. Observe precautions for handling.

Notes:

1. US and international patents may apply.
2. RFM, stylized RFM logo, and RF Monolithics, Inc. are registered trademarks of RF Monolithics, Inc.

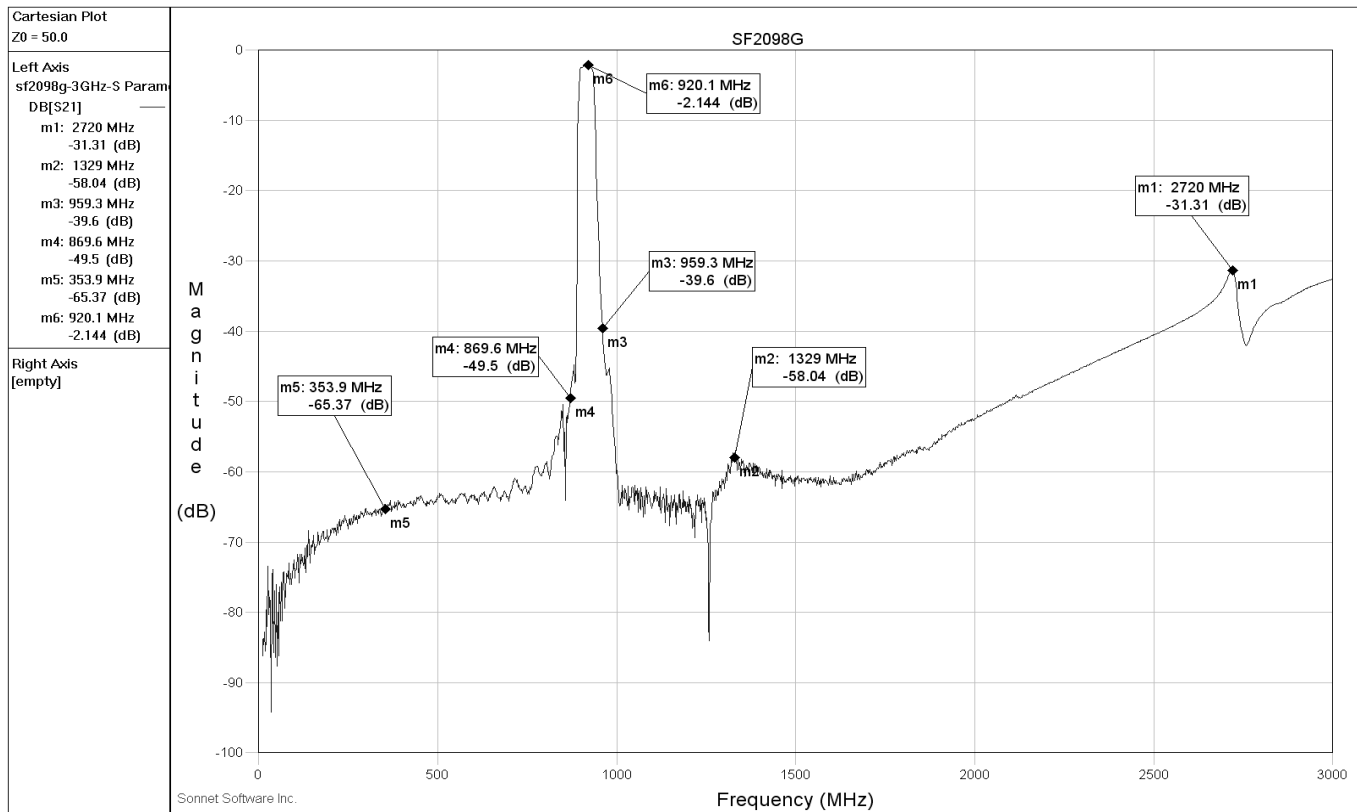
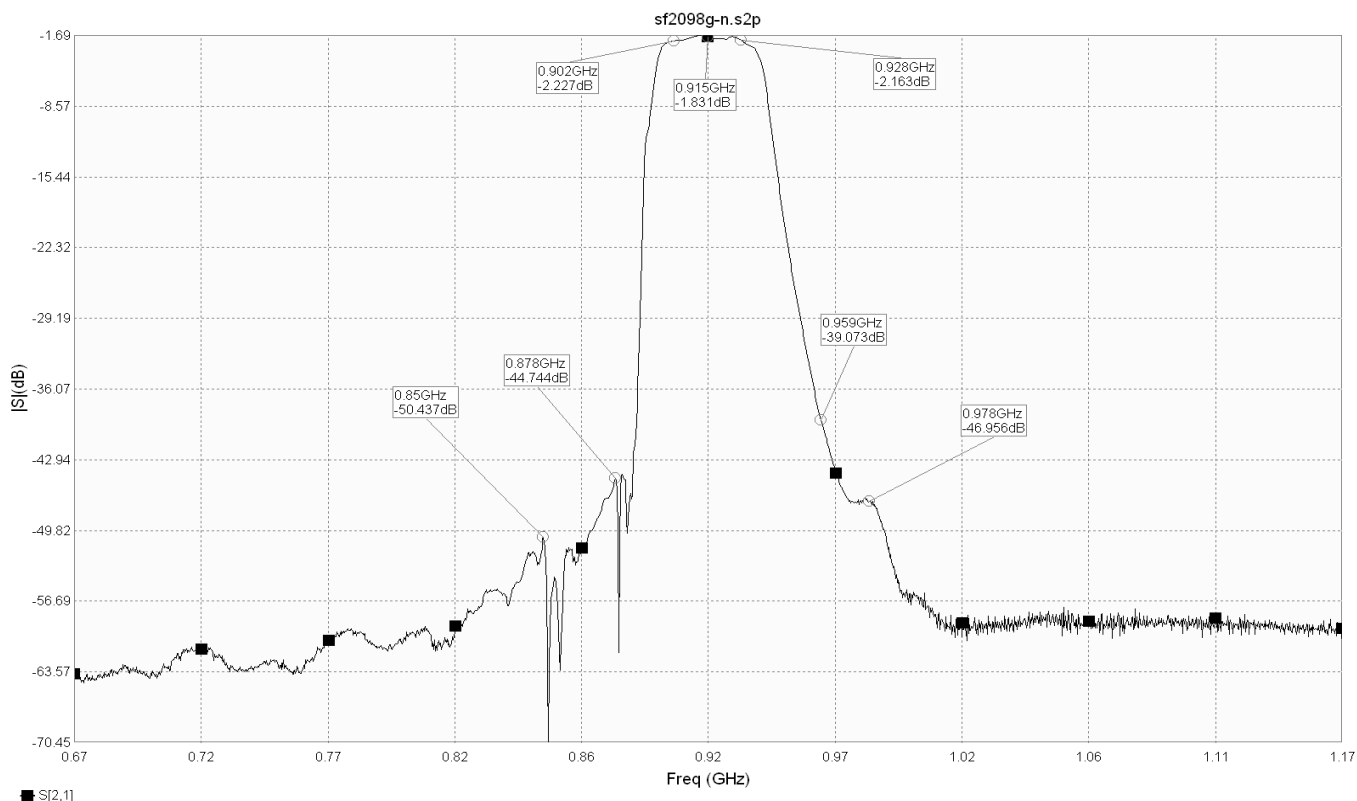

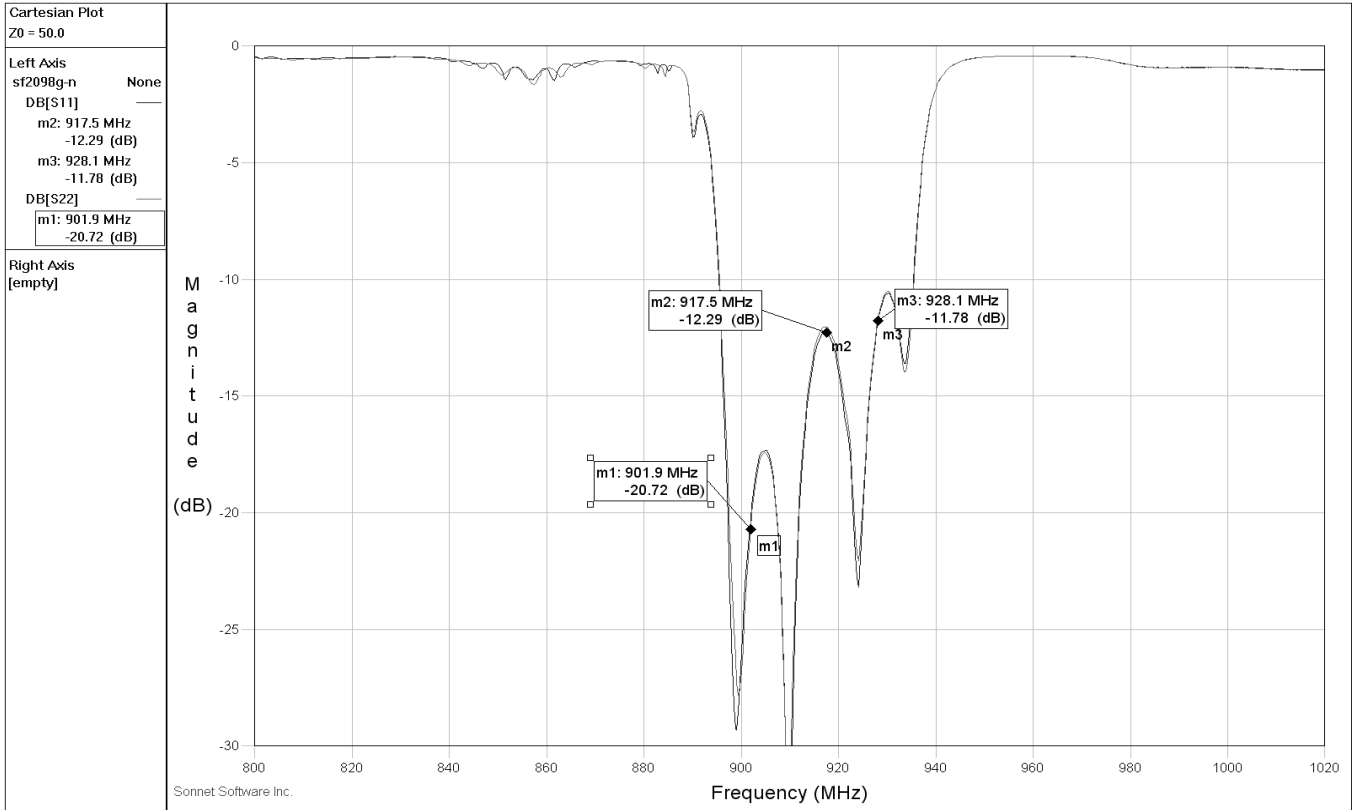

SM2520-4 Case

4-Terminal Ceramic Surface-Mount Case 2.5 X 2.0 mm Nominal Footprint

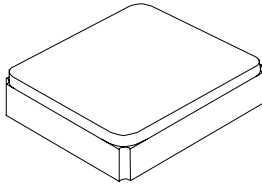

PCB Foot Print

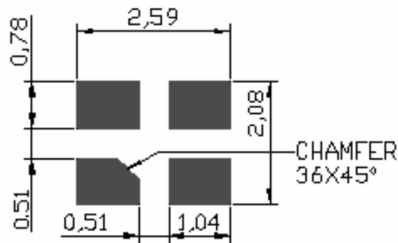

TOP VIEW

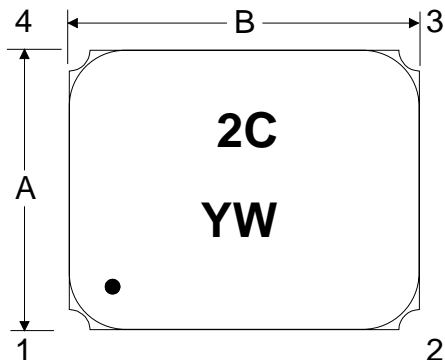

BOTTOM VIEW

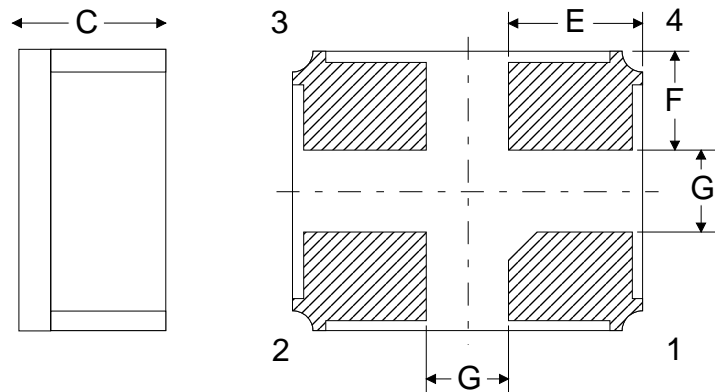

Case Dimensions

| Dimension | mm | | |
|-----------|-----|------|--|
| | Nom | | |
| A | | 2.0 | |
| B | | 2.5 | |
| C | | 1.0 | |
| E | | 0.95 | |
| F | | 0.70 | |
| G | | 0.60 | |

Electrical Connections

| Connection | | Terminals |
|-----------------------------|---------------------|------------|
| Port 1 | Single-ended Input | 1 |
| Port 2 | Single-ended Output | 3 |
| | Ground | All others |
| Single Ended Operation Only | | |

Materials

| | |
|--------------------|--|
| Solder Pad Plating | 0.3 to 1.0 μm Gold over 1.27 to 8.89 μm Nickel |
| Lid Plating | 2.0 to 3.0 μm Nickel |
| Body | Al_2O_3 Ceramic |
| Pb Free | |

