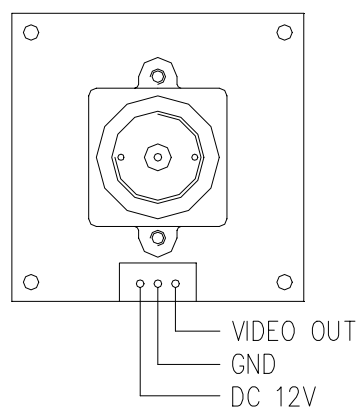

B/W CCD CAMERA MODULE**SK-1003PH5****INTERFACE SPECIFICATION**

When the connector is located as shown in the above picture, monitor gives upright picture.

I/O Connector Function

Usage : Composite video signal out for power input

Pin Array :

DC 12V (RED)	DC Power input (Regulated DC 12.0V)
GND (BLACK)	Power and Video signal in common
Video Out (YELLOW)	Video signal output

I/O CABLE

I/O Harness is necessary for the product.

B/W CCD CAMERA MODULE

SK-1003PH5

DIMENSION

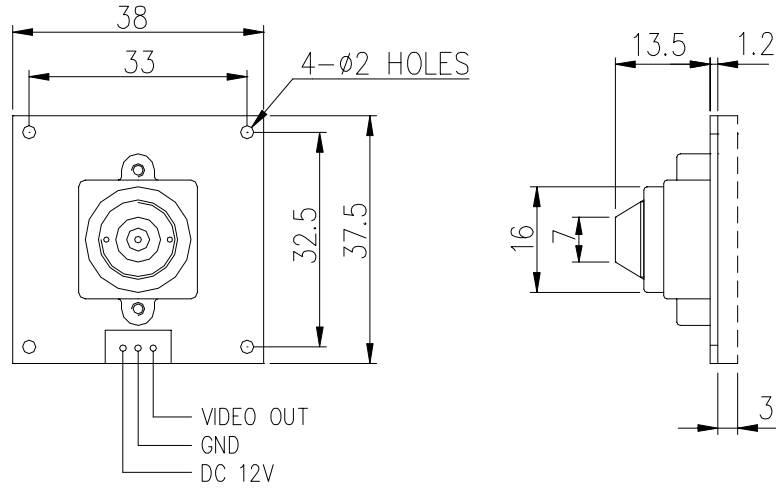

BIG SIZE IMAGE

