

# 产品规格书

## Specification of Products

产品名称：三相桥式整流器

产品型号：SKBPC3510 3512 3516

浙江赛菱电子有限公司

ZHEJIANG SAILING ELECTRON CO.,LTD.

厂址：浙江省 缙云县 五东工业区

电话：（0578）3277780 3278788

传真：（0578）3611180

邮编：321400

E-mail:zjlf123@alibaba.com

Http://www.slscr.com.cn

拟制	审核	核准
项海阳	程一凡	洪月飞

版本号：02 更新日期：2010.2.6

Silicon-Bridge Rectifiers

SKBPC 3510 SKBPC 3512 SKBPC 3516

Product Picture:



TYPE: SKBPC3516 W

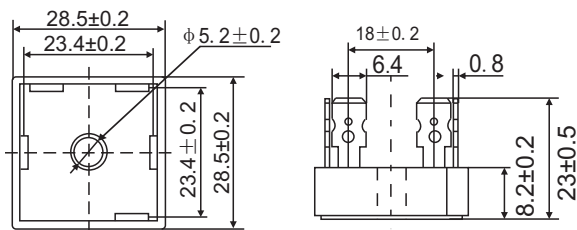

Dimensions / Ma in mm

Nominal current 35 A

Alternating input voltage 1000-1600 V

Dimensions 28 x 28 x 8.2 [mm]

Weight approx. 18 g

Standard packaging bulk

Maximum ratings

Grenzwerte

Type	Alternating input volt. $V_{VRMS}$ [V]	Rep. peak reverse voltage $V_{RRM}$ [V]	Surge peak reverse voltage $V_{RSM}$ [V]
SKBPC3510	600	1000	1200
SKBPC3512	800	1200	1400
SKBPC3516	1000	1600	1800
Repetitive peak forward current		$f > 15 \text{ Hz}$	$I_{FRM}$ 84 A
Peak forward surge current, 50Hz half sine-wave		$T_A = 25 \text{ }^\circ\text{C}$	$I_{FSM}$ 233 A
Rating for fusing, $t < 10 \text{ ms}$		$T_A = 25 \text{ }^\circ\text{C}$	$i^2 t$ 272 A <sup>2</sup> s
Operating junction temperature			$T_j$ -40...+150°C
Storage temperature			$T_s$ -40...+150°C

Silicon-Bridge Rectifiers

SKBPC 3510 SKBPC 3512 SKBPC 3516

Characteristics

Kennwerte

Max. current with cooling fin 300 cm <sup>2</sup>	T <sub>A</sub> =50°C	R-load	I <sub>FAV</sub>	35.0 A
Forward voltage	T <sub>j</sub> =25°C	I <sub>F</sub> =11.5A	V <sub>F</sub>	< 1.2 V
Leakage current	T <sub>j</sub> =25°C	V <sub>R</sub> =V <sub>RRM</sub>	I <sub>R</sub>	< 10 μ A
Isolation voltage terminals to case			V <sub>ISO</sub>	>2500 V
Thermal resistance junction to case			R <sub>thC</sub>	< 2.0 K/W
Admissible torque for mounting		M 5		2 ± 10 % Nm

