

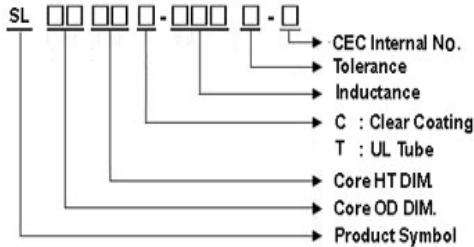

## Features

- Low cost
- Wide range of inductance
- High reliability

## Product Identification



## Shapes and Dimensions

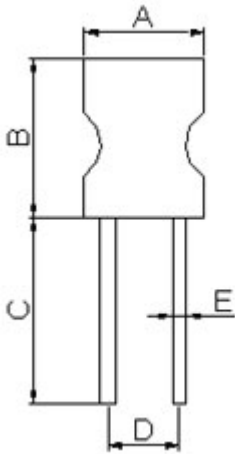

Dimension in mm

A	13 <sup>+0</sup>
B	19 <sup>+0</sup>
C	20 <sup>0</sup>
D	6.5±1.5
E	0.8 $\phi$

### Note:

- lead-free
- CHILISIN has UL tube on SL Series to avoid damage when wave soldering.
- Customized specifications are also welcome.

## Electrical Parameters

Part Number	Inductance (mH)	Test Frequency (KHz), 1V	D.C Resistance (W) Max	IDC (A)
SL1016□-4R7K-N	4.7	1	0.018	10
SL1016□-6R8K-N	6.8	1	0.020	10
SL1016□-8R2K-N	8.2	1	0.022	10
SL1016□-100K-N	10	1	0.027	7.6
SL1016□-120K-N	12	1	0.024	7.5
SL1016□-150K-N	15	1	0.031	6.5
SL1016□-180K-N	18	1	0.039	6.0
SL1016□-220K-N	22	1	0.039	5.4
SL1016□-330K-N	33	1	0.047	4.4
SL1016□-470K-N	47	1	0.053	3.8
SL1016□-560K-N	56	1	0.068	3.4
SL1016□-680K-N	68	1	0.078	3.0
SL1016□-101K-N	100	1	0.099	2.5
SL1016□-121K-N	120	1	0.128	2.0
SL1016□-151K-N	150	1	0.182	1.8
SL1016□-181K-N	180	1	0.195	1.6
SL1016□-221K-N	220	1	0.312	1.4
SL1016□-271K-N	270	1	0.32	1.3
SL1016□-331K-N	330	1	0.39	1.2
SL1016□-391K-N	390	1	0.40	1.1
SL1016□-471K-N	470	1	0.49	1.0
SL1016□-561K-N	560	1	0.52	0.95
SL1016□-681K-N	680	1	0.88	0.80
SL1016□-821K-N	820	1	0.89	0.75
SL1016□-102K-N	1000	1	1.50	0.65
SL1016□-122K-N	1200	1	1.15	0.60
SL1016□-152K-N	1500	1	1.3	0.52
SL1016□-182K-N	1800	1	1.9	0.50
SL1016□-222K-N	2200	1	2.0	0.45
SL1016□-332K-N	3300	1	4.6	0.35
SL1016□-472K-N	4700	1	5.6	0.30
SL1016□-682K-N	6800	1	7.0	0.25
SL1016□-752K-N	7500	1	7.7	0.24
SL1016□-822K-N	8200	1	10.4	0.23
SL1016□-103K-N	10000	1	11.7	0.18
SL1016□-123K-N	12000	1	13.8	0.16
SL1016□-153K-N	15000	1	15.6	0.15
SL1016□-223K-N	22000	1	23.4	0.10

- L: HP4263B
- RDC: CHEN HWA502BC
- IDC: CHEN HWA CH1061+301A