



MOS Controlled Diode

PRODUCT SUMMARY

V _{RRM}	I _O	V _{F(MAX)} @ 25°C	I _{R(MAX)} @ 25°C
50V	8A	0.58V	0.5mA

FEATURES

- Low Profile Design for Smart Phone Charger
- Ideal for SMT Mounting
- Low forward voltage drop
- High forward surge capability
- Excellent High Temperature Stability

TO-277



Top View



Bottom View

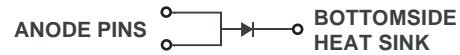

ABSOLUTE MAXIMUM RATINGS (T_A=25°C unless otherwise noted)

Symbol	Parameter	Value	Unit
V _{RRM}	Peak Repetitive Reverse Voltage	50	V
V _{RWM}	Working Peak Reverse Voltage	50	V
V _{RM}	DC Blocking Voltage	50	V
V _{R(RMS)}	RMS Reverse Voltage	35	V
I _O	Average Rectified Output Current	8	A
I _{FSM}	Non-Repetitive Peak Forward Surge Current 8.3ms Single Half Sine-Wave Superimposed on Rated Load	120	A
E _{AS}	Non-Repetitive Avalanche Energy (T _J = 25°C, I _{AS} = 10, L = 5mH)	170	mJ
P _{ARM}	Repetitive Peak Avalanche Energy	24000	W

THERMAL CHARACTERISTICS

Symbol	Parameter	Value	Unit
R _{θ JA}	Thermal Resistance, Junction-to-Ambient	70	°C/W
T _J	Operating Temperature Range	-55 to 150	°C
T _{STG}	Storage Temperature Range	-55 to 175	°C

ELECTRICAL CHARACTERISTICS (T_A=25°C unless otherwise specified)

Symbol	Parameter	Conditions	Min	Typ	Max	Unit
V _F	Forward Voltage Drop	I _F = 5A, T _J = 25°C		0.45	0.50	V
		I _F = 8A, T _J = 25°C		0.53	0.58	V
		I _F = 8A, T _J = 125°C		0.52	0.57	V
I _R	Leakage Current	V _R = 50V, T _J = 25°C		90	500	uA
		V _R = 50V, T _J = 125°C			100	mA
C _T	Total Capacitance	V _R = 50V, f = 1MHz		75		pF

SMD8V50SP

Ver 1.0

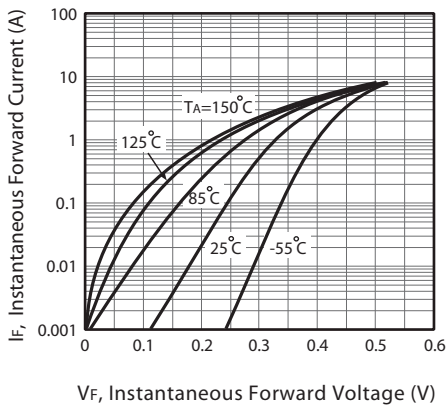

Figure 1. Typical Forward Characteristics

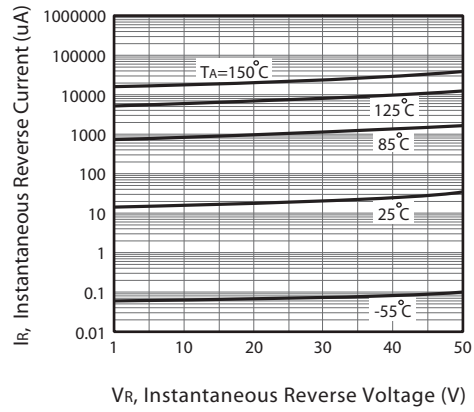

Figure 2. Typical Reverse Characteristics

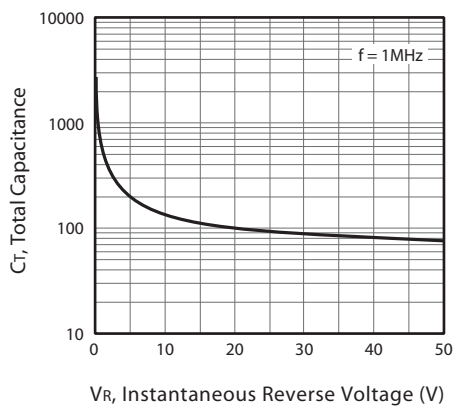

Figure 3. Total Capacitance vs. Reverse Voltage

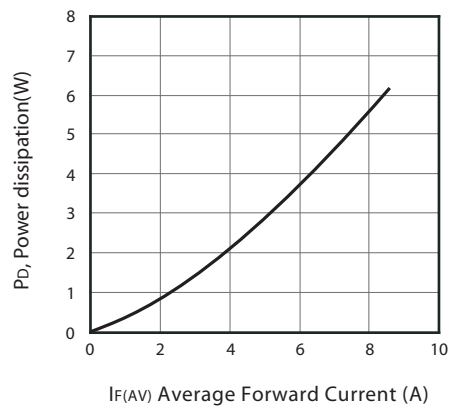

Figure 4. Forward Power Dissipation

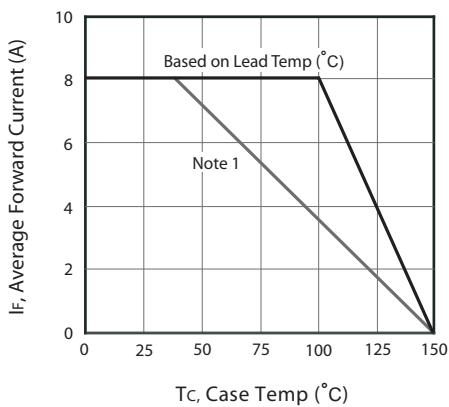

Figure 4. Forward Power Dissipation

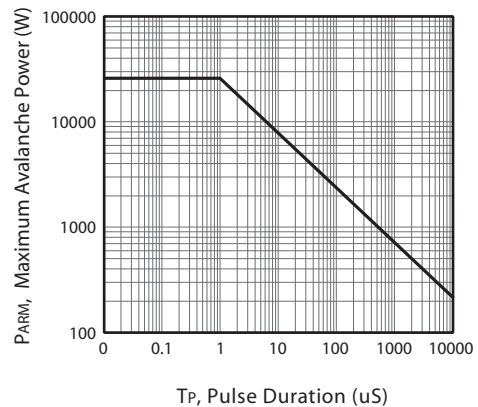

Figure 6. Maximum Avalanche Power Curve

Note : 1.Device mounted on FR-4 substrate, 2oz copper.

Nov,14,2014

SMD8V50SP

Ver 1.0

PACKAGE OUTLINE DIMENSIONS

TO-277

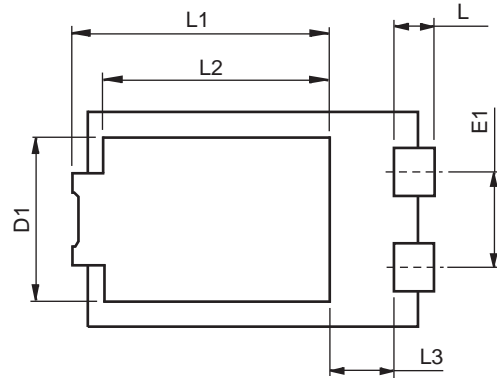
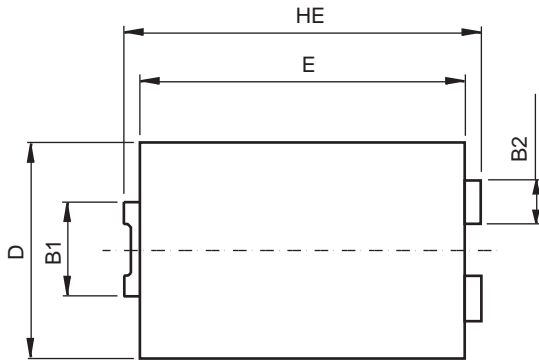

SYMBOLS	MILLIMETERS	
	MIN.	MAX.
HE	6.40	6.60
E	5.60	5.80
D	4.10	4.30
B1	1.70	1.90
B2	0.80	1.00
A	1.05	1.20
C	0.30	0.40
L	0.85	1.10
L1	4.20	4.40
L2	3.52 Typ.	
L3	1.10	1.40
D1	3.00	3.30
E1	1.86 Typ.	

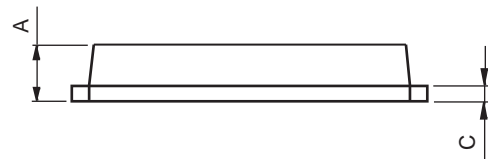

Mounting Pad Layout (unit:mm)

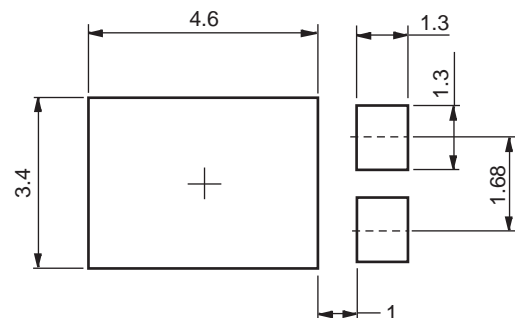

Nov,14,2014

SMD8V50SP

TOP MARKING DEFINITION

