

Solid State Devices, Inc.

14701 Firestone Blvd * La Mirada, Ca 90638
 Phone: (562) 404-4474 * Fax: (562) 404-1773
 ssdi@ssdi-power.com * www.ssdi-power.com

**SUM60UF thru SUM90UF
 and
 SUM60UFSMS thru SUM90UFSMS**

Designer's Data Sheet
Part Number/Ordering Information ^{1/}

SUM _ _ _

Screening ^{2/}

_ = Not Screened

TX = TX Level

TXV = TXV

S = S Level

Package Type

_ = Axial Leaded

SMS = Surface Mount Square Tab

Voltage/Family
60UF = 6,000V
70UF = 7,000V
80UF = 8,000V
90UF = 9,000V
400 mA
6,000 thru 9,000 VOLTS
**60 ns ULTRA FAST RECOVERY
 RECTIFIER**
FEATURES:

- PIV to 9,000 Volts
- Hermetically Sealed Axial and Square Tab Surface Mount Package
- Ultra Fast Recovery 60 nsec Maximum ^{4/}
- Void Free Construction
- Metallurgically Bonded
- 175°C Maximum Operating Temperature
- TX, TXV, and S-Level Screening Available ^{2/}
- Also Available in Fast Versions, Consult Factory

MAXIMUM RATINGS ^{3/ 6/}

RATING		SYMBOL	VALUE	UNIT
Peak Inverse Voltage	SUM60UF and SUM60UFSMS SUM70UF and SUM70UFSMS SUM80UF and SUM80UFSMS SUM90UF and SUM90UFSMS	PIV	6000 7000 8000 9000	Volts
Average Rectified Current	$T_A = 25^\circ\text{C}$ $T_A = 100^\circ\text{C}$	I_{O1} I_{O2}	400 250	mA
Surge Current (1 Cycle)		I_{FSM}	25	Amps
Operating & Storage Temperature ^{5/}		T_J and T_{STG}	-65 to +175	°C

NOTES:

^{1/} For Ordering Information, Price, Operating Curves, and Availability- Contact Factory.

^{2/} Screened to MIL-PRF-19500.

^{3/} Unless Otherwise Specified, All Electrical Characteristics @25°C.

^{4/} I_F = 500mA, I_R = 1A, I_{RR} = 250mA, T_A = 25°C

^{5/} Maximum lead/end temperature for soldering is 250°C, 3/8" from case for 5 sec. maximum.

^{6/} Operating and testing over 10,000 V/inch may require encapsulation or immersion in suitable dielectric material.

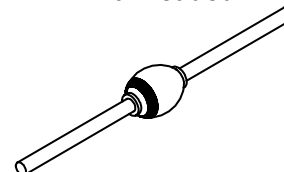
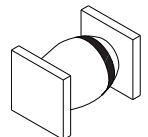
Axial Leaded

SMS

NOTE: All specifications are subject to change without notification. SCD's for these devices should be reviewed by SSDI prior to release.

DATA SHEET #: RC0039C
DOC



Solid State Devices, Inc.

14701 Firestone Blvd * La Mirada, Ca 90638
 Phone: (562) 404-4474 * Fax: (562) 404-1773
 ssdi@ssdi-power.com * www.ssdi-power.com

**SUM60UF thru SUM90UF
 and
 SUM60UFSMS thru SUM90UFSMS**

ELECTRICAL CHARACTERISTICS ^{3/ 6/}				
CHARACTERISTICS		SYMBOL	VALUE	UNIT
Maximum Forward Voltage (300µs pulse minimum)	$I_F = 400 \text{ mA}$	V_F	15	Vdc
Maximum Reverse Leakage Current ($V_R = \text{Rated}$)	$(T_A = +25^\circ\text{C})$ $(T_A = +100^\circ\text{C})$	I_{R1} I_{R2}	1.0 15	µA µA
Maximum Junction Capacitance $V_R = 100 \text{ Vdc}$, $f = 1\text{MHz}$, $T_A = 25^\circ\text{C}$		C_J	8	pF
Maximum Reverse Recovery Time $I_F = 500\text{mA}$, $I_R = 1\text{A}$, $I_{RR} = 250\text{mA}$, $T_A = 25^\circ\text{C}$		t_{rr}	60	ns
Typical Thermal Impedance	Junction to Lead for Axial, $L = .375''$ Junction to End Tab for Surface Mount	$R_{\theta JL}$ $R_{\theta JE}$	18 18	°C/W

NOTES:

- 1/ For Ordering Information, Price, Operating Curves, and Availability- Contact Factory.
- 2/ Screened to MIL-PRF-19500.
- 3/ Unless Otherwise Specified, All Electrical Characteristics @25°C.
- 4/ $I_F = 500\text{mA}$, $I_R = 1\text{A}$, $I_{RR} = 250\text{mA}$, $T_A = 25^\circ\text{C}$
- 5/ Maximum lead/end temperature for soldering is 250°C, 3/8" from case for 5 sec. maximum.
- 6/ Operating and testing over 10,000 V/inch may require encapsulation or immersion in suitable dielectric material.

Package Outlines:

DIMENSIONS (inches)			DIMENSIONS (inches)		
DIM.	Minimum	Maximum	DIM	Minimum	Maximum
A	.065	.165	A	.170	.180
B	---	.350	B	.330	.380
C	.047	.053	C	.020	.030
D	1.00	---	D	.002	---

<p>AXIAL</p>	<p>SMS</p>
---------------------	-------------------

NOTE: All specifications are subject to change without notification. SCD's for these devices should be reviewed by SSDI prior to release.

DATA SHEET #: RC0039C

DOC