



CRYSTAL UNIT SX-1612

Applications

- Bluetooth / Wireless LAN

Features

- Ultra thin / Dimensions (1.6 X 1.2 X 0.35)
- Ceramic Package
- High Reliability and High Stability

Specifications



Model	SX-1612	
Nominal frequency range	24.000~54.000 MHz	
Crystal cut	Fundamental [AT-cut]	
Storage temperature range	-40°C~+90°C	
Operating temperature range	-20°C~+70°C	-30°C~+85°C
Frequency temperature characteristics (Ref. to +25°C)	±15 X 10 ⁻⁶	±20 X 10 ⁻⁶
Frequency tolerance (at +25°C)	±15 X 10 ⁻⁶	
Equivalent series resistance	100Ω : 24.000~29.999 MHz 80Ω : 30.000~54.000 MHz	
Load capacitance	8 pF	
Shunt capacitance	3 pF max.	
Level of drive	10 μW (100 μW max.)	

Package quantity: 3000pcs max./Reel.

Outline and Dimensions[unit:mm]

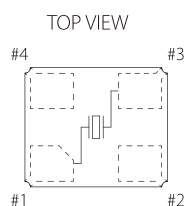
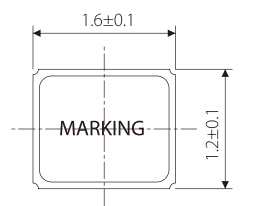

- #1,#3 : Crystal terminal
- #2 : GND(Connected to cover) #4 : NC (Please connect it with GND.)

Example of a Terminal Land Pattern

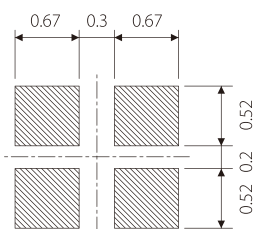
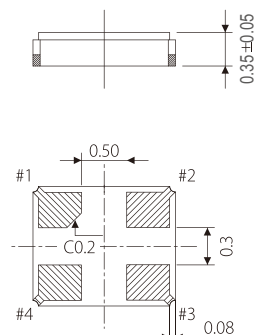

Maximum marking length		Marking
line1	line2	
4	4	Laser
ex.)		40 . 0 S G A