



# TAI-SAW TECHNOLOGY CO., LTD.

No. 3, Industrial 2nd Rd., Ping-Chen Industrial District,  
Taoyuan, 324, Taiwan, R.O.C.

TEL: 886-3-4690038 FAX: 886-3-4697532

E-mail: [tstsales@mail.taisaw.com](mailto:tstsales@mail.taisaw.com) Web: [www.taisaw.com](http://www.taisaw.com)

## Approval Sheet For Product Specification

Issued Date: March, 7, 2005

Product Name: SAW Filter 930.5 MHz for Pager

TST Parts No.:TA930GC

Customer Parts No.: \_\_\_\_\_

Company: _____
Division: _____
Approved by : _____
Date: _____

Checked by: \_\_\_\_\_ Bob Chau

Approval by: \_\_\_\_\_ Francis Chen

Date: \_\_\_\_\_ 3, 7, 2005



# TAI-SAW TECHNOLOGY CO., LTD.

No. 3, Industrial 2nd Rd., Ping-Chen Industrial District,  
Taoyuan, 324, Taiwan, R.O.C.

TEL: 886-3-4690038 FAX: 886-3-4697532

E-mail: [tstsales@mail.taisaw.com](mailto:tstsales@mail.taisaw.com) Web: [www.taisaw.com](http://www.taisaw.com)

## SAW Filter 930.5 MHz For Pager

MODEL NO.: TA930GC

REV. NO.:4

### A. MAXIMUM RATING:

1. Input Power Level: 0 dB<sub>m</sub>
2. DC voltage: 10 V
3. Operating Temperature: -30°C to +70°C
4. Storage Temperature: -40°C to +85°C

RoHS Compliant  
Lead free  
Lead-free soldering

### B. ELECTRICAL CHARACTERISTICS:

Characteristics	Specification	Note
Center frequency $F_c$ (MHz)	930.5	1
I.L. (928.5~ 932.5 MHz) (dB)	4.5 max.	
Ripple(928.5 ~ 932.5 MHz) (dB)	2.0 max.	1
Attenuation:( Reference level from 0 dB)		
1) 400 ~ 880 MHz (dB)	35 min.	1
2) 884.8 ~ 890.2 MHz (dB)	40 min.	1
3) 906.8 ~ 911.2 MHz (dB)	30 min.	1
4) 980 ~ 1300 MHz (dB)	35 min.	1
Impedance at $F_c$ : Input Impedance	50-j57ohm	2
Output Impedance	50-j57ohm	2

Note1. The standard definitions is in JIS C 6703

Note2.

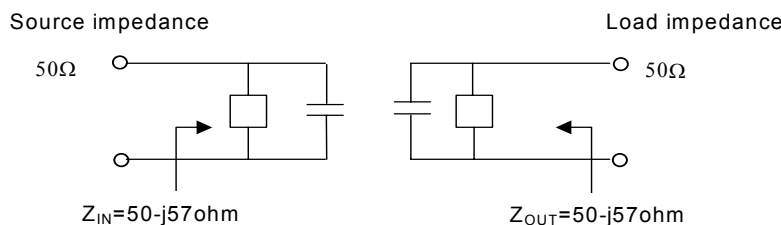

### C. FREQUENCY CHARACTERISTICS:

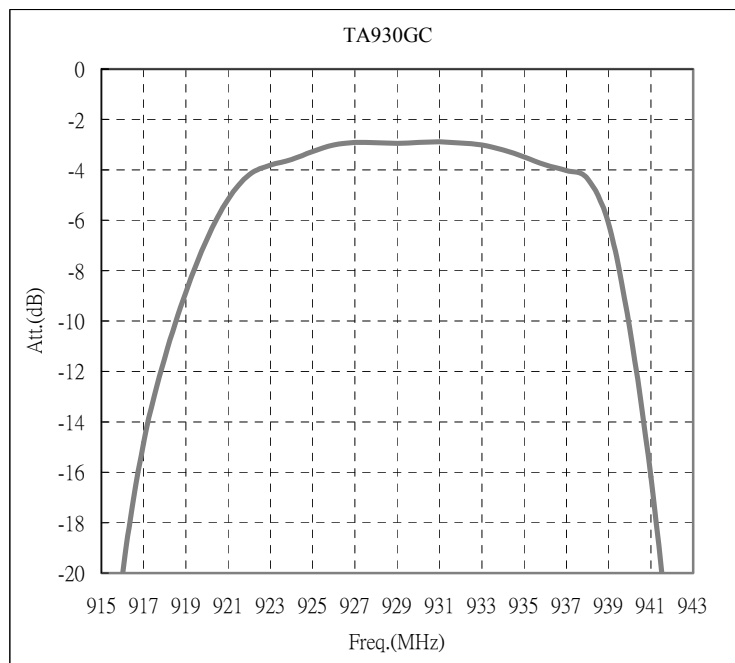
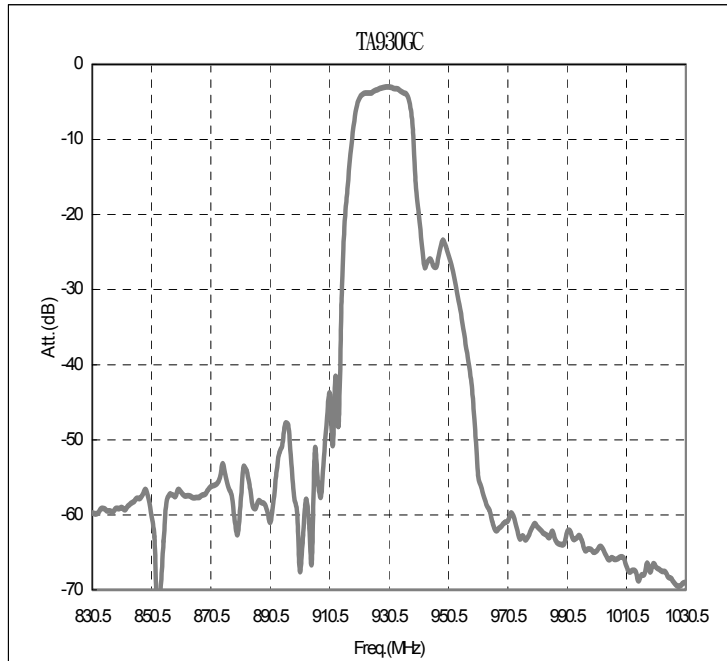

**D. MEASUREMENT CIRCUIT:**

HP Network analyzer

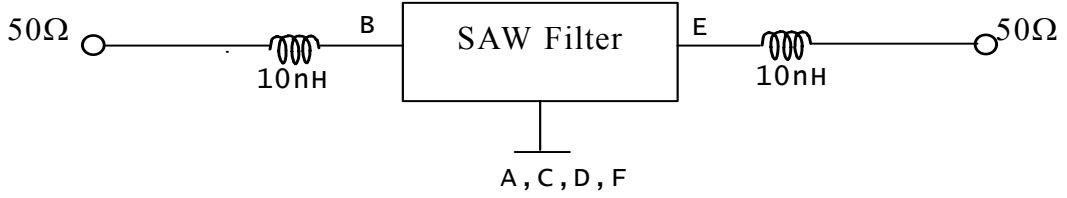

**E. OUTLINE DRAWING:**

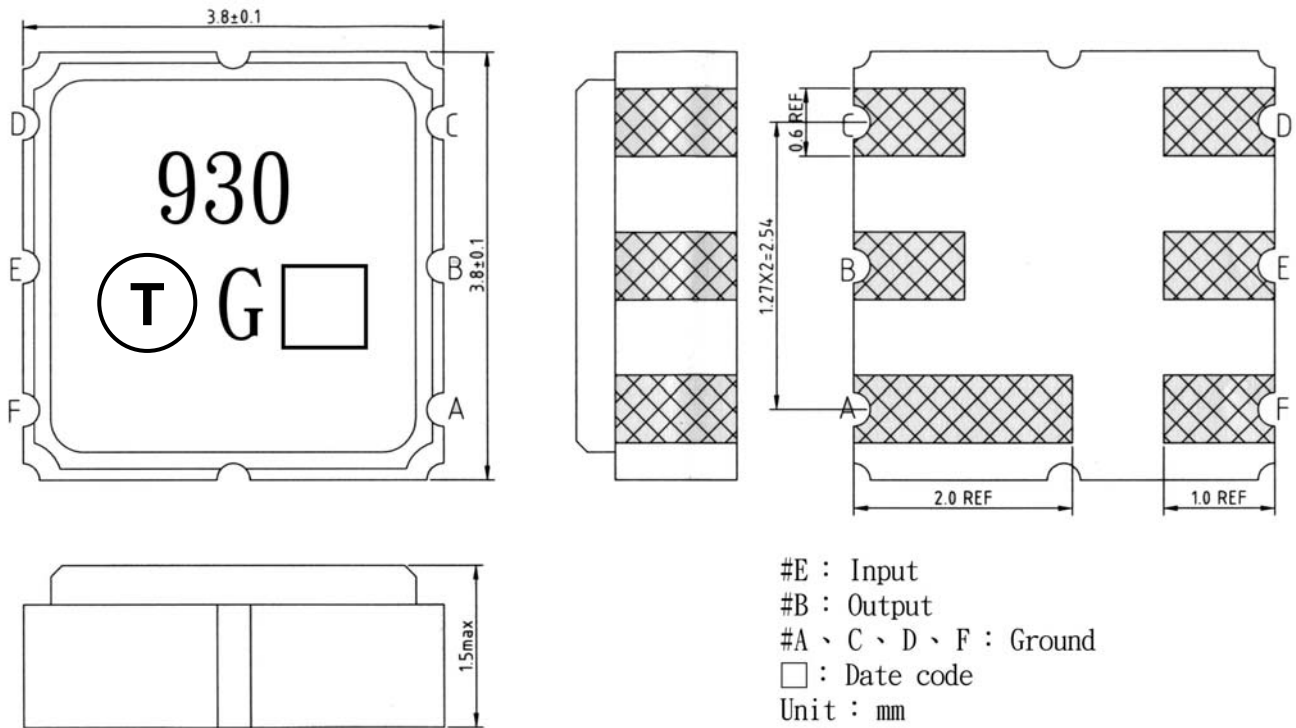

**F. PCB Footprint:**

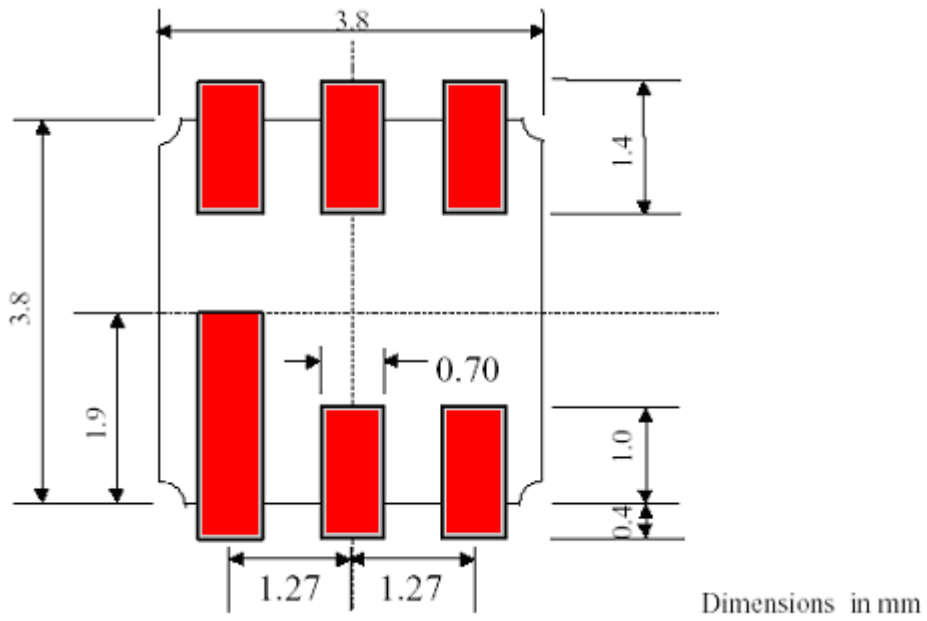

**G. PACKING:**

**1. REEL DIMENSION**

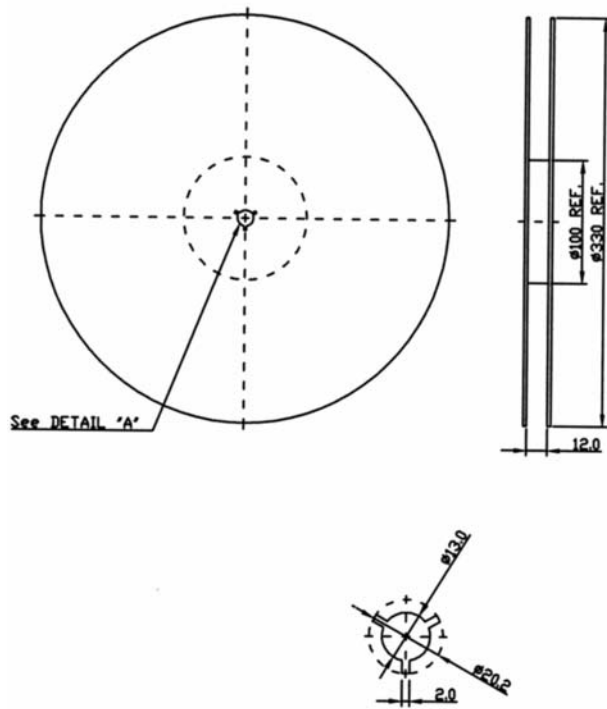

**2. TAPE DIMENSION**

