



TAI-SAW TECHNOLOGY CO., LTD.

No. 3, Industrial 2nd Rd., Ping-Chen Industrial District,
Taoyuan, 324, Taiwan, R.O.C.

TEL: 886-3-4690038 FAX: 886-3-4697532

E-mail: tstsales@mail.taisaw.com Web: www.taisaw.com

Approval Sheet For Product Specification

Issued Date: Jun. 14, 2002

Product Name: SAW Filter 935 MHz SMD 3.8 mm SQ for Pager

TST Parts No.:TA935EC

Customer Parts No.:_____

| |
|---------------------|
| Company: _____ |
| Division: _____ |
| Approved by : _____ |
| Date: _____ |

Checked by: _____ Bob Chau

Approval by: _____ Vincent Lee

Date: _____ Jun.14'2002



TAI-SAW TECHNOLOGY CO., LTD.

No. 3, Industrial 2nd Rd., Ping-Chen Industrial District,
Taoyuan, 324, Taiwan, R.O.C.

TEL: 886-3-4690038 FAX: 886-3-4697532

E-mail: tstsales@mail.taisaw.com Web: www.taisaw.com

SAW Filter 935 MHz For Pager

MODEL NO.: TA935EC

REV. NO.:2

A. MAXIMUM RATING:

1. Input Power Level: 0 dB_m
2. DC voltage: 10 V
3. Operating Temperature: -20°C to +70°C
4. Storage Temperature: -40°C to +85°C

RoHS Compliant
Lead free
Lead-free soldering

B. ELECTRICAL CHARACTERISTICS:

| Characteristics | Specification | Note |
|--|---------------|------|
| Center frequency F_c (MHz) | 935 | 1 |
| I.L. (929~ 941 MHz) (dB) | 4.0 max. | |
| Return Loss within 929 ~ 941 MHz (dB) | 8.0 min. | 1 |
| Ripple(929 ~ 941 MHz) (dB) | 2.0 max. | 1 |
| Attenuation:(Reference level from 0 dB) (dB) | | |
| 1) 835 ~ 860 MHz (dB) | 45 min. | 1 |
| 2) 1019 ~ 1035 MHz (dB) | 40 min. | 1 |
| Impedance at F_c ; Input $Z_{IN}=R_{IN} // C_{IN}$ | 50Ω // 0 Pf | 2 |
| Output $Z_{OUT}=R_{OUT} // C_{OUT}$ | 50Ω // 0 Pf | 2 |

Note1. The standard definitions is in JIS C 6703

Note2.

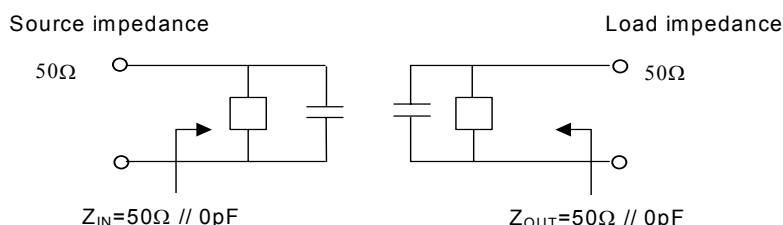

C.FREQUENCY CHARACTERISTICS:

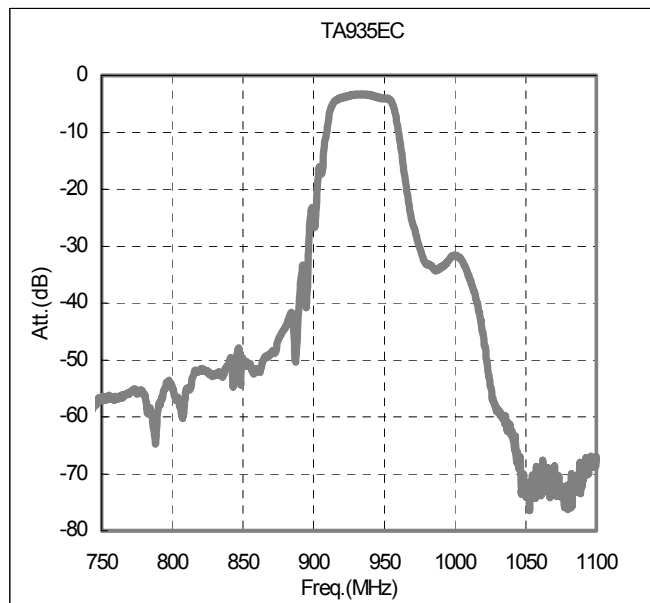
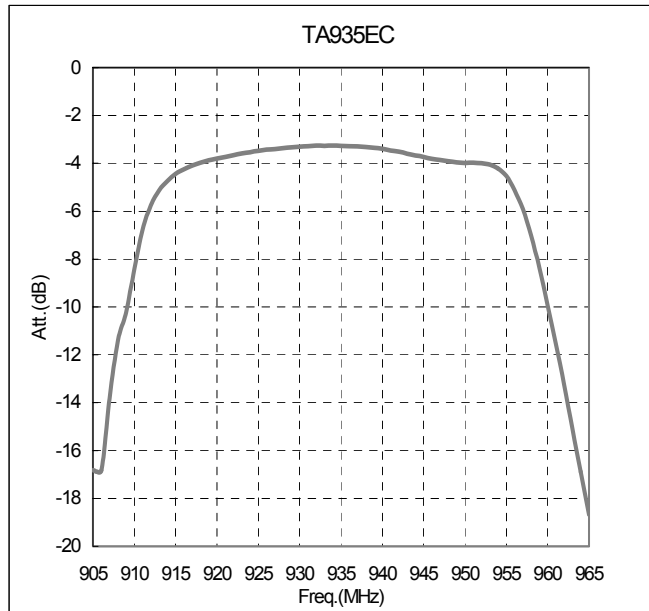

D. MEASUREMENT CIRCUIT:

Network analyzer

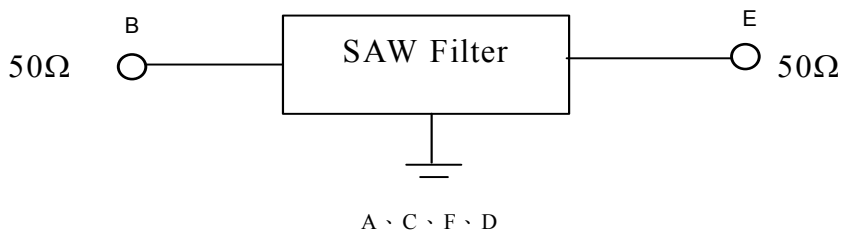

E. OUTLINE DRAWING:

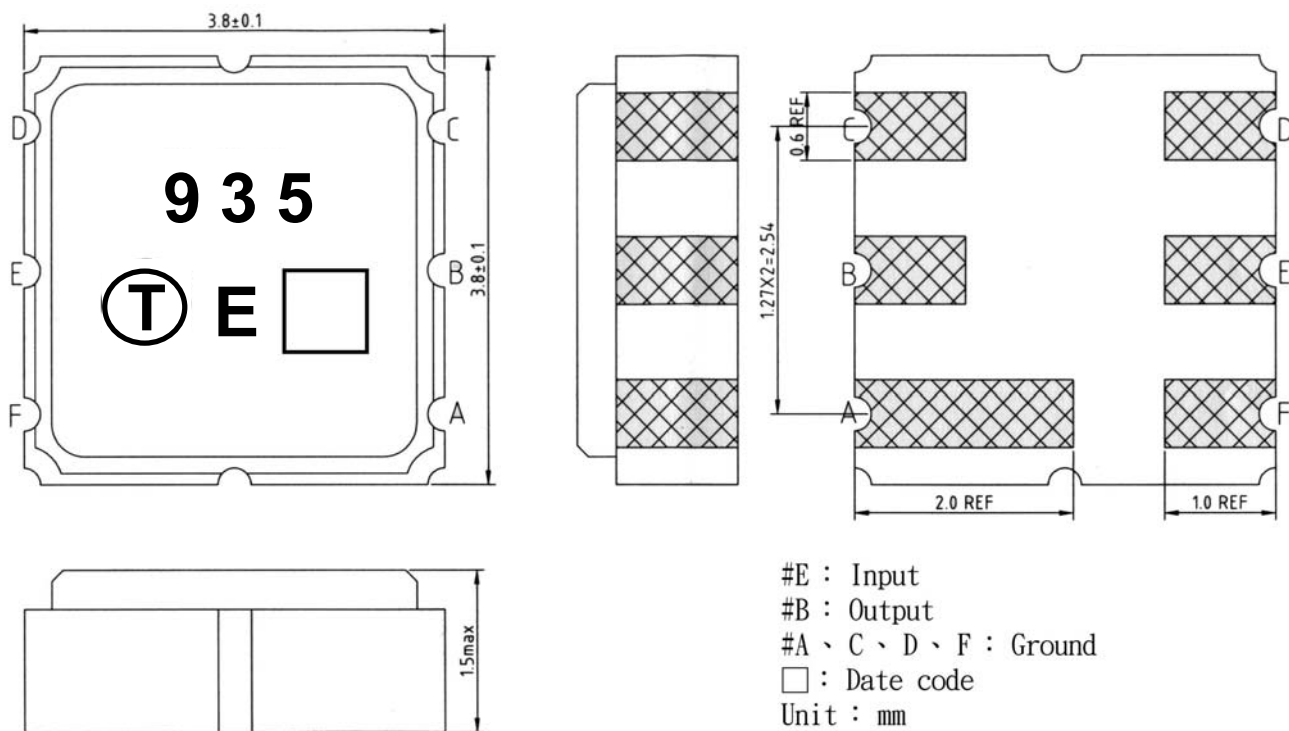

F. PACKING:

1. REEL DIMENSION

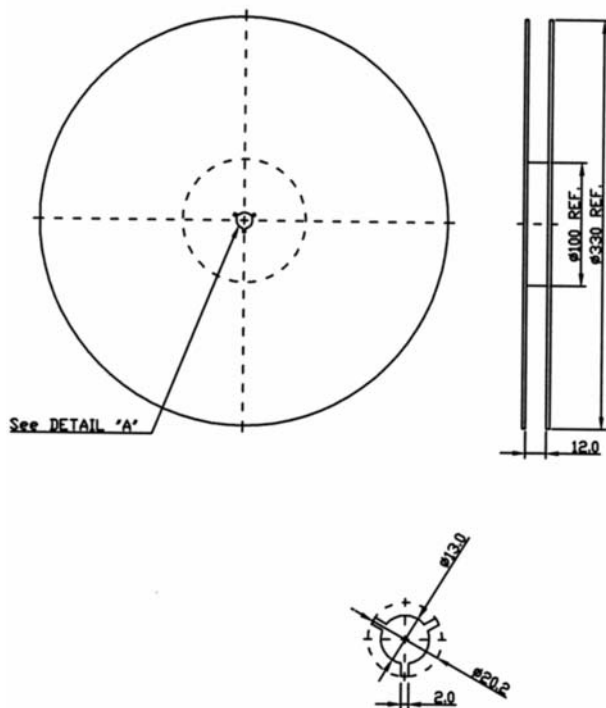

2. TAPE DIMENSION

