

VERSION	CHANGE CONTENT	DATE
V00	FIRST ISSUE	2007-07-12
V01	修改背光位置	2007-07-19

TYPE	A	B
LED B/L	12.5	7.9

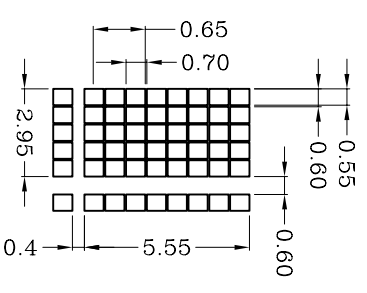
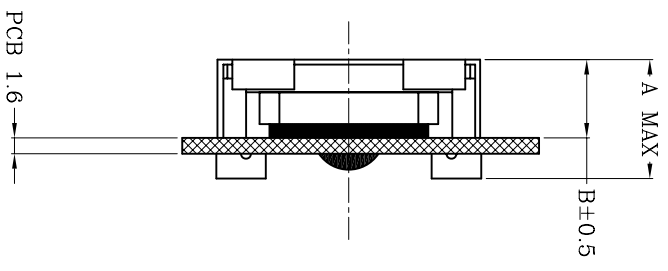
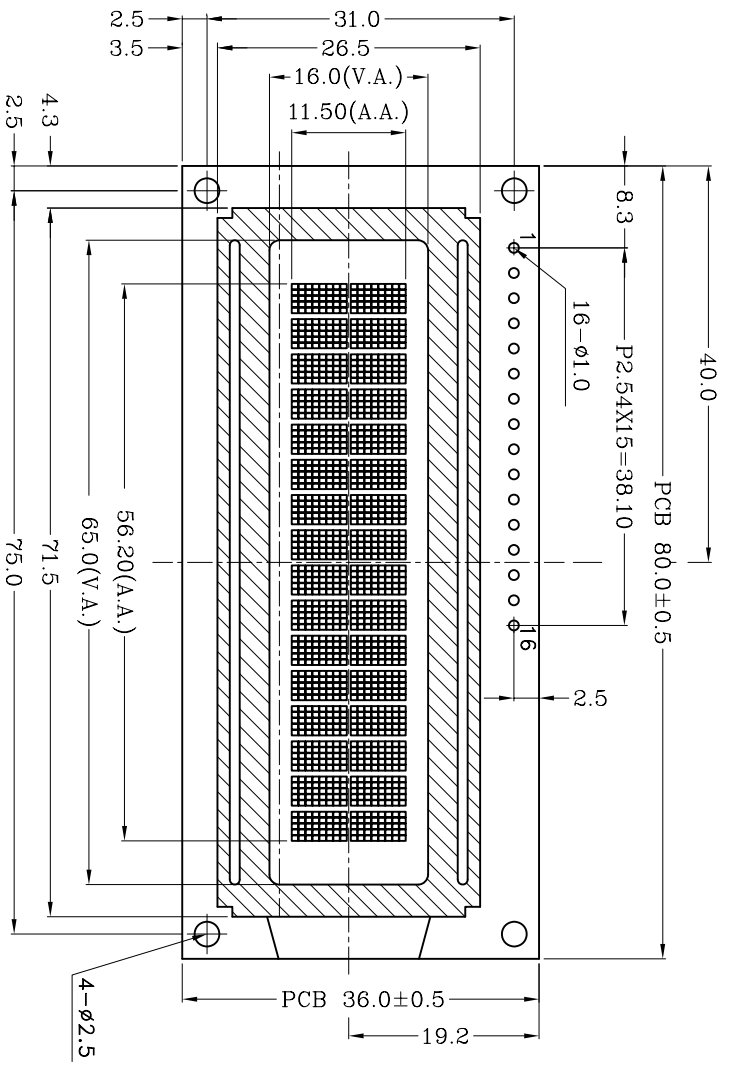

PIN	1	2	3	4	5	6	7	8	9	10	11	12	13	14	15	16
NAME	VSS	VDD	V0	RS	R/W	E	DB0	DB1	DB2	DB3	DB4	DB5	DB6	DB7	LED+	LED-

VIEWING →

SPECIFICATIONS

- DISPLAY TYPE: STN/TRANSMISSIVE/NEGATIVE/BLUE
- LCD DRIVING VOLTAGE: 5.0V
- LOGIC VOLTAGE: 5.0V
- VIEWING DIRECTION: 6.0CLOCK
- OPERATING TEMP: -10° C-60° C
- STORAGE TEMP: -20° C-70° C
- DRIVE MODE: 1/16 DUTY, 1/5 BIAS
- BACKLIGHT: WHITE/SIDE BACKLIGHT/5.0V
- CONTROL/DRIVE IC: SPLC780D-001B-C/SPL100A2-C
- OTHER:
- MECHANICAL TOL.±0.3 UNLESS SPECIFIED

NOTE:

DESCRIPTION:

C/D

SCALE: FIT
SHEET: 1 OF 1
TINSHARP ELECTRONICS CO.,LTD.

PROJECTION
UNIT: mm
MODEL: TC1602A-21T
SERIAL NUMBER: MLX0150

APP: _____ CHK: _____
DATE: _____ DATE: _____