



THEATER 550 PRO
.....
User Manual

746-0000000116

Copyright © 2005, ATI Technologies Inc.. All rights reserved.

ATI and ATI product and product feature names are trademarks and/or registered trademarks of ATI Technologies. All other company and/or product names are trademarks and/or registered trademarks of their respective owners. Features, performance and specifications are subject to change without notice. Product may not be exactly as shown in diagrams.

Reproduction of this manual, or parts thereof, in any form, without the express written permission of ATI Technologies is strictly prohibited.

Disclaimer

While every precaution has been taken in the preparation of this document, ATI Technologies assumes no liability with respect to the operation or use of ATI hardware, software or other products and documentation described herein, for any act or omission of ATI concerning such products or this documentation, for any interruption of service, loss or interruption of business, loss of anticipatory profits, or for punitive, incidental or consequential damages in connection with the furnishing, performance, or use of the ATI hardware, software, or other products and documentation provided herein.

ATI Technologies reserves the right to make changes without further notice to a product or system described herein to improve reliability, function or design. With respect to ATI products which this document relates, ATI disclaims all express or implied warranties regarding such products, including but not limited to, the implied warranties of merchantability, fitness for a particular purpose, and non-infringement.

Macrovision

Apparatus Claims of U.S. Patent Nos. 4,631,603, 4,577,216, 4,819,098, and 4,907,093 licensed for limited viewing uses only.

This product incorporates copyright protection technology that is protected by method claims of certain U.S. patents and other intellectual property rights owned by Macrovision Corporation and other rights owners. Use of this copyright protection technology must be authorized by Macrovision Corporation, and is intended for home and other limited viewing uses only unless otherwise authorized by Macrovision Corporation. Reverse engineering or disassembly is prohibited.

Documentation Updates

ATI is constantly improving its product and associated documentation. To maximize the value of your ATI product, you should ensure that you have the latest documentation. ATI's documentation contains helpful installation/configuration tips and other valuable feature information.



IMPORTANT SAFETY INSTRUCTIONS

- **Read Instructions** - All the safety and operating instructions should be read before the product is operated.
- **Retain Instructions** - The safety and operating instructions should be retained for future reference.
- **Heed Warnings** - All warnings on the product and the operating instructions should be adhered to.
- **Compatibility** - This option card is for use only with IBM AT or compatible UL Listed personal computers that have Installation Instructions detailing user installation of card cage accessories.
- **Grounding** - For continued protection against risk of electric shock and fire, this accessory should be installed only in products equipped with a three-wire grounding plug, a plug having a third (grounding) pin. This plug will only fit into a grounding-type power outlet. This is a safety feature. If you are unable to insert the plug into the outlet, contact your electrician to replace the obsolete outlet. Do not defeat the safety purpose of the grounding-type plug.
- **Secure Attachment** - All card securement pins shall be completely tightened as to provide continuous bonding between the option card and the PC chassis.
- **Outdoor Antenna Grounding** - Since an outdoor antenna or cable system is connected to the product, be sure that the antenna or cable system is grounded so as to provide some protection against voltage surges and built-up static charges. Article 810 of the National Electrical Code, ANSI/NFPA 70, provides information with regard to proper grounding of the mast and supporting structure, grounding of the lead-in wire to the antenna discharge unit, size of grounding conductors, location of antenna-discharge unit, connection of grounding electrodes, and requirements for the grounding electrode.

- **Lightning** - For added protection for this product during a lightning storm, or when it is left unattended and unused for long periods of time, unplug it from the wall outlet, and disconnect the antenna or cable system. This will prevent damage to the product due to lightning and power-line surges.
- **Power Lines** - An outside antenna system should not be located in the vicinity of overhead power lines or other light or power circuits, or where it can fall into such power lines or circuits.
- **Antenna Installation** - When installing an outside antenna system, extreme care should be taken to keep from touching such power lines or circuits, as contact with them may be fatal.
- **Note to CATV System Installer** - This reminder is provided to call the CATV systems installer's attention to Section 820-40 of the NEC, which provides guidelines for proper grounding and, in particular, specifies that the cable ground shall be connected to the grounding system of the building, as close to the point of cable entry as practical.

Table of Contents

Getting Started	1
System Requirements	2
Installing Hardware	3
Quick Installation	3
Detailed Installation	4
<i>Installing your THEATER™ 550 PRO TV tuner card</i>	5
<i>Connecting Display Devices</i>	6
Installing Software	7
Installing Drivers and Software in Windows®	7
<i>Software Installation Prerequisites</i>	7
Using Your THEATER™ 550 PRO TV tuner card	10
Launching your THEATER™ 550 PRO TV tuner card	11
<i>Using Windows® XP Media Center Edition® 2005</i>	11
<i>Using CyberLink PowerCinema</i>	11
<i>Using ATI Multimedia Center™</i>	13
Reference	14
Troubleshooting	14
Warranty Service	16
Compliance Information	16
<i>FCC Compliance Information</i>	16
<i>Industry Canada Compliance Statement</i>	17
<i>CE Compliance Information</i>	17
<i>Informations de conformité de la CE</i>	17
<i>CE-Konformitätserklärung</i>	17

CHAPTER 1:

Getting Started

Your THEATER™ 550 PRO TV tuner card is an advanced, analog TV tuner card that represents a vast improvement in both video and audio quality over previous PC TV tuner products. The THEATER™ 550 PRO TV tuner card uses hardware MPEG encoding and digital audio.

The THEATER™ 550 PRO TV tuner card provides the following features:

- NTSC or PAL analog video decoding with motion-adaptive 3D comb filtering (depending on region).
- Worldwide, analog, stereo audio decoding with digital output to the PC.
- FM radio.
- MPEG-1 Layer II, 2-channel audio encoding.
- High quality MPEG-2 video encoder.
- Hardware noise reduction.

System Requirements

Hardware	<ul style="list-style-type: none">• Intel® Pentium® 4 or Celeron®, AMD Athlon® or Sempron® (or compatible).• Sound card and speakers.• 128 MB of system memory; 256 MB or more is recommended for best performance.• Motherboard with free PCI or PCIe X1slot (as appropriate).• CD-ROM drive (for installation software).• Cable TV signal or amplified antenna.
Operating System	<ul style="list-style-type: none">• Windows® XP Media Center Edition® 2005• Windows® XP (Professional or Home, Service Pack 2)
Decoder	<ul style="list-style-type: none">• You must have an MPEG decoder (DVD or media player) already on your system in order to play back MPEG video captured by the THEATER™ 550 PRO TV tuner card.

CHAPTER 2:

Installing Hardware

This chapter will guide you through the physical installation of your THEATER™ 550 PRO TV tuner card.

Quick Installation

Experienced users and system administrators can follow these brief instructions for installing the THEATER™ 550 PRO TV tuner card in the shortest possible time.

To perform a quick installation

- 1 Uninstall the drivers and software for any previous versions of the product if you have not already done so.
- 2 Shut down and disconnect your computer system.
- 3 Remove any previously installed product.
- 4 Install your new THEATER™ 550 PRO TV tuner card.
- 5 Reassemble and connect your computer system.
- 6 Install the THEATER™ 550 PRO TV tuner card drivers and configuration software from the ATI Installation CD-ROM by doing one of the following:
 - Run through the automatic **SETUP** utility; or
 - **Start > Run > X:\SETUP.EXE** (where **X** is the drive letter of your CD-ROM drive).

Detailed Installation

The following instructions will take you step by step through the installation of your new THEATER™ 550 PRO TV tuner card.

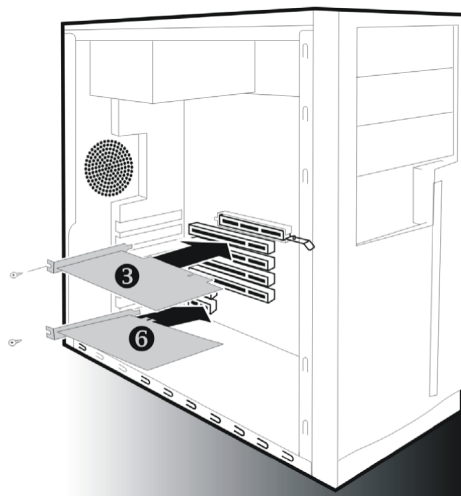
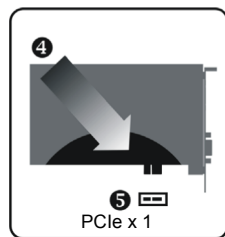
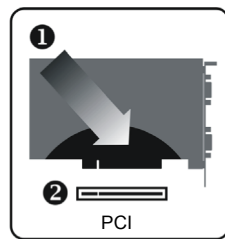

Installation Diagram

- | | |
|---|---|
| 1 | THEATER™ 550 PRO TV tuner card with PCI Connector |
| 2 | PCI Connection on Motherboard |
| 3 | Insertion Point for PCI Card |
| 4 | THEATER™ 550 PRO TV tuner card with PCIe X1 Connector |
| 5 | PCIe X1 Connection on Motherboard |
| 6 | Insertion Point for PCIe X1 Card |

Installing your THEATER™ 550 PRO TV tuner card

- 1 Turn off the computer, monitor, and other peripheral devices.
- 2 Unplug the computer's power cord, and disconnect all cables from the back of your computer.

ⓘ **WARNING** - Wait approximately 20 seconds after unplugging the power cord before disconnecting a peripheral or removing a component from the motherboard to avoid possible damage to the motherboard.

- 3 Remove the computer cover. If necessary, consult your computer's manual for help in removing the cover.

ⓘ **WARNING** - Remember to discharge your body's static electricity by touching the power supply or the metal surface of the computer chassis before touching the motherboard or components.

- 4 Locate an available PCIe X1 or PCI slot (as appropriate) and, if necessary, remove the metal back-plate cover.
- 5 Align your THEATER™ 550 PRO TV tuner card with the appropriate slot, and then press it in firmly until the card is fully seated.
- 6 Screw in or fasten the THEATER™ 550 PRO TV tuner card securely. Replace your computer cover.
- 7 Reconnect any cables you have disconnected, and then plug in the computer's power cord.
- 8 Attach a TV antenna or cable cord to the **TV** connector on your THEATER™ 550 PRO TV tuner card.
- 9 Attach an FM antenna to the **FM** connector on your THEATER™ 550 PRO TV tuner card. If your cable service provides an FM signal, you can use a splitter to connect the cable to the FM and TV connectors on your card.

- 10 Plug the input dongle that came with your THEATER™ 550 PRO TV tuner card into the AV IN connection.
- 11 Attach your S-video source and/or composite source to the proper input on the input dongle.
- 12 Turn on the monitor, and then your computer. If you have properly installed your card, operating system messages will appear once the boot procedure is finished. Proceed with the installation of drivers and software.

Connecting Display Devices

The following connections are available:

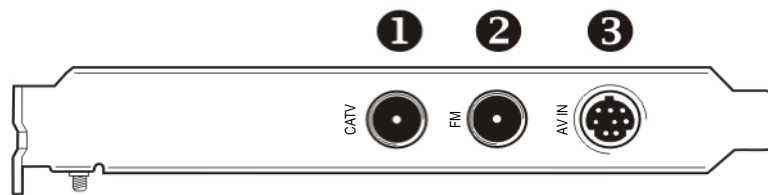

THEATER™ 550 PRO TV tuner card Baseplate

- | | |
|---|---|
| 1 | Cable TV Coaxial Connection |
| 2 | FM Radio Coaxial Connection |
| 3 | AV IN Connection (to Dongle)
If using a dongle: <ul style="list-style-type: none">• Black port → S-Video in.• Yellow port → Composite in.• Red port → Audio in (R).• White port → Audio in (L). |

CHAPTER 3:

Installing Software

This chapter will guide you through the installation of the drivers and software associated with your THEATER™ 550 PRO TV tuner card.

Note: In order to use your THEATER™ 550 PRO TV tuner card, you will need to install CyberLink PowerCinema or ATI Multimedia Center, or use Windows® XP Media Center Edition® 2005.

Installing Drivers and Software in Windows®

You will need to install the THEATER™ 550 PRO TV tuner card drivers and software in the following cases:

- After you have installed the card in your system.
- After you have reinstalled or upgraded your operating system.

This procedure applies to Windows® XP.

Software Installation Prerequisites

To install or remove the drivers, you must have administrator rights or be logged on as a user with administrator rights.

Your operating system must be installed and running before you can install the THEATER™ 550 PRO TV tuner card drivers. We also recommend that you have the latest Service Pack installed.

Note: The installation dialog will display in English if your operating system's language is not supported.

To install drivers

- 1 Start your system. When the **Found New Hardware Wizard** comes up, click **Cancel**. When the **System Settings Change** window asks you to restart your computer, click **No**.
- 2 Run the **SETUP** utility. The **SETUP** utility will start automatically if you insert the Installation CD-ROM into your CD-ROM drive after the operating system has started. If your CD-ROM auto-run is not enabled or the **SETUP** utility does not start automatically:
 - a) Click the **Start** button in the task bar.
 - b) Click **Run**.
 - c) Select **SETUP.EXE** from the root directory of the Installation CD-ROM.
 - d) Click **OK**.
- 3 Click **Install Driver** under Software Install.
- 4 Follow on-screen instruction and click **Next** to complete the installation.

Note: The **Express** installation option is recommended. **Custom** installation allows you to select individual software components for installation.

- 5 When the **Setup complete** message appears, select **Yes, I want to restart my computer now** and click **Finish**.
- 6 After the system reboots, the **Found New Hardware** message may display the **Digital Signature Not Found** message. Click **Yes** or **Continue** to complete the driver installation.

To install software (PowerCinema)

- 1** Run the **SETUP** utility again.

If your CD-ROM auto-run is not enable or the **SETUP** utility does not start automatically:

- Click the **Start** button in the task bar.
 - Click **Run**.
 - Select **SETUP.EXE** from the **X:\PCM\SETUP.EXE** (where **X** is the drive letter of your CD-ROM drive)
 - Click **OK**.
- 2** Click **Install PowerCinema** under Software Install
 - 3** Follow on screen instruction and Click **Next** to complete the installation

Note: You can find CD-key on the CD jacket.

* PowerCinema or other software are optional bundle for this product.

CHAPTER 4:

Using Your THEATER™ 550 PRO TV tuner card

Watch television on your computer! You can receive up to 125 cable television channels and 70 antenna channels in smooth, full-motion video, and view them on the whole screen or in a window.

Note: All channels may not be available in all countries.

The THEATER™ 550 PRO TV tuner card supports the following multimedia software:

- Windows® XP Media Center Edition® 2005
- CyberLink PowerCinema
- ATI Multimedia Center™

Several third-party TV viewing and PVR applications also work with your THEATER™ 550 PRO TV tuner card, including the following:

- InterVideo Home Theater™

For information on TV controls, see the online help and Tool Tips.



Launching your THEATER™ 550 PRO TV tuner card

Using Windows® XP Media Center Edition® 2005

To start TV from Windows® XP Media Center Edition® 2005

Note: You must have Windows® XP Media Center Edition® 2005 installed on your computer.

- 1 In the Windows® Start Menu, click **Media Center**.

or

- 1 From the Windows® Start Menu, choose **Programs > Accessories > Media Center > Media Center**.
- 2 Click the **MY TV** button, and then click **Live TV**.

Note: If video is not displayed, you may need to update your graphics card drivers.

Using CyberLink PowerCinema

To start TV from the Windows® taskbar

- 1 In the Windows® taskbar, click **Start**, and then point at **Programs**.
- 2 Point at **CyberLink PowerCinema**, and then select the feature you want to run.

For information on the CyberLink PowerCinema, see the online help (Point at CyberLink PowerCinema and select the online help).

 The first time you launch TV, you must complete the Initialization Wizard, which guides you through setting up TV. After that, the Wizard will not run unless you want to re-run it.

CyberLink PowerCinema is a all-in-one home entertainment center. Brings all your entertainment applications together on your PC.



You can use the provided remote control optional or the keyboard and mouse to select any of these options.

Using ATI Multimedia Center™

To start TV from the Windows® taskbar

- 1 In the Windows® taskbar, click **Start**, and then point at **Programs**.
- 2 Point at **ATI Multimedia Center**, and then select the feature you want to run.

For information on the ATI Multimedia Center, see the User's Guide and online help.



The first time you launch TV, you must complete the Initialization Wizard, which guides you through setting up TV. After that, the Wizard will not run unless you want to re-run it.

To start TV from the LaunchPad

The LaunchPad provides a convenient way to start all your Multimedia Center features — just click the one you want. LaunchPad opens automatically when you start your computer, or if you prefer, you can right-click LaunchPad, and uncheck **Load on Startup** in the drop-down menu to disable this feature.



The ATI Launchpad

CHAPTER 5:

Reference

This chapter offers troubleshooting tips and provides customer-care, warranty, and compliance information.

Troubleshooting

The following troubleshooting tips may help if you experience problems. This documentation contains helpful installation/configuration tips and other valuable feature information. Please contact your dealer for more advanced troubleshooting information.

Video & TV Problems

Problem	Possible Solution
Video is Unstable or Only Black and White	<ul style="list-style-type: none">• Check that you are using the correct broadcast standard format.• Check the quality of your incoming TV signal on another receiver; bad reception may be the cause.• Try connecting your tuner directly to the cable TV or antenna source. Too many splitters in the cable will degrade the signal.
There is No Video or Audio	<ul style="list-style-type: none">• Ensure that your cable or antenna is connected.• In the TV Video Settings page, ensure that the video connector is set to the correct source.• Check that the audio and video connectors are securely plugged into the correct jacks.• Check that your video card is securely seated in its slot. Please refer to the user guide for the card location.

Video & TV Problems

Problem

Possible Solution

Video Recording Stops Unexpectedly

- Video files are typically very large; ensure that you have sufficient disk space.
- Ensure that you are recording to the correct hard disk - check the Record on Drive setting in the Media Center by clicking on **My TV**, then **Settings**, then **Recorder** which takes you to the **Recorder Storage** page.
- The maximum file size for the FAT32 file system is 4 Gigabytes.
- Disable screen savers while recording.
- Disable Power management while recording.

Dropped Frames During Video Recording

Dropped frames during video recording indicates that some part of the system is not fast enough to keep up with the recording. Recording video is a very demanding task for even the most powerful system. To achieve the best results, you must dedicate the PC to recording, and ensure that nothing else is active during recording.

- Defragment your hard drive.
- A large, dedicated disk is recommended if you plan to do much video recording.
- Ensure that DMA is enabled for your hard drive, to improve disk access speed and free up the system CPU.
- Close all other running tasks, including those in the System Tray — clock, popup reminders, virus scanners, etc.
- Close and exit from any Task Scheduler.
- Do not log on to your network.
- Do not connect USB devices while recording.
- Do not open or close CD-ROM trays while recording.
- Do not move the mouse while recording.

Poor TV Reception

- If you use an indoor antenna, you will get the best results with an amplified model. Place it as far away from the PC monitor as possible, to avoid interference.
- Splitting the cable or antenna input can reduce the signal quality. For the best reception, connect the cable or antenna directly to your card.

Warranty Service

Please contact your original point of sale or product manufacturer for warranty service.

Compliance Information

FCC Compliance Information

This THEATER™ 550 PRO TV tuner card product complies with FCC Rules part 15. Operation is subject to the following two conditions

- This device may not cause harmful interference, and
- This device must accept any interference received, including interference that may cause undesired operation.

This equipment has been tested and found to comply with the limits for a Class B digital device, pursuant to Part 15 of the FCC Rules. These limits are designed to provide reasonable protection against harmful interference in a residential installation. This equipment generates, uses and can radiate radio frequency energy and, if not installed and used in accordance with manufacturer's instructions, may cause harmful interference to radio communications. However, there is no guarantee that interference will not occur in a particular installation. If this equipment does cause harmful interference to radio or television reception, which can be determined by turning the equipment off and on, the user is encouraged to try to correct the interference by one or more of the following measures:

- Re-orient or relocate the receiving antenna.
- Increase the separation between the equipment and receiver.
- Connect the equipment to an outlet on a circuit different from that to which the receiver is connected.
- Consult the dealer or an experienced radio/TV technician for help.

The use of shielded cables for connection of the monitor to the graphics card is required to ensure compliance with FCC regulations. Changes or modifications to this unit not expressly approved by the party responsible for compliance could void the user's authority to operate this equipment.

Industry Canada Compliance Statement

ICES-003 This Class B digital apparatus complies with Canadian ICES-003.

Cet appareil numérique de la Classe B est conforme à la norme NMB-003 du Canada.

CE Compliance Information

EMC Directive 89/336/EEC and amendments 91/263/EEC, 92/31/EEC and 93/68/EEC, Class B Digital Device EN 55022:2003/CISPR 22 Class B, Limits and Methods of Measurement of Radio Interference Characteristics Information Technology Equipment.

EN 55024:1998/CISPR 24:1997 +A1:2001 +A2:2003, Immunity of Information Technology Equipment (ITE), including EN 61000-4-2, EN 61000-4-3, EN 61000-4-4, EN 61000-4-5, EN 61000-4-6

Low Voltage Directive for TV-Tuner-Equipped products 73/23/EEC - The Low Voltage Directive.

EN 60950: 1992+A1+A2+A3+A4 - Safety of Information Technology Equipment.

Informations de conformité de la CE

Directive EMC 89/336/CEE et amendements 92/31/CEE et 93/68/CEE, pour dispositif numérique de Classe B.

EN 55022:2003/CISPR 22:1997, - Classe B - Limites et méthodes de mesure des caractéristiques d'interférences radiophoniques, Matériel des technologies de l'information.

EN 55024:1998/CISPR 24:1997 +A1:2001 +A2:2003, Norme sur l'immunité de matériel des technologies de l'information, et comprenant EN 61000-4-2, EN 61000-4-3, EN 61000-4-4, EN 61000-4-5, EN 61000-4-6

Directive de Basse Tension pour produits équipés tuner TV.

73/23/CEE - Directive de basse tension.

EN 60950 : 1992+A1+A2+A3+A4 - Sécurité du matériel des technologies de l'information.

CE-Konformitätserklärung

MC Richtlinie 89/336/EEC und Änderungen 92/31/EWG und 93/68/EWG, Digitales Gerät der Klasse B.

EN 55022:2003/CISPR 22:1997, - Klasse B - Grenzwerte und Meßverfahren für Funkstörungen von Einrichtungen der Informationstechnik.

EN 55024:1998/CISPR 24:1997 +A1:2001 +A2:2003, Unempfindlichkeits-Standard für informationstechnische Ausrüstungen, einschliesslich EN 61000-4-2, EN 61000-4-3, EN 61000-4-4, EN 61000-4-5, EN 61000-4-6

Niederspannung Richtlinie für Produkte Enthalten Fernsehen tuner 73/23/EWG - Niederspannungsrichtlinie.

EN 60950: 1992+A1+A2+A3+A4 - Sicherheit für Einrichtungen der Informationstechnik.



The Video Revolution

THEAT
.....
User Ma



746-000000116

