



# Terminator™ II TMCX



### TMCX cable glands are used in many applications with the following cable types:

- Metal-clad and TECK (interlocked and continuously welded corrugated armoured) cable
- Unarmoured and tray cable

### Safe and Secure Assembly Every Time

- Designed to minimize the opportunity for incorrect assembly
- Simple selection process and field preparation aids to ensure the right gland is selected every time
- Full coverage of all popular cables and hub sizes, ensuring a perfect seal in all instances
- Chico® LiquidSeal or standard TSC epoxy compound options for assembly in any orientation
- Use of nickel-plated brass and stainless steel to increase corrosion resistance and maintain integrity in the harshest environments

### Drastically Reduced Installation Time

- Chico® LiquidSeal, an innovative liquid compound with a fast gel and cure time, reduces waiting times
- Integral union design reduces the number of times the gland has to be assembled and disassembled during installation
- Mating components have generous lead-ins to ensure that assembly is as trouble-free as possible, even with the heaviest cables



### Wide Selection of Options to Serve Global Market

- Metric size threads allow interfacing to European machinery
- Wide range of global certifications and approvals

### Certifications and Compliances:

- Class I, Division 1, Groups A, B, C, D
- Class II, Groups E, F, G
- Class III
- cULus
- ATEX/IECEx (Pending)
- NEMA 6P

### Features:

- Standard material is aluminum
- Copper-plated stainless steel spring for true 360° grounding
- -20° to 60°C temperature range
- Available with NPT or metric threads
- Available in nickel-plated brass and 316L stainless steel construction

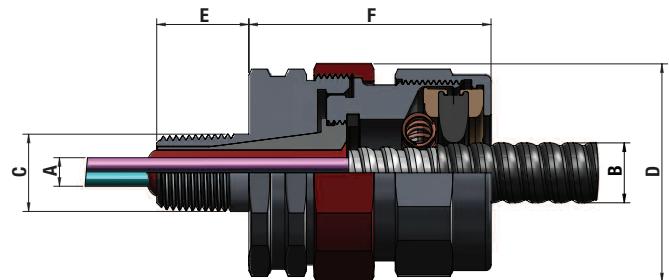
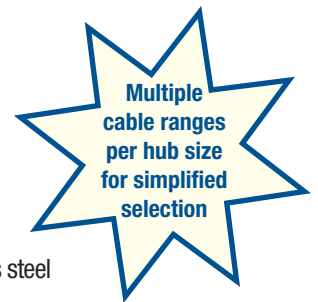

SELECTION TABLE

Entry Thread 'C'	NPT Catalog No.	Entry Thread 'C' (Metric Option)	Metric Catalog No.	'A' Armour O.D.		'B' Cable O.D.		Across Corners 'D'	Thread Length NPT 'E' (Metric mm)	Length 'F'
				Min.	Max.	Min.	Max.			
½"	TMCX050 1	M20	TMCXM20 1	0.40	0.86	0.49	0.90	1.557	1.00 (25.4)	3.05
½"	TMCX050 2	M20	TMCXM20 2	0.56	1.14	0.65	1.18	1.994	1.00 (25.4)	3.18
¾"	TMCX075 1	M25	TMCXM25 1	0.40	0.86	0.49	0.90	1.557	1.00 (25.4)	3.05
¾"	TMCX075 2	M25	TMCXM25 2	0.56	1.14	0.65	1.18	1.994	1.00 (25.4)	3.18
1"	TMCX100 1	M32	TMCXM32 1	0.56	1.14	0.65	1.18	1.994	1.08 (27.4)	3.18
1"	TMCX100 2	M32	TMCXM32 2	0.78	1.35	0.87	1.39	2.244	1.08 (27.4)	3.30
1 ¼"	TMCX125 1	M40	TMCXM40 1	0.78	1.35	0.87	1.39	2.244	1.08 (27.4)	3.30

All dimensions in inches unless otherwise noted. Sizes 1 ½" and above will be available soon.

## Catalog Numbering System:

SERIES	HUB SIZE	CABLE SEALING RANGE	MATERIAL	COMPOUND TYPE
TMCX	050	1	NP	L

### HUB SIZE

NPT	Hub (in.)	Metric	Hub (mm)
050	½"	M20	20
075	¾"	M25	25
100	1"	M32	32
125	1 ¼"	M40	40

### MATERIAL

BLANK	Aluminum
SS	316 Stainless Steel
NP	Nickel-plated Brass

### COMPOUND TYPE

(see additional information below)

BLANK	TSC
L	Liquid

## CABLE SEALING RANGE

Hub Size Code	Thread		Sealing Range Code	Standard Cable Sealing Range
050	½"	NPT	1	0.49"-0.90"
			2	0.65"-1.18"
075	¾"	NPT	1	0.49"-0.90"
			2	0.65"-1.18"
100	1"	NPT	1	0.65"-1.18"
			2	0.87"-1.39"
125	1 ¼"	NPT	1	0.87"-1.39"
M20	M20	ISO	1	12.4mm-22.8mm
			2	16.5mm-29.9mm
M25	M25	ISO	1	12.4mm-22.8mm
			2	16.5mm-29.9mm
M32	M32	ISO	1	16.5mm-29.9mm
			2	22.0mm-35.3mm
M40	M40	ISO	1	22.0mm-35.3mm

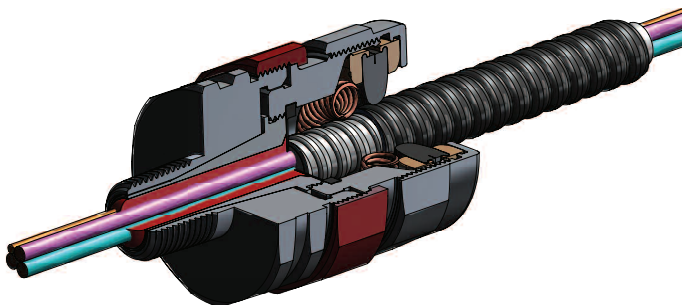

### Chico® LiquidSeal vs. TSC Epoxy Compound

- |   |  |
|---|--|
| <ul style="list-style-type: none"> <li>■ Highly engineered rapid curing compound</li> <li>■ Mixing time: 2 minutes</li> <li>■ Application: pour/gun</li> <li>■ Fast gel and cure time</li> <li>■ Available for installation in vertical position</li> </ul> | <ul style="list-style-type: none"> <li>■ Mixing time: 5 minutes</li> <li>■ Application: by hand</li> <li>■ Fully cure time: 24 hours</li> <li>■ Available for installation in any orientation</li> </ul> |
|---|--|

