

TP155 Thermostat Operation Instructions

1、Overview:

TP155 thermostat is mainly used in the control of electric heating, or wall-mounted boiler, or water valve on the collector in heating system. Based on the setting temperature, the testing ambient temperature as the variable, it can automatically control the on/off of the equipment. Thus to achieve the thermostatic control of temperature.

2、Model control instruction:

AZ155 thermostat is used for control of electric heating in heating system or circulating pump, with the output signal for AC220V, contact capacity of 10 A (16 A), the control modes are as follows:

- 1) Off mode: The equipment is under off state.
- 2) On mode: When the setting temperature is higher than the testing temperature, the equipment starts, if lower, it stops.

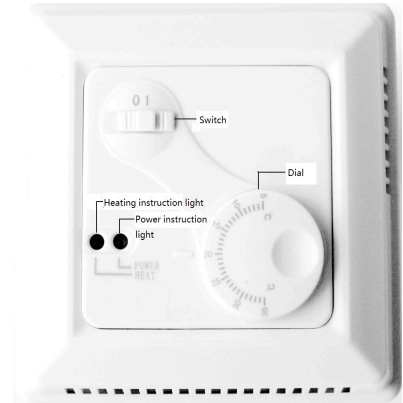

3、Operation methods:

- 1) Make the right wirings,1-6: L,N,N,O,T,T.
- 2) Toggle the switch to select the control modes(On/Off), 0:Off, 1:On, the power instruction light will lit.
- 3) Switch the dial to set up the temperature, when the testing ambient temperature is higher than setting temperature, the heating instruction light goes out, when the testing ambient temperature is less than setting temperature, the heating instruction light goes on, the electric heating starts.

4、Overheating protection function

Overheating protection function is optional, the user should state clearly when needed.

10K NTC is used in the overheating protection temperature sensor, the optional overheating protection range are 55,60,65℃, the factory has been set 55℃, the user can't change it.

5、Technical data:

Content	Statement	Content	Statement
Power supply	AC220V±10% 50/60HZ	Power consumption	≤100mA
Control range	10~50℃	Installation size	2-M4, 60
Control precision	±1℃	Temperature elements	NTC 10K
Outer shell	PC+ABS Anti-flaming material	Dimension	86×86×50mm
Weight	170g	Wiring connection	terminal

6、Typical product wiring diagram:

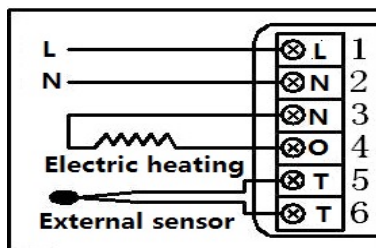

Note:

“L-N” connect AC90~260V

“N-O” heating after power on, with contact capacity 16A;

“T-T” connects 10 K external protection temperature sensors.

7. Installation instructions:

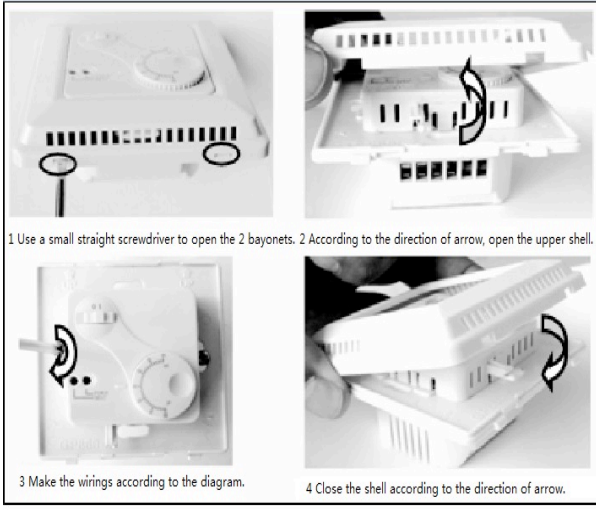

Note:

1. Before doing the wiring installation considerations, disconnect all power to avoid the equipment burning out.

2. Get the outer shell installation and wiring process done through the electric professional.