

Specification Status: Released

Max Electrical Rating at 20°C

Operating Voltage: 250V_{DC}
Fault Voltage: 600V_{RMS}
Interrupt Current: 3A_{RMS}

Lead Material :
 22 AWG Sn/Pb plated copper

Marking:

- Raychem Logo and Voltage
- Part Identification
- Lot Identification

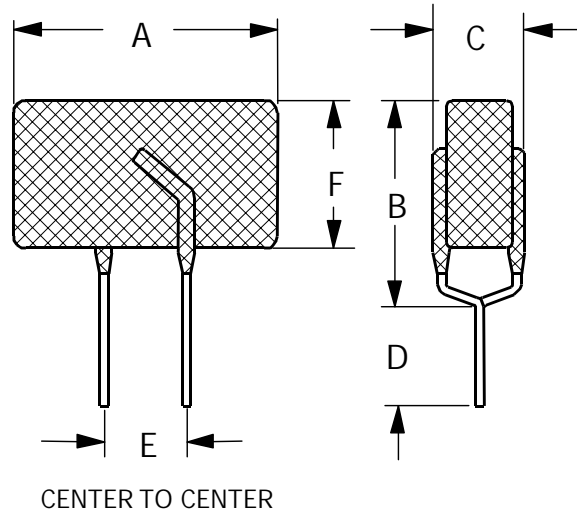

TABLE I. DIMENSIONS:

	A		B		C		D		E	F	
	MIN	MAX	MIN	MAX	MIN	MAX	MIN	MAX	NOM	MIN	MAX
mm:	--	16.0	--	12.6	--	6.0	4.7	--	5.0		10.0
in:	--	(0.630)	--	(0.496)	--	(0.236)	(0.185)	--	(0.197)		(0.394)

TABLE II. PERFORMANCE RATINGS @ 20°C (unless otherwise noted):

I _{HOLD} (A)		RESISTANCE (Ω)			TYPICAL TIME TO TRIP (S) @ 1A TYP	OPERATING TEMPERATURE (°C)	
20°C	60°C	R MIN	R MAX	R _{1 MAX} *		MIN	MAX
0.160	0.100	4.0	7.0	16.0	9.5	-40	85

* Maximum device resistance @ 20°C measured 1 hour post trip.

Storage Temperature: -40° to 85°C

Reference Documents:

Precedence:

Effectivity:

CAUTION:

PS300

This specification takes precedence over documents referenced herein.

Reference documents shall be the issue in effect on the date of invitation for bid.

Operation beyond the rated voltage or current may result in rupture, electrical arcing or flame.