

**Description**

- Low DC Resistance and large current.
- Best for the power supply line.
- High dimensional accuracy.
- Meets UL 94V-0 flammability standard.
- RoHS Compliance

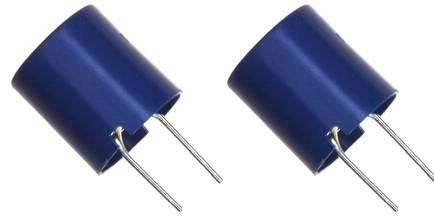

**Applications**

- Ideally Used in Printers, LCD TV, DVD, Printer, Copy Machine, Main board of the compounding machines, etc as Power Supplies's Inductors or DC-DC Converter inductors.

**Environmental Data**

- Terminations: Tin-silver over tin over copper over steel. Other terminations available at additional cost.
- Ambient temperature: -40°C to +85°C with Irms current.
- Storage temperature Component: -40°C to +85°C. Packaging: -40°C to +80°C
- Moisture Sensitivity Level (MSL): 1 (unlimited floor life at <30°C /85% relative humidity)

**Mechanical Diagrams (Unit:mm)**

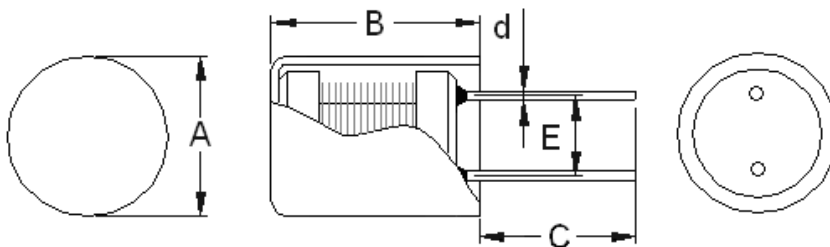

A=11.20+/-0.30  
B=12.20+/-0.30  
C=5.00+/-0.50  
d=0.65+/-0.10  
E=5.00+/-0.50

Part No.	Inductance <sup>(1)</sup> ( $\mu$ H)	DC Resistance <sup>(2)</sup> ( $\Omega$ ) Max	Q Factor <sup>(3)</sup> (Min)	SRF Typ. (MHz)	Isat <sup>(4)</sup> (A) Max	Irms <sup>(5)</sup> (A) Max	Mark Code <sup>(6)</sup>
TSL1112-1R0M	1.0 $\pm$ 20%	0.058	15	144	14	7.7	1R0
TSL1112-2R2M	2.2 $\pm$ 20%	0.073	15	70	10	6.7	2R2
TSL1112-3R3M	3.3 $\pm$ 20%	0.010	10	36	8.8	5.9	3R3
TSL1112-4R7M	4.7 $\pm$ 20%	0.015	10	28	7.2	4.8	4R7
TSL1112-6R8M	6.8 $\pm$ 20%	0.016	10	18	6.1	4.6	6R8
TSL1112-100M	10 $\pm$ 20%	0.025	20	16	5.0	3.7	100
TSL1112-150M	15 $\pm$ 20%	0.029	20	12	4.2	3.4	150
TSL1112-220K	22 $\pm$ 10%	0.040	20	9.5	3.4	2.9	220
TSL1112-330K	33 $\pm$ 10%	0.062	30	7.0	2.8	2.3	330
TSL1112-470K	47 $\pm$ 10%	0.075	30	5.8	2.3	2.1	470
TSL1112-680K	68 $\pm$ 10%	0.13	20	4.7	1.9	1.6	680
TSL1112-101K	100 $\pm$ 10%	0.16	20	3.8	1.6	1.4	101
TSL1112-151K	150 $\pm$ 10%	0.26	20	3.1	1.3	1.1	151
TSL1112-221K	220 $\pm$ 10%	0.33	20	2.5	1.1	1.0	221
TSL1112-331K	330 $\pm$ 10%	0.52	20	2.0	0.88	0.82	331
TSL1112-471K	470 $\pm$ 10%	0.66	10	1.6	0.75	0.72	471
TSL1112-681K	680 $\pm$ 10%	1.1	10	1.3	0.61	0.56	681
TSL1112-102J	1000 $\pm$ 5%	1.4	20	1.1	0.51	0.50	102
TSL1112-152J	1500 $\pm$ 5%	2.4	30	0.82	0.43	0.38	152
TSL1112-222J	2200 $\pm$ 5%	3.2	20	0.76	0.35	0.33	222
TSL1112-332J	3300 $\pm$ 5%	4.9	30	0.64	0.28	0.26	332

**Notes:**

- 1) Open circuit inductance test parameters: 1.0kHz, 1.0Vrms, 0.0Adc, Test Equipment : HP4284A or WK3260B LCR Meter.
- 2) DCR limits @ 20°C. Test Equipment: CH502BC.
- 3) Q factor test condition: 1.0uH~6.8uH/7.96MHz, 10.0uH~68.0uH/2.52MHz, 100uH~680uH/796KHz, 1000uH~3300uH/252KHz.
- 4) Isat current for an approximate 20% rolloff at 20°C
- 5) Irms current for for an approximate T of 25°C. It is recommended that the temperature of the part not exceed 125°C
- 6) The Marking Code.

**Hubei Indu Electronics Technology Co., Ltd**  
**Indu Electronic Technology Hong Kong Co., Limited**

Add: AnHua Road, HuCi Village, ChenDian Town, AnLu City, Hubei province, China.

Tel: +86-712-5593060 Fax: +86-712-5593060

[Http://www.hbindu.com](http://www.hbindu.com)

**Dong Guan Office:**

Add: 2F, 22#, BaoLong 1st Street, TianMei Zones, HuangJiang, DongGuan, GuangDong, China.

Tel: +86-769-86919928

Fax: +86-769-86919968

