

TO-252
(DPAK)



Pin Definition:

1. Gate
2. Drain
3. Source

PRODUCT SUMMARY

V _{DS} (V)	R _{DS(on)} (mΩ)	I _D (A)
30	4.5 @ V _{GS} =10V	60

Features

- Advanced Trench Technology
- Low R_{DS(ON)} 4.5mΩ (Max.)
- Low gate charge typical @ 12nC (Typ.)
- Low Crss typical @ 140pF (Typ.)

Ordering Information

Part No.	Package	Packing
TSM60N03CP ROG	TO-252	2.5Kpcs / 13" Reel

Note: "G" denote for Halogen Free Product

Block Diagram

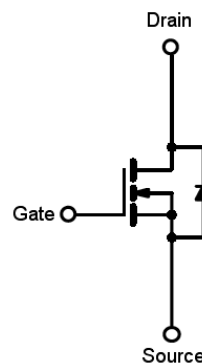

N-Channel MOSFET

Absolute Maximum Rating (T_C = 25°C unless otherwise noted)

Parameter	Symbol	Limit	Unit
Drain-Source Voltage	V _{DS}	30	V
Gate-Source Voltage	V _{GS}	±20	V
Continuous Drain Current	I _D	T _C = 25°C	60
		T _C = 70°C	48
		T _A = 25°C	19
		T _A = 70°C	15
Drain Current-Pulsed *	I _{DM}	140	A
Avalanche Current, L = 0.1mH	I _{AS} , I _{AR}	38	A
Avalanche Energy, L = 0.1mH	E _{AS} , E _{AR}	72	mJ
Maximum Power Dissipation	P _D	T _C = 25°C	41
		T _C = 70°C	26
		T _A = 25°C	2.5
		T _A = 70°C	1.6
Storage Temperature Range	T _{STG}	-55 to +150	°C
Operating Junction Temperature Range	T _J	-55 to +150	°C

* Limited by maximum junction temperature

Thermal Performance

Parameter	Symbol	Limit	Unit
Thermal Resistance - Junction to Case	R _{θJC}	3	°C/W
Thermal Resistance - Junction to Ambient	R _{θJA}	50	°C/W

Notes: Surface mounted on FR4 board t ≤ 10sec

Electrical Specifications (T_C = 25°C unless otherwise noted)

Parameter	Conditions	Symbol	Min	Typ	Max	Unit
Static						
Drain-Source Breakdown Voltage	V _{GS} = 0V, I _D = 250uA	BV _{DSS}	30	--	--	V
Drain-Source On-State Resistance	V _{GS} = 10V, I _D = 19A	R _{DS(ON)}	--	3.5	4.5	mΩ
	V _{GS} = 4.5V, I _D = 16A	R _{DS(ON)}	--	4.6	5.8	mΩ
Gate Threshold Voltage	V _{DS} = V _{GS} , I _D = 250uA	V _{GS(TH)}	1.15	--	2.2	V
Zero Gate Voltage Drain Current	V _{DS} = 30V, V _{GS} = 0V	I _{DSS}	--	--	1	uA
Gate Body Leakage	V _{GS} = ±20V, V _{DS} = 0V	I _{GSS}	--	--	±100	nA
Dynamic						
Total Gate Charge	V _{DS} = 15V, I _D = 19A, V _{GS} = 4.5V	Q _g	--	12	--	nC
Gate-Source Charge		Q _{gs}	--	5.4	--	
Gate-Drain Charge		Q _{gd}	--	4.6	--	
Input Capacitance	V _{DS} = 15V, V _{GS} = 0V, f = 1.0MHz	C _{iss}	--	1700	--	pF
Output Capacitance		C _{oss}	--	350	--	
Reverse Transfer Capacitance		C _{rss}	--	140	--	
Switching						
Turn-On Delay Time	V _{GS} = 4.5V, V _{DS} = 15V, R _G = 1.5Ω, I _D = 10A	t _{d(on)}	--	25	--	nS
Turn-On Rise Time		t _r	--	20	--	
Turn-Off Delay Time		t _{d(off)}	--	25	--	
Turn-Off Fall Time		t _f	--	15	--	
Drain-Source Diode Characteristics and Maximum Rating						
Drain-Source Diode Forward Voltage	V _{GS} = 0V, I _S = 10A	V _{SD}	-	0.8	1.2	V
Reverse Recovery Time	I _S = 10A, T _J = 25°C	t _{fr}		25		nS
Reverse Recovery Charge	di/dt = 100A/us	Q _{fr}		17		nC

Notes:

1. Pulse Test: Pulse Width ≤ 300μs, Duty Cycle ≤ 2%.
2. R_{θJA} is the sum of the junction-to-case and case-to-ambient thermal resistance where the case thermal reference is defined as the solder mounting surface of the drain pins. R_{θJC} is guaranteed by design while R_{θCA} is determined by the user's board design. R_{θJA} shown below for single device operation on FR-4 in still air
3. The maximum current rating is limited by package

TO-252 Mechanical Drawing

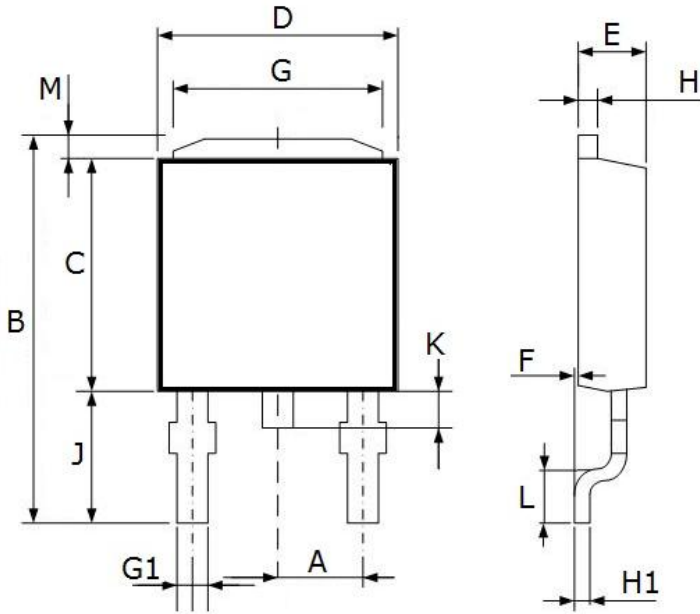

TO-252 DIMENSION				
DIM	MILLIMETERS		INCHES	
	MIN	MAX	MIN	MAX
A	2.286 BSC		0.090 BSC	
B	9.40	10.40	0.370	0.409
C	5.40	6.23	0.213	0.245
D	6.40	6.80	0.252	0.268
E	2.20	2.40	0.087	0.094
F	0.00	0.20	0.000	0.008
G	5.20	5.50	0.205	0.217
G1	0.50	0.91	0.020	0.036
H	0.45	0.60	0.018	0.024
H1	0.40	0.60	0.016	0.024
J	2.50	2.90	0.098	0.114
K	0.60	1.00	0.023	0.039
L	1.40	1.78	0.055	0.070
M	0.88	1.28	0.034	0.050

Notice

Specifications of the products displayed herein are subject to change without notice. TSC or anyone on its behalf, assumes no responsibility or liability for any errors or inaccuracies.

Information contained herein is intended to provide a product description only. No license, express or implied, to any intellectual property rights is granted by this document. Except as provided in TSC's terms and conditions of sale for such products, TSC assumes no liability whatsoever, and disclaims any express or implied warranty, relating to sale and/or use of TSC products including liability or warranties relating to fitness for a particular purpose, merchantability, or infringement of any patent, copyright, or other intellectual property right.

The products shown herein are not designed for use in medical, life-saving, or life-sustaining applications. Customers using or selling these products for use in such applications do so at their own risk and agree to fully indemnify TSC for any damages resulting from such improper use or sale.