

Two Terminals SMD Switching Diode

Features

- Low Forward Voltage
- Fast Reverse Recovery Time
- Small Total Capacitance
- RoHS Compliant

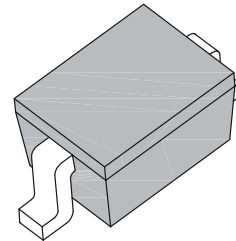

SOD-323

Mechanical Data

Case:	SOD-323, Plastic Case
Terminals:	Solderable per MIL-STD-750, Method 2026
Polarity:	Color band denotes cathode end
Weight:	Approx. 0.0041 gram

Maximum Ratings *(T_{Ambient}=25°C unless noted otherwise)*

Symbol	Description	TWD4148-160WS	Unit	Conditions
	Marking Code	UF		
VRM	Max. Reverse Voltage	80	V	
VRRM	Peak Reverse Voltage	85	V	
IFM	Max. Peak Forward Current	300	mA	
IF(AV)	Max. Forward Average Current at T _A =25° C	100	mA	
IFSM	Peak Forward Surge Current, Pulse Width=10mS	2.0	A	
PD	Power Dissipation	200	mW	Note
TJ	Junction Temperature	150	° C	
TSTG	Storage Temperature Range	-55 to +150	° C	

Note: Mounted on a glass epoxy circuit board of 20x20mm, pad dimension of 4x4mm.

Two Terminals SMD Switching Diode

TWD4148-160WS

Electrical Characteristics ($T_{Ambient}=25^{\circ}C$ unless noted otherwise)

Symbol	Description	TYP.	MAX.	Unit	Conditions
V_F	Max. Forward Voltage	0.60	-	V	I _F =1mA
		0.72	-		I _F =10mA
		0.90	1.20		I _F =100mA
I_R	Reverse Current	-	0.5	μA	V _R =80V
C_T	Total Capacitance	0.9	3.0	pF	V _R =0V, f=1MHz
T_{rr}	Max. Reverse Recovery Time	1.6	4.0	nS	I _F =10mA ,

Typical Characteristics Curves

Fig.1- Typical Instantaneous Forward Characteristics

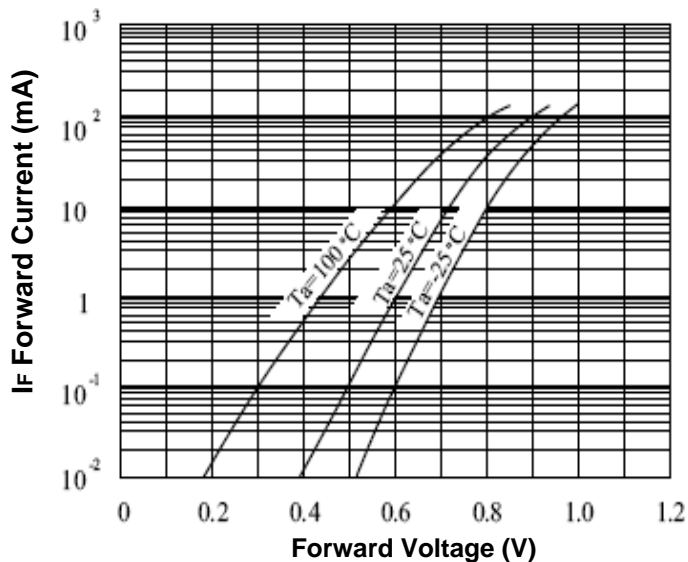
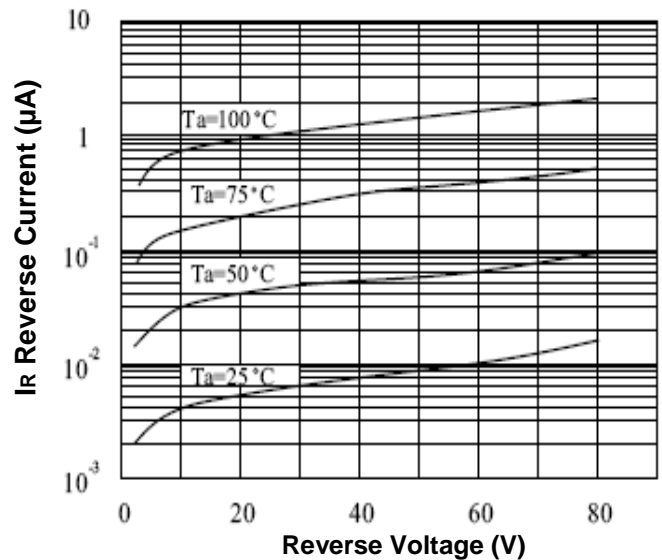

Fig.2- Typical Instantaneous Reverse Characteristics Curve



Two Terminals SMD Switching Diode

TWD4148-160WS

Fig.3- $C_T - V_R$

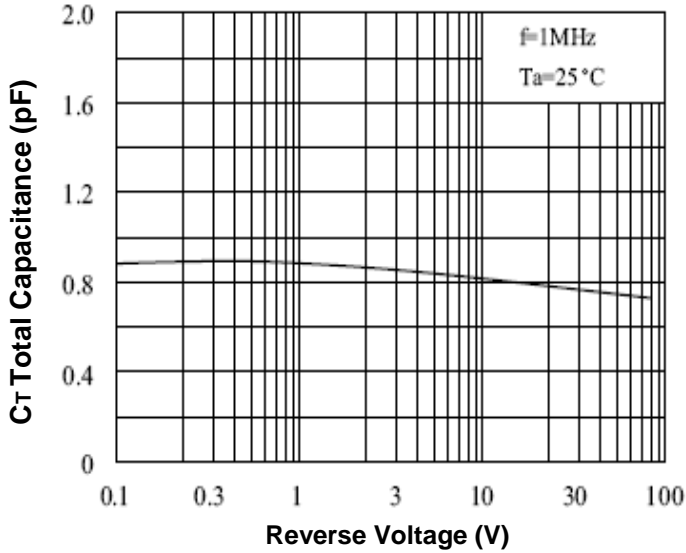

Fig.4- $T_{rr} - I_F$

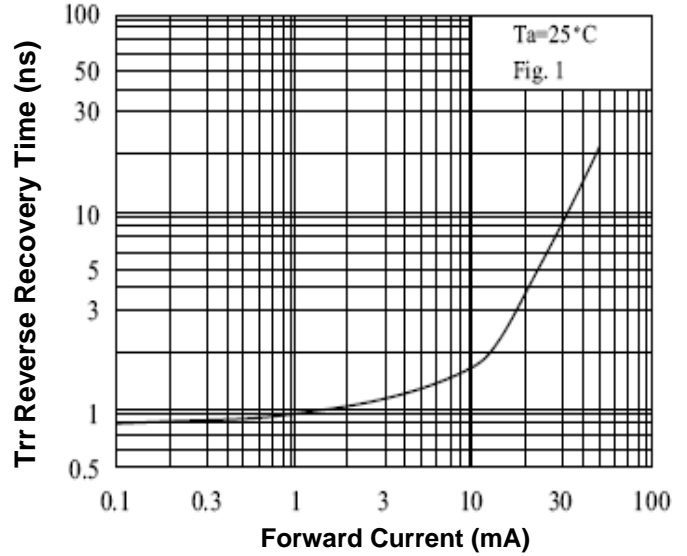
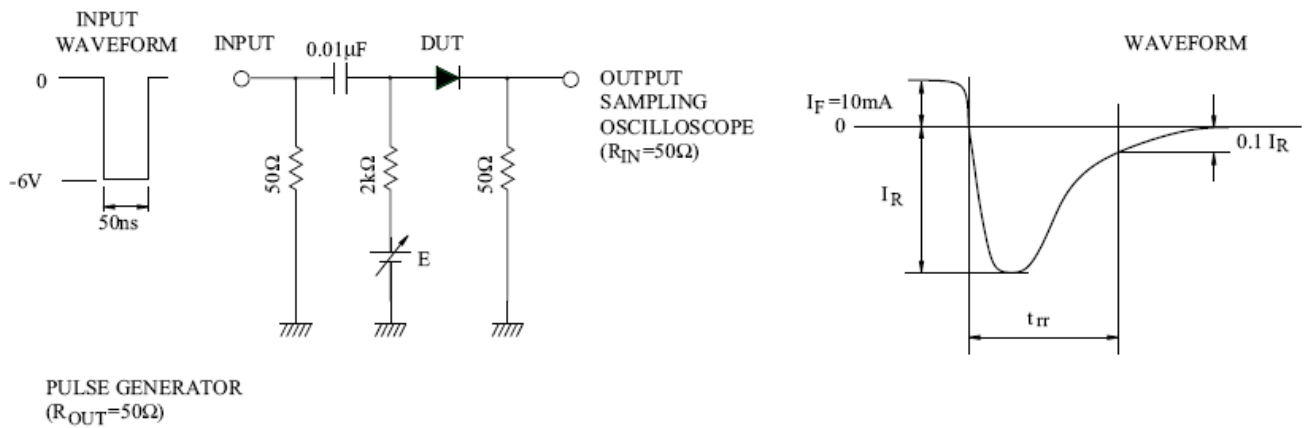

Fig. 1. REVERSE RECOVERY TIME(t_{rr}) TEST CIRCUIT



Two Terminals SMD Switching Diode

TWD4148-160WS

Marking Information:

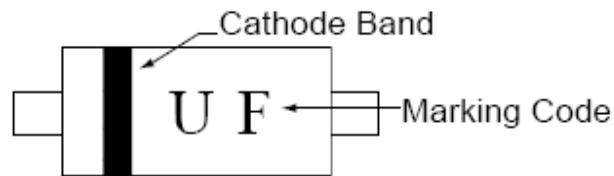

Dimensions in mm

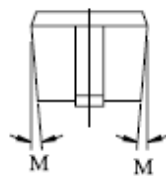
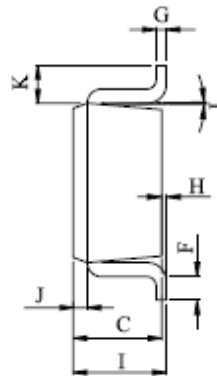
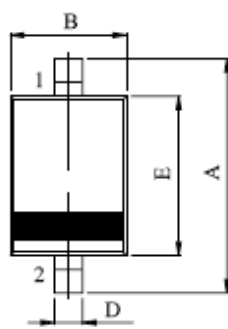

- 1. ANODE
- 2. CATHODE

DIM	MILLIMETERS
A	2.50±0.1
B	1.25±0.05
C	0.90±0.05
D	0.30+0.06/-0.04
E	1.70±0.05
F	MIN 0.17
G	0.126±0.03
H	0~0.1
I	1.0 MAX
J	0.15±0.05
K	0.4±0.05
L	2°+4/-2
M	4~6°

SOD-323

Two Terminals SMD Switching Diode

TWD4148-160WS

How to contact us:

US HEADQUARTERS

28040 WEST HARRISON PARKWAY, VALENCIA, CA 91355-4162

Tel: (800) TAITRON (800) 824-8766 (661) 257-6060

Fax: (800) TAITFAX (800) 824-8329 (661) 257-6415

Email: taitron@taitroncomponents.com

Http://www.taitroncomponents.com

TAITRON COMPONENTS MEXICO, S.A .DE C.V.

BOULEVARD CENTRAL 5000 INTERIOR 5 PARQUE INDUSTRIAL ATITALAQUIA, HIDALGO C.P. 42970
MEXICO

Tel: +52-55-5560-1519

Fax: +52-55-5560-2190

TAITRON COMPONENTS INCORPORATED REPRESENTAÇÕES DO BRASIL LTDA

RUA DOMINGOS DE MORAIS, 2777, 2.ANDAR, SALA 24 SAÚDE - SÃO PAULO-SP 04035-001 BRAZIL

Tel: +55-11-5574-7949

Fax: +55-11-5572-0052

TAITRON COMPONENTS INCORPORATED, SHANGHAI REPRESENTATIVE OFFICE

METROBANK PLAZA, 1160 WEST YAN' AN ROAD, SUITE 1503, SHANGHAI, 200052, CHINA

Tel: +86-21-5424-9942

Fax: +86-21-5424-9931