

# UG-2832GLBAT02

[www.DataSheet4U.com](http://www.DataSheet4U.com)

Module : OLED + TCP

Size : 1.11"

● Device Drawing

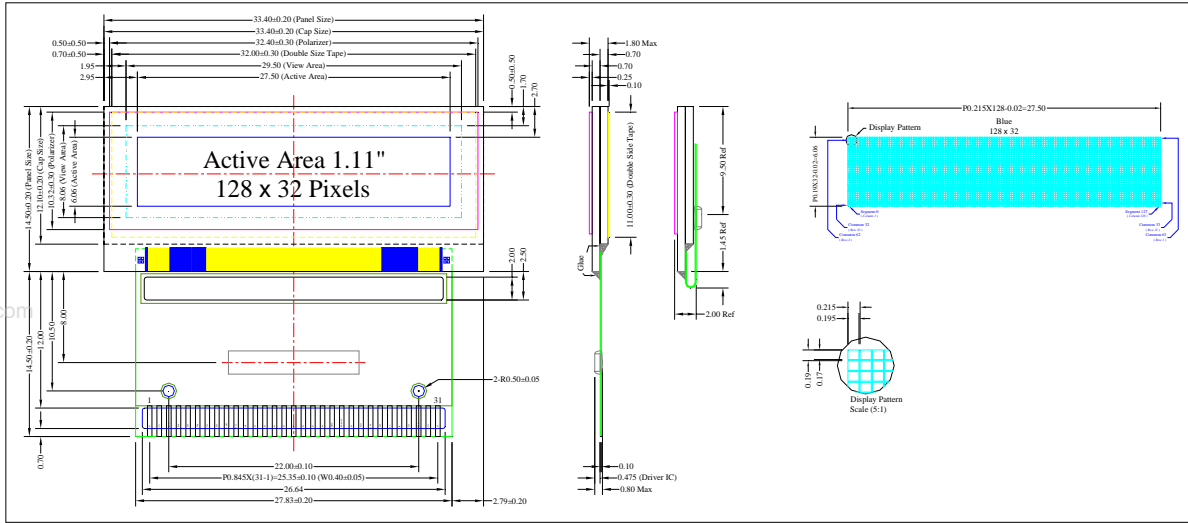

● Physical Data

- Diagonal Screen Size : 1.11 inch
- Resolution : 128 x 32 Dots
- Display Color : Monochrome ( Light Blue )
- Module Size : 33.40 x 29.00 x 1.80 mm
- Panel Size : 33.40 x 14.50 x 1.80 mm
- Active Area : 27.50 x 6.06 mm
- Pixel Pitch : 0.215 x 0.19 mm
- Pixel Size : 0.195 x 0.17 mm
- Weight : TBD

● Optical Characteristics(V<sub>DD</sub>=2.8 ± 0.25V 25°C)

Characteristics	Symbol	Condition	Typical	Unit
Brightness	L <sub>br</sub>	Average	60	cd/m <sup>2</sup>
Contrast Ratio	CR	Dark Room	>1:100	-

● DC Characteristics

Characteristics	Symbol	Min	Typ	Max	Unit
Supply Voltage	V <sub>DD</sub>	2.6	2.8	3.5	V
Driver Supply Voltage	V <sub>EE</sub>	7.0	7.5	8.5	V
Drive Method	1/32 Duty				
Operating Temperature	T <sub>OP</sub>	-20		70	°C
Storage Temperature	T <sub>STG</sub>	-30		80	°C