

ALUMINUM ELECTROLYTIC CAPACITORS



HM Low Impedance,
For PC motherboard
series



- Lower impedance than HD, HC series.
- Compliant to the RoHS directive (2002/95/EC).

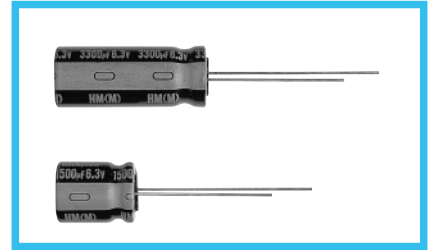

Specifications

Item	Performance Characteristics				
Category Temperature Range	-40 to +105°C				
Rated Voltage Range	6.3 to 16V				
Rated Capacitance Range	330 to 12000μF				
Capacitance Tolerance	±20% (120Hz, 20°C)				
Leakage Current	After 2 minutes' application of rated voltage, leakage current is less than 0.03CV				
Tangent of loss angle (tan δ)	For capacitance of more than 1000μF, add 0.02 for every increase of 1000μF				
	Rated voltage (V)	6.3	10	16	120Hz 20°C
Stability at Low Temperature	tan δ (MAX.)	0.22	0.19	0.16	
	Rated voltage (V)	6.3	10	16	120Hz
Endurance	Impedance ratio ZT / Z20 (MAX.)	Z-40°C / Z+20°C	3	3	3
	The specifications listed at right shall be met when the capacitors are restored to 20°C after D.C. bias plus rated ripple current is applied for 2000 hours at 105°C, the peak voltage shall not exceed the rated voltage.				
Marking	Capacitance change	Within ±25% of the initial capacitance value			
	tan δ	200% or less than the initial specified value			
	Leakage current	Less than or equal to the initial specified value			
Marking	Printed with white color letter on black sleeve.				

Radial Lead Type

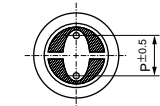
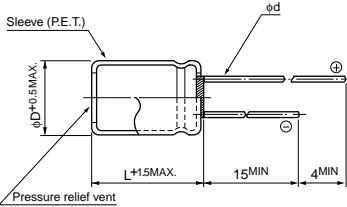

	(mm)				
φD	8	10	12.5	16	18
P	3.5	5.0	5.0	7.5	7.5
φd	0.6	0.6	0.6	0.8	0.8

Type numbering system (Example : 6.3V 1800μF)

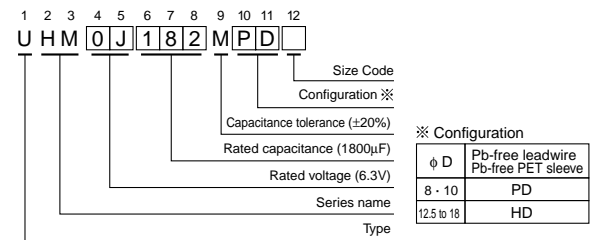

- Please refer to page 20 about the end seal configuration.

Standard Ratings

V (Code)	Item Code	6.3 (0J)			10 (1A)			16 (1C)			
		Case size φD × L (mm)	Impedance (mΩ) MAX. 20°C / 100kHz	Rated ripple (mArms) 105°C / 100kHz	Case size φD × L (mm)	Impedance (mΩ) MAX. 20°C / 100kHz	Rated ripple (mArms) 105°C / 100kHz	Case size φD × L (mm)	Impedance (mΩ) MAX. 20°C / 100kHz	Rated ripple (mArms) 105°C / 100kHz	
330	331							8 × 11.5	30	1140	
	470	471			8 × 11.5	30	1140	8 × 11.5	30	1140	
560	561	8 × 11.5	30	1140				▲ 10 × 12.5	25	1540	
	680	681			8 × 11.5	30	1140	10 × 12.5	25	1540	
820	821	8 × 11.5	30	1140	▲ 10 × 12.5	25	1540	▲ 8 × 15	28	1490	
	1000	102	8 × 15	28	1490	▲ 8 × 15	28	1490	● 8 × 20	18	1870
			▲ 10 × 12.5	25	1540	● 10 × 16	18	2000	○ 10 × 16	18	2000
1200	122	8 × 15	28	1490	○ 8 × 20	18	1870				
		10 × 12.5	25	1540	10 × 16	18	2000				
1500	152	▲ 8 × 20	16	1950	▲ 8 × 20	18	1870	10 × 20	13	2550	
		● 10 × 16	18	2000							
1800	182	10 × 16	19	2000	10 × 20	13	2550	10 × 25	12	2800	
		▲ 8 × 20	16	1950				▲ 12.5 × 20	11	2800	
2200	222	10 × 20	13	2550							
		▲ 8 × 20	16	1950	10 × 25	12	2800				
2700	272	● 10 × 16	18	2000							
		10 × 20	13	2550	12.5 × 20	11	3000	12.5 × 25	10	2900	
3300	332	10 × 25	12	2800							
		▲ 12.5 × 20	11	3000	12.5 × 25	10	2900	16 × 25	9	3070	
5600	562	○ 10 × 20	13	2550							
		12.5 × 25	10	2900				18 × 25	8	3250	
6800	682				16 × 25	9	3070				
8200	822				18 × 25	8	3250				
12000	123	18 × 25	8	3250							

Please refer to page 20, 21, 22 about the formed or taped product spec.
Please refer to page 4 for the minimum order quantity.

- ▲ : In this case, [6] will be put at 12th digit of type numbering system.
- : In this case, [3] will be put at 12th digit of type numbering system.
- : In this case, [9] will be put at 12th digit of type numbering system.

CAT.8100Z