

INTERNAL THREADED END-CONNECTION LINEAR VALVE PN16

PRODUCT DATA



FEATURES

- Brass body with internal threaded end connections
- Low seat leakage rate
- Self-adjusting packing
- Accurate positioning to ensure state-of-the-art temperature control
- Directly-coupled electric actuators for easy mounting
- Constant total flow throughout full plug travel

SPECIFICATIONS

Action:	Stem up to close port A-AB
Nominal pressure rating:	PN16
Flow characteristic:	equal percentage: port A-AB linear: port B-AB
Rangeability:	50:1
Leakage rate:	≤0.05% of k_{vs}
Stroke:	20 mm
Valve body:	
Pipe connections:	Internal threading as per ISO228
Material:	Brass
Dimensions:	See Fig. 1 on page 2
Trim:	
Seat:	DN15: stainless steel DN20...50: body integrated
Plug:	Brass
Stem:	Stainless steel
Packing:	Spring-loaded carbon fiber reinforced PTFE V-rings
Medium temperature and pressure:	
Water	2 to 120 °C max. 1600 kPa 120 to 170 °C max. 1490 kPa
Max. temperature differential in alternating hot/cold water use:	60 K
Maximum glycol concentration	50%

APPLICATION

Single seated control or shut-off valve for:

- hot water;
- chilled water;;
- domestic hot water;

in heating, ventilation, air conditioning systems, and open circuits.

Operated by electric linear actuators (e.g. AL0620 and AL1820)

SIZES AND FLOW CAPACITIES

Table 1. Size and flow capacity (in m³/h)

Order Number	Valve size	k _{VS} m ³ /h
V163N-15-2.5	DN15	2.5
V163N-15-4.0	DN15	4
V163N-20-6.3	DN20	6.3
V163N-25-10	DN25	10
V163N-32-16	DN32	16
V163N-40-25	DN40	25
V163N-50-40	DN50	40

CLOSE-OFF PRESSURE RATINGS

Electric Actuators

Table 2. Close-off pressure ratings (in kPa) of electric actuators

actuator		valve size					
type	force	DN15	DN20	DN25	DN32	DN40	DN50
AL0620	600 N	1600	1600	1000	700	460	260
AL1820	1800 N	-	-	1600	1600	1500	850

DIMENSIONS

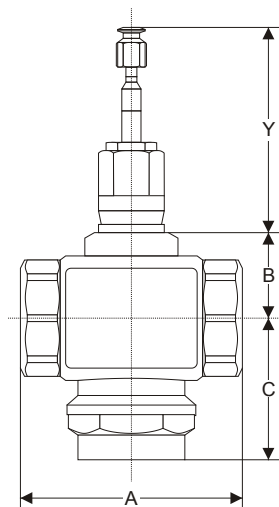

Fig. 1. Dimensions

Table 3. Dimensions (in mm)

valve size	A	B	C	Y
DN15	83	40	65	107
DN20	83		65	
DN25	103		66.5	
DN32	106		72.5	
DN40	120		77	
DN50	134		83.5	

For actuator dimensions, please refer to:

AL0620-24-x, -230-x	TA200898
AL0620-P-x.....	TA200900
AL1820-24-K, -230-K.....	TA200905
AL1820-P-K.....	TA200901

Please send any comments about this or any other Trend technical publication to techpubs@trendcontrols.com

© 2012 Honeywell Technologies Sàrl, ECC Division. All rights reserved. Manufactured for and on behalf of the Environmental and Combustion Controls Division of Honeywell Technologies Sàrl, Z.A. La Pièce, 16, 1180 Rolle, Switzerland by its Authorized Representative, Trend Control Systems Limited.

Trend Control Systems Limited reserves the right to revise this publication from time to time and make changes to the content hereof without obligation to notify any person of such revisions or changes.

Trend Control Systems Limited

Albery House, Springfield Road, Horsham, West Sussex, RH12 2PQ, UK. Tel:+44 (0)1403 211888 Fax:+44 (0)1403 241608 www.trendcontrols.com

Trend Control System USA

6670 185th Avenue NE, Redmond, Washington 98052, USA. Tel:(425) 869-3900 Fax:(425) 869-8445 www.trend-americas.com