

Kinetix VP Food Grade Motors



Kinetix VP (Bulletin VPF) food-grade motors combine the characteristics of the Bulletin VPL low-inertia servo motors with features specifically designed to meet the unique needs of many food and beverage applications. Windings are matched to Kinetix 5500 drive ratings to optimize system sizing, lower system cost, and improve energy efficiency. The Kinetix VP single-cable design between motor and drive simplifies installation. These high-performance servo motors address the challenges of food environments by incorporating food-grade paint and shaft seal, along with noncorrosive fasteners and stainless steel shaft.

Kinetix VP Low Inertia Motor Features

Attribute	Value
Main characteristics	<ul style="list-style-type: none"> Configurable winding options, brakes, and encoder feedback Developed to match Kinetix 5500 drive ratings for optimized system sizing Single cable technology Low rotor inertia
Features	<ul style="list-style-type: none"> Food-grade epoxy coated 200V and 400V-class windings High-energy rare-earth magnets Shaft end threaded hole SpeedTec DIN connector, rotates 315° Standard IEC 72-1 mounting dimensions
Motor type	Brushless AC synchronous servo motors
Environmental rating	<ul style="list-style-type: none"> IP66/IP67 with shaft seal (standard) and use of environmentally sealed cable connector Food grade grease on shaft seal
Certifications	Bulletin VPF rotary motors are UL Recognized components to applicable UL and CSA standards. CE marked for all applicable directives. Refer to http://www.ab.com for more information.
Continuous stall torque	0.93...19 N·m (8...172 lb·in)
Peak stall torque	2.69...49 N·m (24...430 lb·in)
Rated speed	Up to 8000 rpm
Motor rated output	0.34...4.18 kW (0.46...5.60 Hp)
Compatible servo drives	Kinetix 5500
Typical applications	<ul style="list-style-type: none"> Food packaging Volumetric filling Form, fill, seal Food handling For meat and poultry applications, the Kinetix VP stainless-steel motors are recommended

Catalog Numbers - Kinetix VP Food Grade Motors

Catalog numbers consist of various characters, each of which identifies a specific option for that component. Use the catalog numbering table chart below to understand the configuration of your motor. For questions regarding product availability, contact your Allen-Bradley distributor.

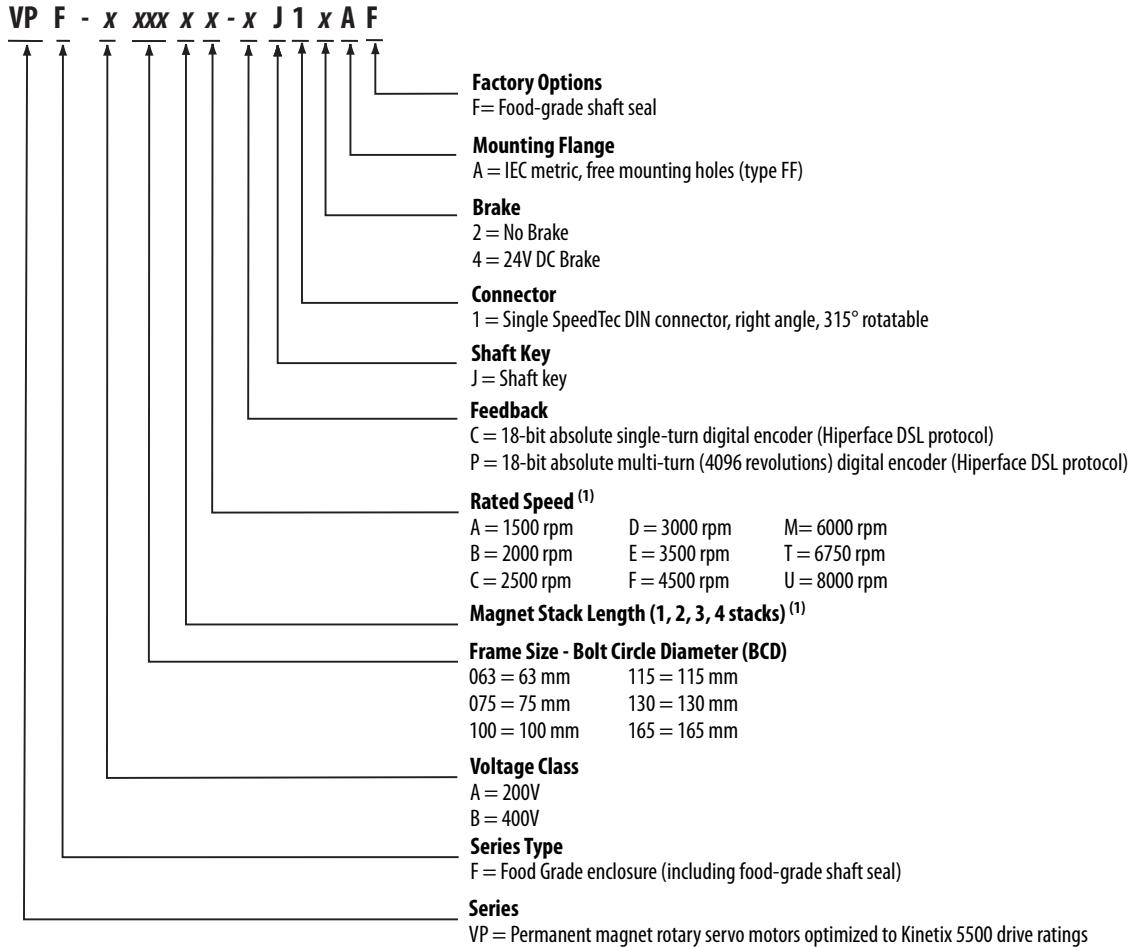

(1) Not all combinations are available. Only the configurations for rated speed and magnet stack length, as listed in Kinetix VP Food Grade Motor (200V-class) Performance Specifications on [page 28](#) and Kinetix VP Food Grade Motor (400V-class) Performance Specifications on [page 29](#), are available. Use Motion Analyzer software to size and select motors for your application.

Kinetix VP Single Cable Technology

Kinetix VP food-grade motors are available with high performance encoders with a choice of single-turn (-C) or multi-turn (-P) high resolution feedback:

- Motor connectivity reduced to a single connector and cable
 - Single cable eliminates hardware and wire terminations
 - Purely digital two-wire communication integrated into the motor power cable
 - Bulletin 2090 cables available in 1.0 m (3.2 ft) increments up to 50 m (164 ft)
- Up to 260 thousand counts per revolution (choice of single-turn or multi-turn) for smooth performance
 - Single-turn encoder provides high-resolution absolute position feedback within one turn
 - Multi-turn encoder provides high-resolution absolute position feedback within 4096 turns (electromechanical design does not require a battery)

IMPORTANT Due to the unique characteristics of single cable technology, designed for and tested with Kinetix 5500 drives and Kinetix VP motors, building your own cables or using third-party cable is not an option.

Motor Connector/Cable Compatibility

Kinetix VP (Bulletin VPF) motors are equipped with SpeedTec DIN connectors.

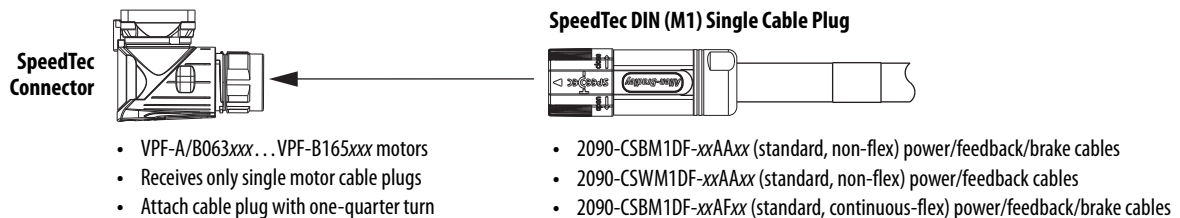

For 2090-Series single motor cable specifications, refer to Kinetix Motion Accessories Technical Data, publication [GMC-TD004](#).

Kinetix VP Food Grade Motor Options

Kinetix VP food-grade motors are available with these configurable options:

- Single-turn or multi-turn encoder.
- 24V DC brake.
- Positive Air Pressure kit (catalog number VPF-AIR-PURGE) is mounted on the feedback connector to provide positive air pressure to further reduce the chance of contamination inside the motor.

Refer to the Kinetix VP Food Grade Servo Motors Installation Instructions, publication [VPE-IN001](#), for more information.

- Shaft seal kits are food-grade, available for field replacement, and include a food-grade lubricant to reduce wear.

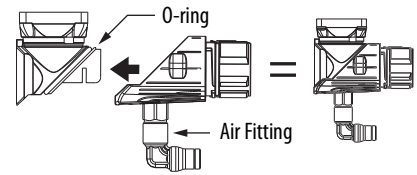

IMPORTANT Shaft seals are subject to wear and require periodic inspection and replacement. Replacement is recommended every 3 months, not to exceed 12 months, depending on use.

Shaft Seal Kit Catalog Numbers

Motor Cat. No.	Shaft Seal Kit Cat. No.	Shaft Seal Material
VPF-A063xx and VPF-B063xx	VPF-SSN-F063075	Teflon
VPF-A075xx and VPF-B075xx		
VPF-A100xx and VPF-B100xx	MPF-SSN-A3B3	PTFE
VPF-A115xx and VPF-B115xx	MPF-SSN-A4B4	
VPF-A130xx and VPF-B130xx	MPF-SSN-A45B45	
VPF-B165xx	MPF-SSN-F165	

Technical Specifications - Kinetix VP Food Grade Motors

Kinetix VP Food Grade Motor (200V-class) Performance Specifications

Motor Cat. No.	Rated Speed, max rpm	Continuous Stall Torque N·m (lb·in)	Peak Stall Torque N·m (lb·in)	Motor Rated Output kW (Hp)	Speed at Motor Rated Output rpm	Rotor Inertia ⁽¹⁾ kg·m ² (lb·in·s ²)	Motor Weight, ⁽¹⁾ approx kg (lb)
VPF-A0632F	4800	0.93 (8.0)	2.69 (24.0)	0.36 (0.48)	4800	1.70E-05 (0.00015)	1.36 (3.0)
VPF-A0633C	3000	1.27 (11.0)	4.09 (36.0)	0.37 (0.50)	3000	2.47E-05 (0.00022)	1.68 (3.70)
VPF-A0633F	4500	1.27 (11.0)	4.09 (36.0)	0.47 (0.63)	4500		
VPF-A0752C	3300	1.61 (14.0)	4.39 (39.0)	0.49 (0.66)	3300	2.50E-05 (0.00022)	2.03 (4.47)
VPF-A0752E	4800	1.61 (14.0)	4.39 (39.0)	0.63 (0.84)	4800		
VPF-A0753C	3300	2.16 (19.0)	7.02 (62.0)	0.59 (0.79)	3300	3.65E-05 (0.00032)	2.59 (5.70)
VPF-A0753E	4600	2.28 (20.0)	7.35 (65.0)	0.76 (1.02)	4600		
VPF-A1001C	2800	1.93 (17.0)	3.78 (33.0)	0.56 (0.75)	2800	4.4E-05 (0.00039)	2.63 (5.80)
VPF-A1001M	6500	1.95 (17.0)	3.78 (33.0)	1.29 (1.73)	6500		
VPF-A1002C	3000	3.39 (30.0)	7.82 (69.0)	1.03 (1.38)	3000	7.8E-05 (0.00069)	4.52 (9.95)
VPF-A1002F	5000	3.26 (29.0)	7.82 (69.0)	1.60 (2.14)	5000		
VPF-A1003C	2250	4.18 (37.0)	11.15 (99.0)	0.83 (1.11)	2250	1.2E-04 (0.0010)	4.45 (9.80)
VPF-A1003E	3750	4.18 (37.0)	11.15 (99.0)	1.25 (1.67)	3750		
VPF-A1003F	5500	4.18 (37.0)	11.15 (99.0)	1.81 (2.42)	5500		
VPF-A1153C	2300	6.50 (58.0)	20.33 (180)	1.16 (1.56)	2300	3.8E-04 (0.0033)	6.01 (13.23)
VPF-A1303B	1950	8.80 (78.0)	20.72 (183)	1.53 (2.05)	1950	4.0E-04 (0.0035)	7.54 (16.60)
VPF-A1303F	4000	7.75 (69.0)	20.72 (183)	2.25 (3.02)	4000		
VPF-A1304A	1600	10.29 (91.0)	28.45 (252)	1.47 (1.98)	1600	5.2E-04 (0.0046)	9.10 (20.05)
VPF-A1304D	3000	10.20 (90.0)	27.10 (240)	1.98 (2.65)	3000		

(1) Refer to Kinetix VP Food Grade Motor Brake Specifications on [page 30](#) for brake rotor inertia and brake motor weight.

Kinetix VP Food Grade Motor (400V-class) Performance Specifications

Motor Cat. No.	Rated Speed, max rpm	Continuous Stall Torque N·m (lb·in)	Peak Stall Torque N·m (lb·in)	Motor Rated Output kW (Hp)	Speed at Motor Rated Output rpm	Rotor Inertia ⁽¹⁾ kg·m ² (lb·in·s ²)	Motor Weight, ⁽¹⁾ approx kg (lb)
VPF-B0632F	4600	0.93 (8.0)	2.69 (24.0)	0.34 (0.46)	4600	1.70E-05 (0.00015)	1.36 (3.00)
VPF-B0632T	8000	0.93 (8.0)	2.69 (24.0)	0.41 (0.55)	7200		
VPF-B0633M	6700	1.27 (11.0)	4.09 (36.0)	0.49 (0.66)	6700	2.47E-05 (0.00022)	1.68 (3.70)
VPF-B0633T	8000	1.27 (11.0)	4.09 (36.0)	0.48 (0.64)	6000		
VPF-B0752E	4900	1.61 (14.0)	4.39 (39.0)	0.64 (0.86)	4900	2.50E-05 (0.00022)	2.03 (4.47)
VPF-B0752F	7000	1.61 (14.0)	4.39 (39.0)	0.76 (1.02)	7000		
VPF-B0752M	8000	1.61 (14.0)	4.39 (39.0)	0.77 (1.04)	8000		
VPF-B0753E	4500	2.28 (20.0)	7.35 (65.0)	0.77 (1.04)	4500	3.65E-05 (0.00032)	2.59 (5.70)
VPF-B0753F	6600	2.16 (19.0)	7.02 (62.0)	0.61 (0.82)	4500		
VPF-B0753M	8000	2.28 (20.0)	7.35 (65.0)	0.78 (1.05)	6000		
VPF-B1001M	6000	1.93 (17.0)	3.78 (34.0)	1.14 (1.53)	6000	4.4E-05 (0.00039)	2.63 (5.80)
VPF-B1002E	3300	3.39 (30.0)	7.82 (69.0)	1.12 (1.50)	3300	7.8E-05 (0.00069)	3.56 (7.85)
VPF-B1002M	6000	3.39 (30.0)	7.82 (69.0)	1.86 (2.49)	6000		
VPF-B1003C	2500	4.18 (37.0)	11.15 (99.0)	0.91 (1.23)	2500	1.2E-04 (0.0010)	4.45 (9.80)
VPF-B1003F	4750	4.18 (37.0)	11.15 (99.0)	1.57 (2.10)	4750		
VPF-B1003T	7000	4.18 (37.0)	11.15 (99.0)	1.68 (2.25)	7000		
VPF-B1153E	3200	6.50 (58.0)	20.33 (180)	1.40 (1.88)	3200	3.8E-04 (0.0033)	6.01 (13.23)
VPF-B1153F	5000	6.50 (58.0)	20.33 (180)	1.49 (2.00)	4000		
VPF-B1303C	2250	8.80 (78.0)	20.72 (183)	1.74 (2.33)	2250	4.0E-04 (0.0035)	7.54 (16.60)
VPF-B1303F	4000	8.80 (78.0)	20.72 (183)	2.54 (3.40)	4000		
VPF-B1304C	2150	10.29 (91.0)	28.45 (252)	1.49 (2.00)	2150	5.2E-04 (0.0046)	9.10 (20.05)
VPF-B1304E	3500	10.29 (91.0)	28.45 (252)	2.40 (3.21)	3500		
VPF-B1652C	2700	19.40 (172)	48.60 (430)	4.18 (5.60)	2700	1.47E-03 (0.013)	17.80 (39.24)

(1) Refer to MP-Series Low Inertia Motor Brake Specifications on [page 56](#) for brake rotor inertia and brake motor weight.

Kinetix VP Food Grade Motor Brake Specifications

Motor Cat. No.	Backlash, max (brake engaged) arc minutes	Holding Torque N·m (lb·in)	Coil Current at 24V DC A	Brake Response Time		Brake Rotor Inertia kg·m ² (lb·in·s ²)	Brake Motor Weight, approx kg (lb)
				Release ms	Engage ⁽¹⁾ ms		
VPF-A/B0632	30	1.50 (13)	0.297...0.363	38	25	1.94E-05 (0.00017)	1.70 (3.74)
VPF-A/B0633						2.71E-05 (0.00024)	2.02 (4.45)
VPF-A/B0752		3.0 (27)	0.567...0.693	66	42	2.97E-05 (0.00026)	2.62 (5.77)
VPF-A/B0753						4.12E-05 (0.00036)	3.18 (7.0)
VPF-A/B1001		4.18 (37)	0.45...0.55	90	65	5.9E-05 (0.00052)	3.26 (7.19)
VPF-A/B1002						9.3E-05 (0.00082)	4.20 (9.24)
VPF-A/B1003		6.55 (58)	0.621...0.759	90	95	1.35E-04 (0.0012)	5.08 (11.19)
VPF-A/B1153						4.09E-04 (0.0036)	6.88 (15.15)
VPF-A/B1303		14.10 (125)	0.738...0.902	125	120	4.33E-04 (0.0038)	8.64 (19.03)
VPF-A/B1304						5.53E-04 (0.0049)	10.21 (22.48)
VPF-B1652		32.0 (283)	1.053...1.287	140	120	1.53E-03 (0.013)	19.65 (43.32)

(1) By using diode and zener diode as arc suppression device in external control circuit.

Kinetix VP Food Grade Motor Load Force Ratings

Bulletin VPF motors are capable of operating with the maximum radial or maximum axial shaft loads listed in the following tables. Radial loads listed are applied in the middle of the shaft extension. The tables starting below represent an L₁₀ bearing fatigue life of 20,000 hours. This 20,000-hour life does not account for possible application-specific life reduction that can occur due to bearing grease contamination from external sources. Maximum operating speed is limited by motor winding.

VPF-xxxx-xJ1xAF Load Forces

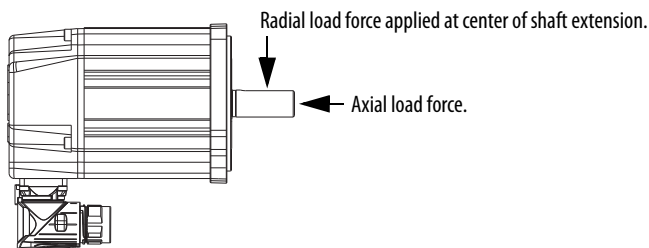

Kinetix VP Food Grade Motors (063...075 frame size)

Radial Load Force Ratings (maximum) for Non-brake Motors

Motor Cat. No. ⁽¹⁾	Rated Speed, max rpm	RPM														
		500 kgf	1000 kgf	1500 kgf	2000 kgf	2500 kgf	3000 kgf	3500 kgf	4000 kgf	4500 kgf	5000 kgf	6000 kgf	6500 kgf	7000 kgf	7500 kgf	8000 kgf
VPF-A0632F	4800	–	28.9	25.2	–	–	21.0 *	–	–	–	17.1 *	–	–	–	–	–
VPF-A0633C	3000	38.1	30.3	27.4 *	–	–	21.0	–	–	–	–	–	–	–	–	–
VPF-A0633F	4500	38.1	–	26.4	–	–	21.0	–	–	18.3	–	–	–	–	–	–
VPF-A0752C	3300	36.1	28.6	25.9 *	–	–	–	19.2 *	–	–	–	–	–	–	–	–
VPF-A0752E	4800	36.1	28.6	–	–	21.8 *	–	–	–	–	17.0 *	–	–	–	–	–
VPF-A0753C	3300	37.8	30.0	27.5 *	–	–	–	20.2 *	–	–	–	–	–	–	–	–
VPF-A0753E	4600	37.8	30.0	–	–	23.3 *	–	–	–	–	18.0 *	–	–	–	–	–
VPF-B0632F	4800	–	28.9	25.2	–	–	21.0 *	–	–	–	17.1 *	–	–	–	–	–
VPF-B0632T	8000	–	–	–	22.9	–	–	–	18.2	–	–	–	15.6 *	–	–	14.4
VPF-B0633M	6900	–	30.3	–	24.0	–	–	–	19.2 *	–	–	–	–	15.9 *	–	–
VPF-B0633T	8000	–	–	26.4	–	–	21.0	–	–	–	–	16.8 *	–	–	–	15.1
VPF-B0752E	4800	36.1	28.6	–	–	22.0 *	–	–	–	–	17.0 *	–	–	–	–	–
VPF-B0752F	7000	–	28.6	–	22.7	–	–	19.3 *	–	–	–	–	–	15.0	–	–
VPF-B0752M	8000	–	–	25.0	–	–	20.8	–	–	–	16.8 *	–	–	–	–	14.3
VPF-B0753E	4500	37.8	30.0	–	23.8	–	–	–	–	18.2	–	–	–	–	–	–
VPF-B0753F	6500	–	30.0	–	23.8	–	–	20.6 *	–	–	–	–	16.1	–	–	–
VPF-B0753M	8000	–	–	26.2	–	–	19.8	–	–	–	18.0 *	–	–	–	–	15.0

(1) 1.0 kgf = 2.2 lbf or 9.8 N. An asterisk (*) indicates a load rating measured at an rpm value that is less than the value listed for that column.

Axial Load Force Ratings (maximum radial load) for Non-brake Motors

Motor Cat. No. (1)	Rated Speed, max rpm	RPM														
		500 kgf	1000 kgf	1500 kgf	2000 kgf	2500 kgf	3000 kgf	3500 kgf	4000 kgf	4500 kgf	5000 kgf	6000 kgf	6500 kgf	7000 kgf	7500 kgf	8000 kgf
VPF-A0632F	4800	–	23.5	19.7	–	–	15.5 *	–	–	–	11.9 *	–	–	–	–	–
VPF-A0633C	3000	32.7	24.2	21.3 *	–	–	15.0	–	–	–	–	–	–	–	–	–
VPF-A0633F	4500	32.7	–	20.3	–	–	15.0	–	–	12.6	–	–	–	–	–	–
VPF-A0752C	3300	31.5	23.3	20.5 *	–	–	–	13.9 *	–	–	–	–	–	–	–	–
VPF-A0752E	4800	31.5	23.3	–	–	16.4 *	–	–	–	–	11.8 *	–	–	–	–	–
VPF-A0753C	3300	32.5	24.1	21.5 *	–	–	–	14.3 *	–	–	–	–	–	–	–	–
VPF-A0753E	4600	32.5	24.1	–	–	17.3 *	–	–	–	–	12.4 *	–	–	–	–	–
VPF-B0632F	4800	–	23.5	19.7	–	–	15.5 *	–	–	–	11.9 *	–	–	–	–	–
VPF-B0632T	8000	–	–	–	17.4	–	–	–	12.9	–	–	–	10.6	–	–	9.5
VPF-B0633M	6900	–	24.2	–	17.9	–	–	–	13.4 *	–	–	–	–	10.5 *	–	–
VPF-B0633T	8000	–	–	20.3	–	–	15.0	–	–	–	–	11.3 *	–	–	–	9.8
VPF-B0752E	4800	31.5	23.3	–	–	16.6 *	–	–	–	–	11.8 *	–	–	–	–	–
VPF-B0752F	7000	–	23.3	–	17.3	–	–	–	14.0 *	–	–	–	–	–	10.0	–
VPF-B0752M	8000	–	–	19.6	–	–	14.5	–	–	–	11.7 *	–	–	–	–	9.5
VPF-B0753E	4500	32.5	24.1	–	17.8	–	–	–	–	12.5	–	–	–	–	–	–
VPF-B0753F	6500	–	24.1	–	17.8	–	–	–	14.7 *	–	–	–	–	10.7	–	–
VPF-B0753M	8000	–	–	20.2	–	–	14.9	–	–	–	12.4 *	–	–	–	–	9.8

(1) 1.0 kgf = 2.2 lbf or 9.8 N. An asterisk (*) indicates a load rating measured at an rpm value that is less than the value listed for that column.

Axial Load Force Ratings (zero radial load) for Non-brake Motors

Motor Cat. No. (1)	Rated Speed, max rpm	RPM														
		500 kgf	1000 kgf	1500 kgf	2000 kgf	2500 kgf	3000 kgf	3500 kgf	4000 kgf	4500 kgf	5000 kgf	6000 kgf	6500 kgf	7000 kgf	7500 kgf	8000 kgf
VPF-A0632F	4800	–	27.5	23.0	–	–	18.1 *	–	–	–	13.9 *	–	–	–	–	–
VPF-A0633C	3000	37.1	27.5	24.1 *	–	–	17.1	–	–	–	–	–	–	–	–	–
VPF-A0633F	4500	37.1	–	23.0	–	–	17.1	–	–	14.3	–	–	–	–	–	–
VPF-A0752C	3300	37.1	27.5	24.1 *	–	–	–	16.4 *	–	–	–	–	–	–	–	–
VPF-A0752E	4800	37.1	27.5	–	–	19.3 *	–	–	–	–	13.9 *	–	–	–	–	–
VPF-A0753C	3300	37.1	27.5	24.5 *	–	–	–	16.4 *	–	–	–	–	–	–	–	–
VPF-A0753E	4600	37.1	27.5	–	–	19.7 *	–	–	–	–	14.2 *	–	–	–	–	–
VPF-B0632F	4800	–	27.5	23.0	–	–	18.1 *	–	–	–	13.9 *	–	–	–	–	–
VPF-B0632T	8000	–	–	–	20.3	–	–	–	15.1	–	–	–	12.4 *	–	–	11.1
VPF-B0633M	6900	–	27.5	–	20.3	–	–	–	15.2 *	–	–	–	–	11.9 *	–	–
VPF-B0633T	8000	–	–	23.0	–	–	17.1	–	–	–	–	12.8 *	–	–	–	11.1
VPF-B0752E	4800	37.1	27.5	–	–	19.5 *	–	–	–	–	13.9 *	–	–	–	–	–
VPF-B0752F	7000	–	27.5	–	20.3	–	–	–	16.5 *	–	–	–	–	–	11.8	–
VPF-B0752M	8000	–	–	23.0	–	–	17.1	–	–	–	13.8 *	–	–	–	–	11.1
VPF-B0753E	4500	37.1	27.5	–	20.3	–	–	–	–	14.3	–	–	–	–	–	–
VPF-B0753F	6500	–	27.5	–	20.3	–	–	–	16.8 *	–	–	–	–	12.2	–	–
VPF-B0753M	8000	–	–	23.0	–	–	17.1	–	–	–	14.2 *	–	–	–	–	11.1

(1) 1.0 kgf = 2.2 lbf or 9.8 N. An asterisk (*) indicates a load rating measured at an rpm value that is less than the value listed for that column.

Radial Load Force Ratings (maximum) for Brake Motors

Motor Cat. No. (1)	Rated Speed, max rpm	RPM														
		500 kgf	1000 kgf	1500 kgf	2000 kgf	2500 kgf	3000 kgf	3500 kgf	4000 kgf	4500 kgf	5000 kgf	6000 kgf	6500 kgf	7000 kgf	7500 kgf	8000 kgf
VPF-A0632F	4800	–	30.5	26.6	–	–	22.2 *	–	–	–	18.1 *	–	–	–	–	–
VPF-A0633C	3000	39.5	31.4	28.4 *	–	–	21.8	–	–	–	–	–	–	–	–	–
VPF-A0633F	4500	39.5	–	27.4	–	–	21.8	–	–	19.0	–	–	–	–	–	–
VPF-A0752C	3300	38.1	30.3	27.4	–	–	–	20.3 *	–	–	–	–	–	–	–	–
VPF-A0752E	4800	38.1	30.3	–	–	23.1 *	–	–	–	–	17.9 *	–	–	–	–	–
VPF-A0753C	3300	39.2	31.2	28.5 *	–	–	–	20.9 *	–	–	–	–	–	–	–	–
VPF-A0753E	4600	39.2	31.2	–	–	24.1 *	–	–	–	–	18.7 *	–	–	–	–	–
VPF-B0632F	4800	–	30.5	26.6	–	–	22.2 *	–	–	–	18.1 *	–	–	–	–	–
VPF-B0632T	8000	–	–	–	24.2	–	–	–	19.2	–	–	–	16.5 *	–	–	15.3
VPF-B0633M	6900	–	31.4	–	24.9	–	–	–	19.9 *	–	–	–	–	16.5 *	–	–
VPF-B0633T	8000	–	–	27.4	–	–	21.8	–	–	–	–	17.5 *	–	–	–	15.7
VPF-B0752E	4800	38.1	30.3	–	–	23.3 *	–	–	–	–	17.9 *	–	–	–	–	–
VPF-B0752F	7000	–	30.3	–	24.0	–	–	–	20.4 *	–	–	–	–	–	15.8	–
VPF-B0752M	8000	–	–	26.4	–	–	21.0	–	–	–	17.8 *	–	–	–	–	15.1
VPF-B0753E	4500	39.2	31.2	–	24.7	–	–	–	–	18.9	–	–	–	–	–	–
VPF-B0753F	6500	–	31.2	–	24.7	–	–	–	21.4 *	–	–	–	–	16.7	–	–
VPF-B0753M	8000	–	–	27.2	–	–	21.6	–	–	–	18.7 *	–	–	–	–	15.6

(1) 1.0 kgf = 2.2 lbf or 9.8 N. An asterisk (*) indicates a load rating measured at an rpm value that is less than the value listed for that column.

Axial Load Force Ratings (maximum radial load) for Brake Motors

Motor Cat. No. (1)	Rated Speed, max rpm	RPM														
		500 kgf	1000 kgf	1500 kgf	2000 kgf	2500 kgf	3000 kgf	3500 kgf	4000 kgf	4500 kgf	5000 kgf	6000 kgf	6500 kgf	7000 kgf	7500 kgf	8000 kgf
VPF-A0632F	4800	–	24.3	20.4	–	–	16.1 *	–	–	–	12.3 *	–	–	–	–	–
VPF-A0633C	3000	33.5	24.8	21.8 *	–	–	15.4	–	–	–	–	–	–	–	–	–
VPF-A0633F	4500	33.5	–	20.8	–	–	15.4	–	–	12.9	–	–	–	–	–	–
VPF-A0752C	3300	32.7	24.2	21.3 *	–	–	–	14.4 *	–	–	–	–	–	–	–	–
VPF-A0752E	4800	32.7	24.2	–	–	17.0 *	–	–	–	–	12.3 *	–	–	–	–	–
VPF-A0753C	3300	33.4	24.7	22.0 *	–	–	–	14.7 *	–	–	–	–	–	–	–	–
VPF-A0753E	4600	33.4	24.7	–	–	17.7 *	–	–	–	–	12.7 *	–	–	–	–	–
VPF-B0632F	4800	–	24.3	20.4	–	–	16.1 *	–	–	–	12.3 *	–	–	–	–	–
VPF-B0632T	8000	–	–	–	18.0	–	–	–	13.3	–	–	–	11.0 *	–	–	9.9
VPF-B0633M	6900	–	24.8	–	18.4	–	–	–	13.7 *	–	–	–	–	10.7 *	–	–
VPF-B0633T	8000	–	–	20.8	–	–	15.4	–	–	–	–	11.6 *	–	–	–	10.1
VPF-B0752E	4800	32.7	24.2	–	–	17.2 *	–	–	–	–	12.3 *	–	–	–	–	–
VPF-B0752F	7000	–	24.2	–	17.9	–	–	–	14.5 *	–	–	–	–	–	10.4	–
VPF-B0752M	8000	–	–	20.3	–	–	15.0	–	–	–	12.1 *	–	–	–	–	9.8
VPF-B0753E	4500	33.4	24.7	–	18.3	–	–	–	–	12.9	–	–	–	–	–	–
VPF-B0753F	6500	–	24.7	–	18.3	–	–	–	15.1 *	–	–	–	–	11.0	–	–
VPF-B0753M	8000	–	–	20.7	–	–	15.3	–	–	–	12.7 *	–	–	–	–	10.0

(1) 1.0 kgf = 2.2 lbf or 9.8 N. An asterisk (*) indicates a load rating measured at an rpm value that is less than the value listed for that column.

Axial Load Force Ratings (zero radial load) for Brake Motors

Motor Cat. No. ⁽¹⁾	Rated Speed, max rpm	RPM														
		500 kgf	1000 kgf	1500 kgf	2000 kgf	2500 kgf	3000 kgf	3500 kgf	4000 kgf	4500 kgf	5000 kgf	6000 kgf	6500 kgf	7000 kgf	7500 kgf	8000 kgf
VPF-A0632F	4800	–	27.5	23.0	–	–	18.1 *	–	–	–	13.9 *	–	–	–	–	–
VPF-A0633C	3000	37.1	27.5	24.1 *	–	–	17.1	–	–	–	–	–	–	–	–	–
VPF-A0633F	4500	37.1	–	23.0	–	–	17.1	–	–	14.3	–	–	–	–	–	–
VPF-A0752C	3300	37.1	27.5	24.1 *	–	–	–	16.4 *	–	–	–	–	–	–	–	–
VPF-A0752E	4800	37.1	27.5	–	–	19.3 *	–	–	–	–	13.9 *	–	–	–	–	–
VPF-A0753C	3300	37.1	27.5	24.5 *	–	–	–	16.4 *	–	–	–	–	–	–	–	–
VPF-A0753E	4600	37.1	27.5	–	–	19.7 *	–	–	–	–	14.2 *	–	–	–	–	–
VPF-B0632F	4800	–	27.5	23.0	–	–	18.1 *	–	–	–	13.9 *	–	–	–	–	–
VPF-B0632T	8000	–	–	–	20.3	–	–	–	15.1	–	–	–	12.4 *	–	–	11.1
VPF-B0633M	6900	–	27.5	–	20.3	–	–	–	15.2 *	–	–	–	–	11.9 *	–	–
VPF-B0633T	8000	–	–	23.0	–	–	17.1	–	–	–	–	12.8 *	–	–	–	11.1
VPF-B0752E	4800	37.1	27.5	–	–	19.5 *	–	–	–	–	13.9 *	–	–	–	–	–
VPF-B0752F	7000	–	27.5	–	20.3	–	–	16.5 *	–	–	–	–	–	11.8	–	–
VPF-B0752M	8000	–	–	23.0	–	–	17.1	–	–	–	13.8 *	–	–	–	–	11.1
VPF-B0753E	4500	37.1	27.5	–	20.3	–	–	–	–	14.3	–	–	–	–	–	–
VPF-B0753F	6500	–	27.5	–	20.3	–	–	16.8 *	–	–	–	–	12.2	–	–	–
VPF-B0753M	8000	–	–	23.0	–	–	17.1	–	–	–	14.2 *	–	–	–	–	11.1

(1) 1.0 kgf = 2.2 lbf or 9.8 N. An asterisk (*) indicates a load rating measured at an rpm value that is less than the value listed for that column.

Kinetix VP Food Grade Motors (100... 165 frame size)

Radial Load Force Ratings (maximum) for Non-brake Motors

Motor Cat. No. ⁽¹⁾	Rated Speed, max rpm	RPM														
		500 kgf	750 kgf	1000 kgf	1500 kgf	2000 kgf	2500 kgf	3000 kgf	3500 kgf	4000 kgf	4500 kgf	5000 kgf	5500 kgf	6000 kgf	6500 kgf	7000 kgf
VPF-A1001C	2800	79.1	–	62.8	–	49.8	–	44.6 *	–	–	–	–	–	–	–	–
VPF-A1001M	6500	–	–	–	54.9	–	46.3	–	–	–	38.0	–	–	–	33.6	–
VPF-A1002C	3000	87.9	–	69.7	–	55.4	–	48.4	–	–	–	–	–	–	–	–
VPF-A1002F	5000	–	–	69.7	60.9	–	–	48.4	–	–	–	40.8	–	–	–	–
VPF-A1003C	2250	93.6	–	74.3	64.9	–	56.7 *	–	–	–	–	–	–	–	–	–
VPF-A1003E	3750	93.6	–	74.3	–	59.0	–	–	–	47.8 *	–	–	–	–	–	–
VPF-A1003F	5500	–	–	–	64.9	–	54.8	–	–	46.8	–	–	42.1	–	–	–
VPF-A1153C	2300	106.4	–	84.5	73.8	–	64.0 *	–	–	–	–	–	–	–	–	–
VPF-A1303B	1950	132.9	–	105.5	92.2	84.4 *	–	–	–	–	–	–	–	–	–	–
VPF-A1303F	4000	–	–	105.5	–	83.7	–	73.1	–	66.5	–	–	–	–	–	–
VPF-A1304A	1600	140.2	122.5	112.2 *	–	95.2 *	–	–	–	–	–	–	–	–	–	–
VPF-A1304D	3000	140.2	–	111.3	–	88.3	–	77.2	–	–	–	–	–	–	–	–
VPF-B1001M	6000	–	–	–	–	49.8	–	43.5	–	39.6	–	–	–	34.6	–	–
VPF-B1002E	3300	87.9	–	69.7	–	55.4	–	–	46.8 *	–	–	–	–	–	–	–
VPF-B1002M	6000	–	–	–	60.9	–	–	48.4	–	–	42.2	–	–	38.4	–	–
VPF-B1003C	2500	93.6	–	74.3	64.9	–	54.8	–	–	–	–	–	–	–	–	–
VPF-B1003F	4750	–	–	74.3	64.9	–	–	51.5	–	–	–	44.2 *	–	–	–	–
VPF-B1003T	7000	–	–	–	64.9	–	54.8	–	–	–	45.0	–	–	–	–	38.9
VPF-B1153E	3200	106.4	–	84.5	–	67.0	–	–	57.3 *	–	–	–	–	–	–	–
VPF-B1153F	5000	–	–	84.5	–	67.0	–	58.6	–	–	–	49.4	–	–	–	–
VPF-B1303C	2250	132.9	–	105.5	92.2	–	80.5 *	–	–	–	–	–	–	–	–	–
VPF-B1303F	4000	–	–	105.5	–	83.7	–	74.0 *	–	66.5	–	–	–	–	–	–
VPF-B1304C	2150	140.2	–	111.3	99.5 *	–	86.2 *	–	–	–	–	–	–	–	–	–
VPF-B1304E	3500	–	–	111.3	97.2	–	84.3 *	–	73.3	–	–	–	–	–	–	–
VPF-B1652C	2700	180.7	–	143.4	125.3	–	–	103.0 *	–	–	–	–	–	–	–	–

(1) 1.0 kgf = 2.2 lbf or 9.8 N. An asterisk (*) indicates a load rating measured at an rpm value that is less than the value listed for that column.

Axial Load Force Ratings (maximum radial load) for Non-brake Motors

Motor Cat. No. (1)	Rated Speed, max rpm	RPM														
		500 kgf	750 kgf	1000 kgf	1500 kgf	2000 kgf	2500 kgf	3000 kgf	3500 kgf	4000 kgf	4500 kgf	5000 kgf	5500 kgf	6000 kgf	6500 kgf	7000 kgf
VPF-A1001C	2800	25.0	–	19.0	–	10.0	–	10.0*	–	–	–	–	–	–	–	–
VPF-A1001M	6500	–	–	–	15.0	–	12.0	–	–	–	9.0	–	–	–	8.0	–
VPF-A1002C	3000	30.0	–	22.0	–	16.0	–	13.0	–	–	–	–	–	–	–	–
VPF-A1002F	5000	–	–	22.0	18.0	–	–	13.0	–	–	–	11.0	–	–	–	–
VPF-A1003C	2250	33.0	–	24.0	20.0	–	17.0*	–	–	–	–	–	–	–	–	–
VPF-A1003E	3750	33.0	–	24.0	–	18.0	–	–	–	13.0*	–	–	–	–	–	–
VPF-A1003F	5500	–	–	–	20.0	–	16.0	–	–	13.0	–	–	11.0	–	–	–
VPF-A1153C	2300	48.0	–	35.0	29.0	–	24.0*	–	–	–	–	–	–	–	–	–
VPF-A1303B	1950	39.0	–	29.0	24.0	22.0*	–	–	–	–	–	–	–	–	–	–
VPF-A1303F	4000	–	–	29.0	–	21.0	–	18.0	–	16.0	–	–	–	–	–	–
VPF-A1304A	1600	43.0	36.0	32.0*	–	26.0*	–	–	–	–	–	–	–	–	–	–
VPF-A1304D	3000	43.0	–	32.0	–	23.0	–	20.0	–	–	–	–	–	–	–	–
VPF-B1001M	6000	–	–	–	–	14.0	–	11.0	–	10.0	–	–	–	8.0	–	–
VPF-B1002E	3300	30.0	–	22.0	–	16.0	–	–	13.0*	–	–	–	–	–	–	–
VPF-B1002M	6000	–	–	–	18.0	–	–	13.0	–	–	11.0	–	–	10.0	–	–
VPF-B1003C	2500	33.0	–	24.0	20.0	–	16.0	–	–	–	–	–	–	–	–	–
VPF-B1003F	4750	–	–	24.0	20.0	–	–	15.0	–	–	–	12.0*	–	–	–	–
VPF-B1003T	7000	–	–	–	20.0	–	16.0	–	–	–	12.0	–	–	–	–	10.0
VPF-B1153E	3200	48.0	–	35.0	–	26.0	–	–	21.0*	–	–	–	–	–	–	–
VPF-B1153F	5000	–	–	35.0	–	26.0	–	22.0	–	–	–	17.0	–	–	–	–
VPF-B1303C	2250	39.0	–	29.0	–	24.0	20.0*	–	–	–	–	–	–	–	–	–
VPF-B1303F	4000	–	–	29.0	–	21.0	–	18.0*	–	16.0	–	–	–	–	–	–
VPF-B1304C	2150	43.0	–	32.0	27.0*	–	23.0*	–	–	–	–	–	–	–	–	–
VPF-B1304E	3500	–	–	32.0	27.0	–	22.0*	–	18.0	–	–	–	–	–	–	–
VPF-B1652C	2700	58.0	–	43.0	36.0	–	–	27.0*	–	–	–	–	–	–	–	–

(1) 1.0 kgf = 2.2 lbf or 9.8 N. An asterisk (*) indicates a load rating measured at an rpm value that is less than the value listed for that column.

Axial Load Force Ratings (zero radial load) for Non-brake Motors

Motor Cat. No. (1)	Rated Speed, max rpm	RPM														
		500 kgf	750 kgf	1000 kgf	1500 kgf	2000 kgf	2500 kgf	3000 kgf	3500 kgf	4000 kgf	4500 kgf	5000 kgf	5500 kgf	6000 kgf	6500 kgf	7000 kgf
VPF-A1001C	2800	49.4	–	36.5	–	27.0	–	23.4 *	–	–	–	–	–	–	–	–
VPF-A1001M	6500	–	–	–	30.6	–	24.5	–	–	–	19.0	–	–	–	16.2	–
VPF-A1002C	3000	49.4	–	36.5	–	27.0	–	22.7	–	–	–	–	–	–	–	–
VPF-A1002F	5000	–	–	36.5	30.6	–	–	22.7	–	–	–	18.2	–	–	–	–
VPF-A1003C	2250	49.4	–	36.5	30.6	–	25.7 *	–	–	–	–	–	–	–	–	–
VPF-A1003E	3750	49.4	–	36.5	–	27.0	–	–	–	20.6 *	–	–	–	–	–	–
VPF-A1003F	5500	–	–	–	30.6	–	24.5	–	–	20.0	–	–	17.4	–	–	–
VPF-A1153C	2300	68.3	–	50.5	42.4	–	35.2 *	–	–	–	–	–	–	–	–	–
VPF-A1303B	1950	68.3	–	50.5	42.4	37.8 *	–	–	–	–	–	–	–	–	–	–
VPF-A1303F	4000	–	–	50.5	–	37.4	–	31.4	–	27.7	–	–	–	–	–	–
VPF-A1304A	1600	68.3	57.2	51.1 *	–	41.2 *	–	–	–	–	–	–	–	–	–	–
VPF-A1304D	3000	68.3	–	50.5	–	37.4	–	31.4	–	–	–	–	–	–	–	–
VPF-B1001M	6000	–	–	–	–	27.0	–	22.7	–	20.0	–	–	–	16.8	–	–
VPF-B1002E	3300	49.4	–	36.5	–	27.0	–	–	21.8 *	–	–	–	–	–	–	–
VPF-B1002M	6000	–	–	–	30.6	–	–	22.7	–	–	19.0	–	–	16.8	–	–
VPF-B1003C	2500	49.4	–	36.5	30.6	–	24.5	–	–	–	–	–	–	–	–	–
VPF-B1003F	4750	–	–	36.5	30.6	–	–	22.7	–	–	–	18.6 *	–	–	–	–
VPF-B1003T	7000	–	–	–	30.6	–	24.5	–	–	–	19.0	–	–	–	–	15.7
VPF-B1153E	3200	68.3	–	50.5	–	37.4	–	–	30.5 *	–	–	–	–	–	–	–
VPF-B1153F	5000	–	–	50.5	–	37.4	–	31.4	–	–	–	25.1	–	–	–	–
VPF-B1303C	2250	68.3	–	50.5	42.3	–	35.5 *	–	–	–	–	–	–	–	–	–
VPF-B1303F	4000	–	–	50.5	–	37.4	–	31.8 *	–	27.7	–	–	–	–	–	–
VPF-B1304C	2150	68.3	–	50.5	43.6 *	–	36.2 *	–	–	–	–	–	–	–	–	–
VPF-B1304E	3500	–	–	50.5	42.4	–	35.2 *	–	29.3	–	–	–	–	–	–	–
VPF-B1652C	2700	90.1	–	66.7	55.9	–	–	43.3 *	–	–	–	–	–	–	–	–

(1) 1.0 kgf = 2.2 lbf or 9.8 N. An asterisk (*) indicates a load rating measured at an rpm value that is less than the value listed for that column.

Radial Load Force Ratings (maximum) for Brake Motors

Motor Cat. No. (1)	Rated Speed, max rpm	RPM														
		500 kgf	750 kgf	1000 kgf	1500 kgf	2000 kgf	2500 kgf	3000 kgf	3500 kgf	4000 kgf	4500 kgf	5000 kgf	5500 kgf	6000 kgf	6500 kgf	7000 kgf
VPF-A1001C	2800	90.2	–	71.6	–	56.8	–	50.8*	–	–	–	–	–	–	–	–
VPF-A1001M	6500	–	–	–	62.5	–	52.7	–	–	–	43.4	–	–	–	38.4	–
VPF-A1002C	3000	95.3	–	75.6	–	60.0	–	52.4	–	–	–	–	–	–	–	–
VPF-A1002F	5000	–	–	75.6	66.1	–	–	52.4	–	–	–	44.2	–	–	–	–
VPF-A1003C	2250	99.0	–	78.5	68.6	–	59.9*	–	–	–	–	–	–	–	–	–
VPF-A1003E	3750	99.0	–	78.5	–	62.3	–	–	–	50.6*	–	–	–	–	–	–
VPF-A1003F	5500	–	–	–	68.6	–	57.9	–	–	49.5	–	–	44.5	–	–	–
VPF-A1153C	2300	115.4	–	91.6	80.0	–	69.4*	–	–	–	–	–	–	–	–	–
VPF-A1303B	1950	145.3	–	115.3	100.7	92.3*	–	–	–	–	–	–	–	–	–	–
VPF-A1303F	4000	–	–	115.3	–	91.5	–	80.0	–	72.7	–	–	–	–	–	–
VPF-A1304A	1600	149.7	130.8	119.8*	–	101.6*	–	–	–	–	–	–	–	–	–	–
VPF-A1304D	3000	149.5	–	118.6	–	94.2	–	82.3	–	–	–	–	–	–	–	–
VPF-B1001M	6000	–	–	–	–	56.8	–	49.6	–	45.1	–	–	–	39.4	–	–
VPF-B1002E	3300	95.3	–	75.6	–	60.0	–	–	50.8*	–	–	–	–	–	–	–
VPF-B1002M	6000	–	–	–	66.1	–	–	52.4	–	–	45.8	–	–	41.6	–	–
VPF-B1003C	2500	99.0	–	78.5	68.6	–	57.9	–	–	–	–	–	–	–	–	–
VPF-B1003F	4750	–	–	78.5	68.6	–	–	54.5	–	–	–	46.7*	–	–	–	–
VPF-B1003T	7000	–	–	–	68.6	–	57.9	–	–	–	47.6	–	–	–	–	41.1
VPF-B1153E	3200	115.4	–	91.6	–	72.7	–	–	62.2*	–	–	–	–	–	–	–
VPF-B1153F	5000	–	–	91.6	–	72.7	–	63.5	–	–	–	53.6	–	–	–	–
VPF-B1303C	2250	145.3	–	115.3	100.7	–	88.0*	–	–	–	–	–	–	–	–	–
VPF-B1303F	4000	–	–	115.3	–	91.5	–	80.9*	–	72.7	–	–	–	–	–	–
VPF-B1304C	2150	149.7	–	118.8	106.2*	–	92.0*	–	–	–	–	–	–	–	–	–
VPF-B1304E	3500	–	–	118.8	103.8	–	90.0*	–	78.2	–	–	–	–	–	–	–
VPF-B1652C	2700	192.5	–	152.8	133.5	–	–	109.7*	–	–	–	–	–	–	–	–

(1) 1.0 kgf = 2.2 lbf or 9.8 N. An asterisk (*) indicates a load rating measured at an rpm value that is less than the value listed for that column.

Axial Load Force Ratings (maximum radial load) for Brake Motors

Motor Cat. No. ⁽¹⁾	Rated Speed, max rpm	RPM														
		500 kgf	750 kgf	1000 kgf	1500 kgf	2000 kgf	2500 kgf	3000 kgf	3500 kgf	4000 kgf	4500 kgf	5000 kgf	5500 kgf	6000 kgf	6500 kgf	7000 kgf
VPF-A1001C	2800	31.0	–	23.0	–	17.0	–	14.0*	–	–	–	–	–	–	–	–
VPF-A1001M	6500	–	–	–	19.0	–	15.0	–	–	–	12.0	–	–	–	10.0	–
VPF-A1002C	3000	34.0	–	25.0	–	18.0	–	15.0	–	–	–	–	–	–	–	–
VPF-A1002F	5000	–	–	25.0	21.0	–	–	15.0	–	–	–	12.0	–	–	–	–
VPF-A1003C	2250	36.0	–	26.0	22.0	–	18.0*	–	–	–	–	–	–	–	–	–
VPF-A1003E	3750	36.0	–	26.0	–	19.0	–	–	–	15.0*	–	–	–	–	–	–
VPF-A1003F	5500	–	–	–	22.0	–	18.0	–	–	14.0	–	–	12.0	–	–	–
VPF-A1153C	2300	53.0	–	39.0	32.0	–	27.0*	–	–	–	–	–	–	–	–	–
VPF-A1303B	1950	46.0	–	34.0	28.0	25.0*	–	–	–	–	–	–	–	–	–	–
VPF-A1303F	4000	–	–	34.0	–	25.0	–	21.0	–	18.0	–	–	–	–	–	–
VPF-A1304A	1600	48.0	40.0	36.0*	–	29.0*	–	–	–	–	–	–	–	–	–	–
VPF-A1304D	3000	48.0	–	36.0	–	26.0	–	22.0	–	–	–	–	–	–	–	–
VPF-B1001M	6000	–	–	–	–	17.0	–	14.0	–	12.0	–	–	–	10.0	–	–
VPF-B1002E	3300	34.0	–	25.0	–	18.0	–	–	15.0*	–	–	–	–	–	–	–
VPF-B1002M	6000	–	–	–	21.0	–	–	15.0	–	–	13.0	–	–	11.0	–	–
VPF-B1003C	2500	36.0	–	26.0	22.0	–	18.0	–	–	–	–	–	–	–	–	–
VPF-B1003F	4750	–	–	26.0	22.0	–	–	16.0	–	–	–	13.0*	–	–	–	–
VPF-B1003T	7000	–	–	–	22.0	–	18.0	–	–	–	13.0	–	–	–	–	11.0
VPF-B1153E	3200	53.0	–	39.0	–	29.0	–	–	23.0*	–	–	–	–	–	–	–
VPF-B1153F	5000	–	–	39.0	–	29.0	–	24.0	–	–	–	19.0	–	–	–	–
VPF-B1303C	2250	46.0	–	34.0	28.0	–	24.0*	–	–	–	–	–	–	–	–	–
VPF-B1303F	4000	–	–	34.0	–	25.0	–	21.0*	–	18.0	–	–	–	–	–	–
VPF-B1304C	2150	48.0	–	36.0	31.0*	–	25.0*	–	–	–	–	–	–	–	–	–
VPF-B1304E	3500	–	–	36.0	30.0	–	25.0*	–	20.0	–	–	–	–	–	–	–
VPF-B1652C	2700	64.0	–	47.0	39.0	–	–	30.0*	–	–	–	–	–	–	–	–

(1) 1.0 kgf = 2.2 lbf or 9.8 N. An asterisk (*) indicates a load rating measured at an rpm value that is less than the value listed for that column.

Axial Load Force Ratings (zero radial load) for Brake Motors

Motor Cat. No. (1)	Rated Speed, max rpm	RPM														
		500 kgf	750 kgf	1000 kgf	1500 kgf	2000 kgf	2500 kgf	3000 kgf	3500 kgf	4000 kgf	4500 kgf	5000 kgf	5500 kgf	6000 kgf	6500 kgf	7000 kgf
VPF-A1001C	2800	49.4	–	36.5	–	27.0	–	23.4 *	–	–	–	–	–	–	–	–
VPF-A1001M	6500	–	–	–	30.6	–	24.5	–	–	–	19.0	–	–	–	16.2	–
VPF-A1002C	3000	49.4	–	36.5	–	27.0	–	22.7	–	–	–	–	–	–	–	–
VPF-A1002F	5000	–	–	36.5	30.6	–	–	22.7	–	–	–	18.2	–	–	–	–
VPF-A1003C	2250	49.4	–	36.5	30.6	–	25.7 *	–	–	–	–	–	–	–	–	–
VPF-A1003E	3750	49.4	–	36.5	–	27.0	–	–	–	20.6 *	–	–	–	–	–	–
VPF-A1003F	5500	–	–	–	30.6	–	24.5	–	–	20.0	–	–	17.4	–	–	–
VPF-A1153C	2300	68.3	–	50.5	42.4	–	35.2 *	–	–	–	–	–	–	–	–	–
VPF-A1303B	1950	68.3	–	50.5	42.4	37.8 *	–	–	–	–	–	–	–	–	–	–
VPF-A1303F	4000	–	–	50.5	–	37.4	–	31.4	–	27.7	–	–	–	–	–	–
VPF-A1304A	1600	68.3	57.2	51.1 *	–	41.2 *	–	–	–	–	–	–	–	–	–	–
VPF-A1304D	3000	68.3	–	50.5	–	37.4	–	31.4	–	–	–	–	–	–	–	–
VPF-B1001M	6000	–	–	–	–	27.0	–	22.7	–	20.0	–	–	–	16.8	–	–
VPF-B1002E	3300	49.4	–	36.5	–	27.0	–	–	21.8 *	–	–	–	–	–	–	–
VPF-B1002M	6000	–	–	–	30.6	–	–	22.7	–	–	19.0	–	–	16.8	–	–
VPF-B1003C	2500	49.4	–	36.5	30.6	–	24.5	–	–	–	–	–	–	–	–	–
VPF-B1003F	4750	–	–	36.5	30.6	–	–	22.7	–	–	–	18.6 *	–	–	–	–
VPF-B1003T	7000	–	–	–	30.6	–	24.5	–	–	–	19.0	–	–	–	–	15.7
VPF-B1153E	3200	68.3	–	50.5	–	37.4	–	–	30.5 *	–	–	–	–	–	–	–
VPF-B1153F	5000	–	–	50.5	–	37.4	–	31.4	–	–	–	25.1	–	–	–	–
VPF-B1303C	2250	68.3	–	50.5	42.4	–	35.5 *	–	–	–	–	–	–	–	–	–
VPF-B1303F	4000	–	–	50.5	–	37.4	–	31.8 *	–	27.7	–	–	–	–	–	–
VPF-B1304C	2150	68.3	–	50.5	43.6 *	–	36.2 *	–	–	–	–	–	–	–	–	–
VPF-B1304E	3500	–	–	50.5	42.4	–	35.2 *	–	29.3	–	–	–	–	–	–	–
VPF-B1652C	2700	90.1	–	66.7	55.9	–	–	43.3 *	–	–	–	–	–	–	–	–

(1) 1.0 kgf = 2.2 lbf or 9.8 N. An asterisk (*) indicates a load rating measured at an rpm value that is less than the value listed for that column.

Dimensions - Kinetix VP Food Grade Motors

VPF-A/B063xx and VPF-A/B075xx Motor Dimensions

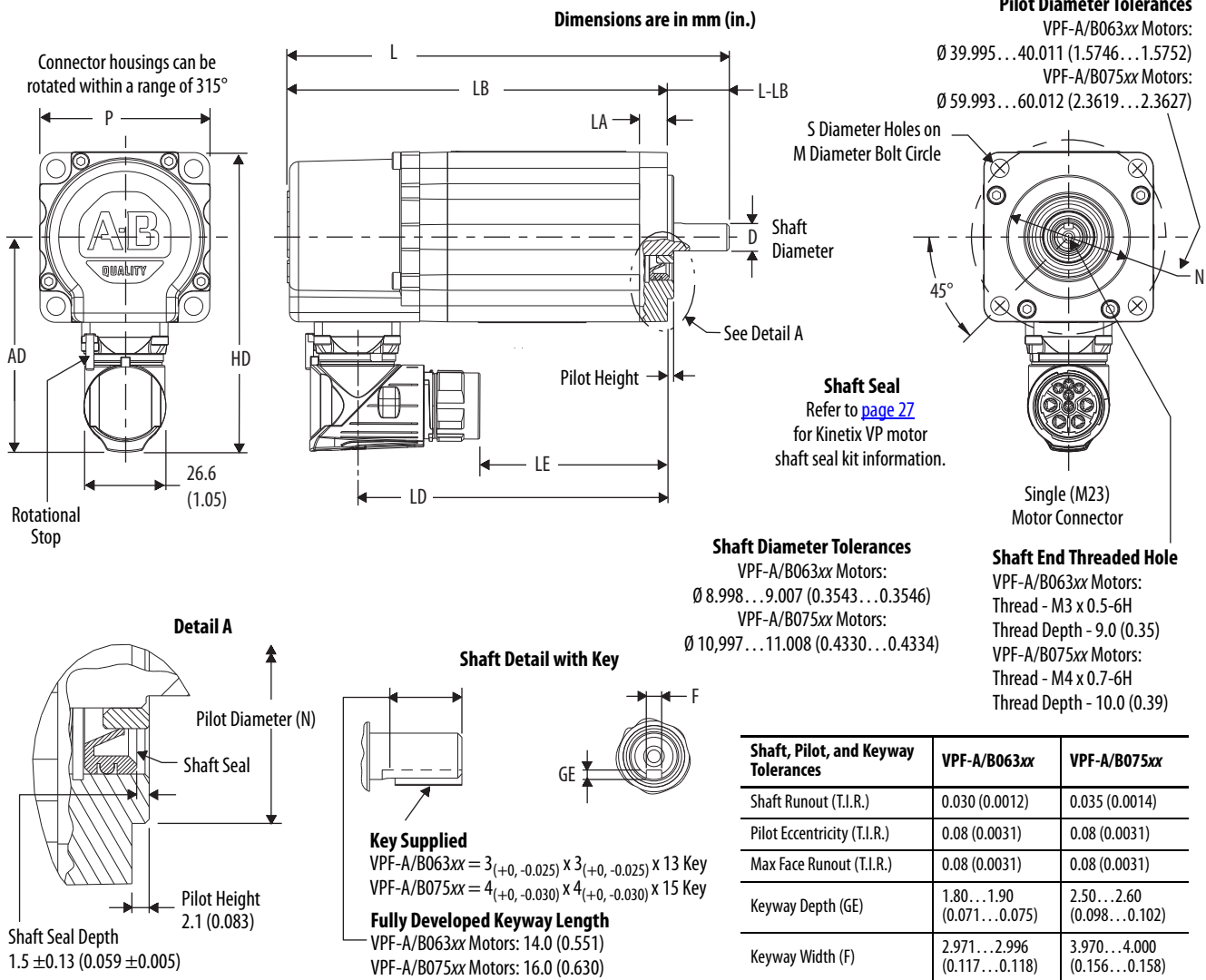

VPF-A/B063xx and VPF-A/B075xx Motor Dimensions

Motor Cat. No.	AD mm (in.)	HD mm (in.)	LA mm (in.)	LD ⁽¹⁾ mm (in.)	LE ⁽¹⁾ mm (in.)	L ⁽¹⁾ mm (in.)	LB ⁽¹⁾ mm (in.)	L-LB ⁽²⁾ mm (in.)	D ⁽⁴⁾ mm (in.)	M mm (in.)	S ⁽³⁾ mm (in.)	N ⁽⁴⁾ mm (in.)	P mm (in.)	GE ⁽⁴⁾ mm (in.)	F ⁽⁴⁾ mm (in.)
VPF-A/B0632	69.5 (2.74)	97.0 (3.82)	9.0 (0.35)	125.2 (4.93)	85.3 (3.36)	168.1 (6.61)	148.1 (5.83)	20.0 (0.787)	9.0 (0.354)	63.0 (2.480)	5.80 (0.234)	40.0 (1.575)	55.0 (2.17)	1.90 (0.075)	3.0 (0.118)
VPF-A/B0633				150.2 (5.91)	110.3 (4.34)	193.1 (7.59)	173.1 (6.81)								
VPF-A/B0752	77.0 (3.03)	112.0 (4.41)	9.0 (0.35)	127.0 (5.00)	87.1 (3.43)	172.9 (6.80)	149.9 (5.90)	23.0 (0.906)	11.0 (0.433)	75.0 (2.953)	5.80 (0.234)	60.0 (2.362)	70.0 (2.76)	2.60 (0.102)	4.0 (0.157)
VPF-A/B0753				152.0 (5.98)	112.1 (4.41)	197.9 (7.79)	174.9 (6.89)								

- (1) If ordering an VPF-A/B063xx or VPF-A/B075xx motor with brake, add 30.6 mm (1.20 in.) to dimension L, LB, LE, and LD.
- (2) Tolerance for this dimension is ±0.7 mm (±0.028 in.).
- (3) Tolerance for this dimension is +0.3, -0.0 mm (±0.006 in.).
- (4) For keyway, shaft diameter, and pilot diameter tolerances, refer to [page 41](#).

VPF-A/B100xx, VPF-A/B115xx, VPF-A/B130xx, and VPF-B165xx Motor Dimensions (SpeedTec DIN connectors)

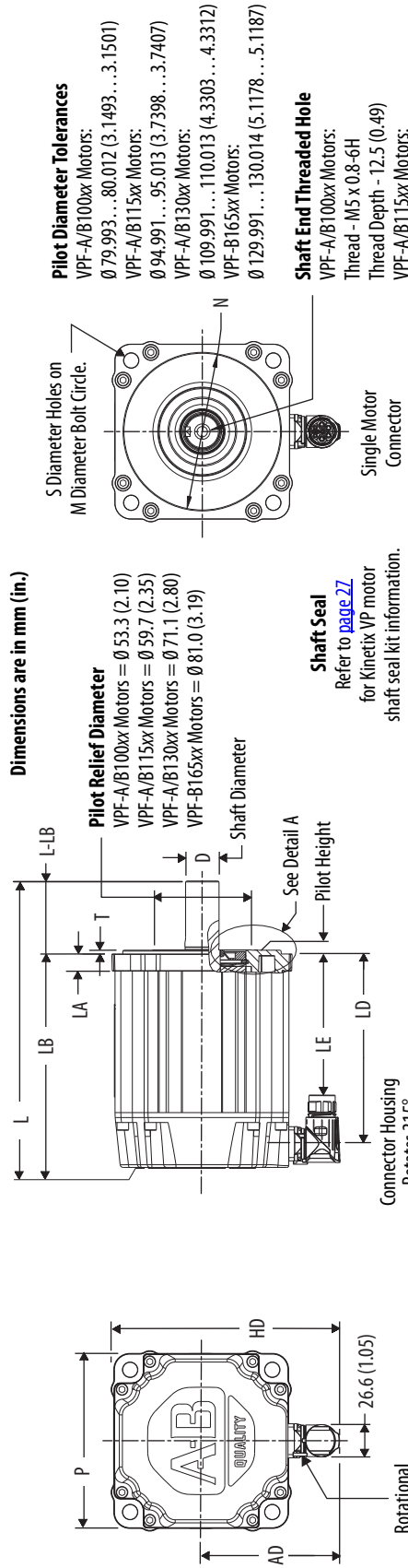

Shaft Diameter Tolerances
 VPF-A/B100xx = Ø 15.997...16.008 (0.6298...0.6302)
 VPF-A/B115xx = Ø 18.996...19.009 (0.7479...0.7483)
 VPF-A/B130xx = Ø 23.996...24.009 (0.9448...0.9451)
 VPF-B165xx = Ø 27.996...28.009 (1.1022...1.1027)

Shaft Detail with Key

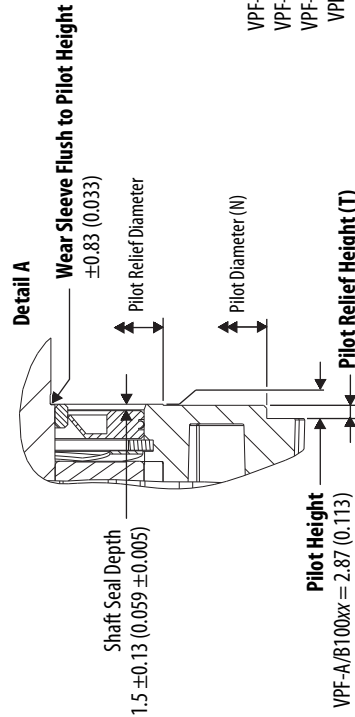
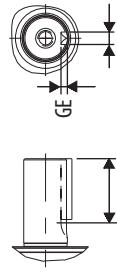

Shaft, Pilot, and Keyway Tolerances	VPF-A/B100xx	VPF-A/B115xx	VPF-A/B130xx	VPF-B165xx
Shaft Runout (T.I.R.)	0.04 (0.0016)			
Pilot Eccentricity (T.I.R.)	0.078 (0.0031)			
Max Face Runout (T.I.R.)	0.078 (0.0031)			
Keyway Depth (GE)	3.00...3.10 (0.118...0.122)	3.50...3.60 (0.138...0.142)	4.00...4.20 (0.158...0.165)	
Keyway Width (F)	4.97...5.00 (0.196...0.197)	5.97...6.00 (0.235...0.236)	7.96...8.00 (0.314...0.315)	

Motors are designed to metric dimensions. Inch dimensions are approximate conversions from millimeters. Dimensions without tolerances are for reference.

VPF-A/B100xx, VPF-A/B115xx, VPF-A/B130xx, and VPF-B165xx Motor Dimensions (SpeedTec DIN connectors)

Motor Cat. No.	AD mm (in.)	HD mm (in.)	T mm (in.)	LA mm (in.)	LD ⁽¹⁾ mm (in.)	LE ⁽¹⁾ mm (in.)	L ⁽¹⁾ mm (in.)	LB ⁽¹⁾ mm (in.)	L-LB ⁽²⁾ mm (in.)	D ⁽³⁾ mm (in.)	M mm (in.)	S mm (in.)	N ⁽³⁾ mm (in.)	P mm (in.)	GE ⁽³⁾ mm (in.)	F ⁽³⁾ mm (in.)
VPF-A/B1001					108.7 (4.28)	68.9 (2.71)	169.8 (6.68)	129.8 (5.11)								
VPF-A/B1002	86.5 (3.40)	131.2 (5.17)	2.74 (0.108)	9.90 (0.39)	134.1 (5.28)	94.3 (3.71)	195.2 (7.68)	155.2 (6.11)	40.0 (1.575)	16.0 (0.630)	100.0 (3.937)	7.00 ⁽⁴⁾ (0.283)	80.0 (3.15)	89.4 (3.52)	3.0 (0.118)	5.0 (0.197)
VPF-A/B1003					159.5 (6.28)	119.7 (4.71)	220.6 (8.68)	180.6 (7.11)								
VPF-A/B1153	90.8 (3.58)	140.0 (5.51)	2.74 (0.108)	10.16 (0.40)	156.0 (6.14)	116.1 (4.57)	216.9 (8.54)	177.0 (6.97)	40.0 (1.575)	19.0 (0.748)	115.0 (4.528)	10.00 ⁽⁴⁾ (0.401)	95.0 (3.74)	98.3 (3.87)	3.5 (0.138)	6.0 (0.236)
VPF-A/B1303	98.6 (3.88)	155.4 (6.12)	2.74 (0.108)	12.19 (0.48)	159.3 (6.27)	119.4 (4.70)	230.2 (9.06)	180.3 (7.10)	50.0 (1.969)	24.0 (0.945)	130.0 (5.118)	10.00 ⁽⁴⁾ (0.401)	110.0 (4.331)	113.7 (4.48)	4.0 (0.158)	8.0 (0.315)
VPF-A/B1304					184.7 (7.27)	144.8 (5.70)	255.6 (10.06)	205.7 (8.10)								
VPF-B1652	113.3 (4.46)	185.0 (7.28)	3.12 (0.123)	14.0 (0.55)	206.2 (8.12)	166.4 (6.55)	286.3 (11.27)	226.4 (8.92)	60.0 (2.362)	28.0 (1.102)	165.0 (6.496)	12.00 ⁽⁵⁾ (0.481)	130.0 (5.118)	143.5 (5.65)	4.0 (0.158)	8.0 (0.315)

- (1) If ordering a VPF-A/B100xx-xxx4xx motor with brake, add 34.5 mm (1.36 in.) to dimensions L, LB, LE, and LD.
 If ordering a VPF-A/B115xx-xxx4xx motor with brake, add 48.5 mm (1.91 in.) to dimensions L, LB, LE, and LD.
 If ordering a VPF-A/B130xx-xxx4xx motor with brake, add 48.5 mm (1.91 in.) to dimensions L, LB, LE, and LD.
 If ordering a VPF-B165xx-xxx4xx motor with brake, add 51.5 mm (2.03 in.) to dimensions L, LB, LE, and LD.
- (2) Tolerance for this dimension is ±0.7 mm (±0.028 in.).
- (3) For keyway, shaft diameter, and pilot diameter tolerances, refer to [page 42](#).
- (4) Tolerance for this dimension is +0.36, -0.0 mm (±0.007 in.).
- (5) Tolerance for this dimension is +0.43 -0.0 mm (±0.008 in.).

Motors are designed to metric dimensions. Inch dimensions are approximate conversions from millimeters. Dimensions without tolerances are for reference.