

# SNAP ACTION SWITCH

## Features

- Reliability is excellent.
- It's has long life and more operating force can be applied such as lightly force.
- Good feeling and more levers are applied.

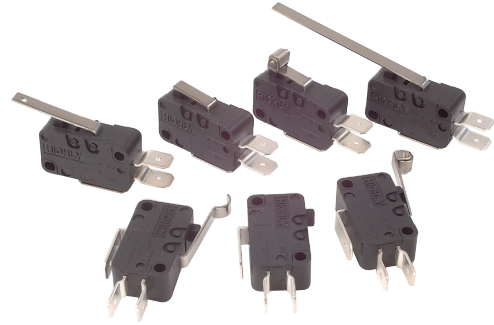

## Applications

- Joystick , TV game , Time recorder , Air conditioner , Food processor , Juice maker , Alarm , Mixer , Shredder machine , etc.

## Specifications

Item	Standard
Rating	16(4)A 250V AC
Conforming to standards	IEC 61058-1; UL 1054
Contact Resistance	15 mΩ max. (initial)
Insulation Resistance	100MΩ min. (at 500V DC)
Dielectric Strength	Between terminals of same polarity AC 1000V (50/60Hz for 1minute)
	Between each terminal and non-current-carrying rind parts AC 2000V ( 50/60Hz for 1 minute)
Electrically Life	100,000 cycles
Mechanically Life	1,000,000 cycles

## Product Selection

VT16     
 1 2 3

### 1. ACTUATOR TYPES

- |                              |                                     |
|------------------------------|-------------------------------------|
| <b>00:</b> Pin plunger       | <b>04:</b> Simulated roller lever   |
| <b>01:</b> Short hinge lever | <b>05:</b> Short hinge roller lever |
| <b>02:</b> Hinge lever       | <b>06:</b> Hinge roller lever       |
| <b>03:</b> Long hinge lever  |                                     |

### 2. CONTACT FORM & COMMON TERMINAL POSITION

Contact form	1: SPDT	2: SPST-NC	3: SPST-NO
Common terminal position	button 	button 	button 

### Mounting Holes

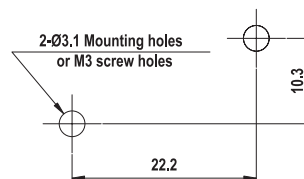

### 3. Terminal Type

Terminal Type	Dimensions
Solder terminal (-A)	 Ø2.0Holes, 6.3, 6.8, 0.8t, 7.4, 4.7, 2.9, 17.3
Quick-connect terminal 6.4x0.8 (-C)	 Ø1.6Holes, 6.4, 11.0, 0.8t, 7.4, 2.9, 14.5
Quick-connect terminal 4.8x0.8 (-C2)	 Ø1.5Holes, 4.7, 6.05, 9.9, 0.5t, 5.2, 4.0, 14.5

**HIGHLY**

B10

Design, specifications are subject to change without notice.

# SNAP ACTION SWITCH

## Operating Characteristics

Unit: mm

Item Operating Characteristics Dimensions

### VT1600



OF	max	250g.
RF	min	30g
PT	max..	1.4 mm
OT	min.	0.8 mm
MD	max.	0.4 mm
OP		14.7±0.4 mm

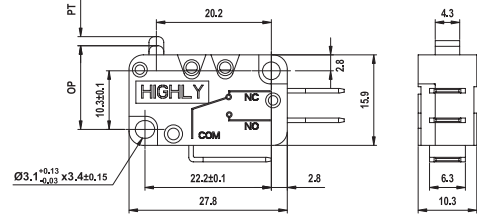

### VT1601



OF	max.	250g
RF	min.	20g
PT	max.	1.6 mm
OT	min.	0.8 mm
MD	max.	0.4 mm
OP		15.2±0.6 mm

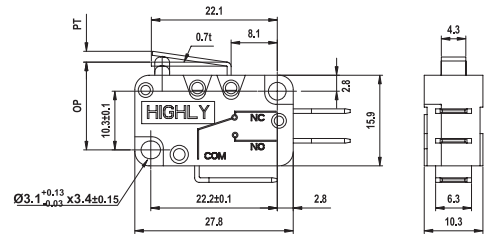

### VT1602

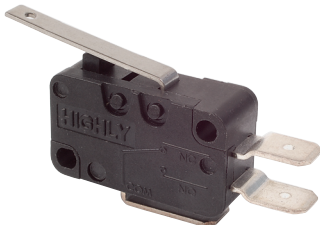

OF	max.	120g
RF	min.	10g
PT	max.	3.2 mm
OT	min.	1.8 mm
MD	max.	1.0 mm
OP		15.2±1.5 mm

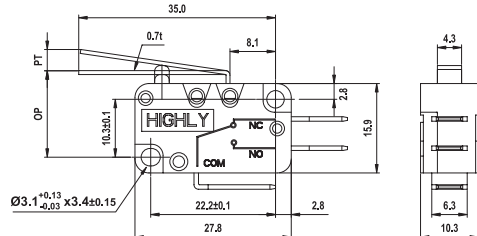

### VT1603



OF	max.	60g
RF	min.	5g
PT	max.	8.0 mm
OT	min.	3.0 mm
MD	max.	2.2 mm
OP		15.2±2.6 mm

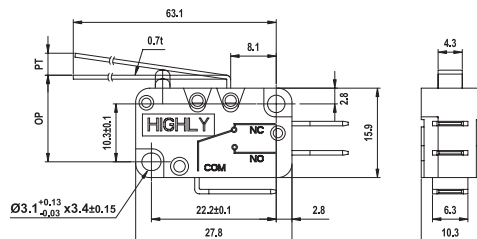

**HIGHLY**

B11

Design, specifications are subject to change without notice.

# SNAP ACTION SWITCH

## Operating Characteristics

Unit: mm

Item Operating Characteristics Dimensions

### VT1604



OF	max.	120g
RF	min.	10g
PT	max.	3.2 mm
OT	min.	1.8 mm
MD	max.	1.0 mm
OP		18.7 ± 1.2 mm

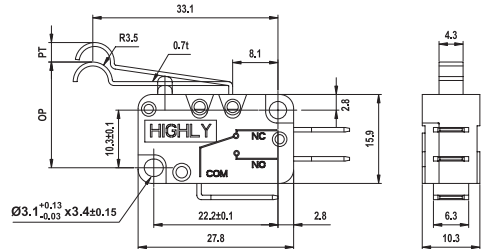

### VT1605



OF	max.	250g
RF	min.	30g
PT	max.	14 mm
OT	min.	0.8 mm
MD	max.	0.4 mm
OP		20.7 ± 0.6 mm

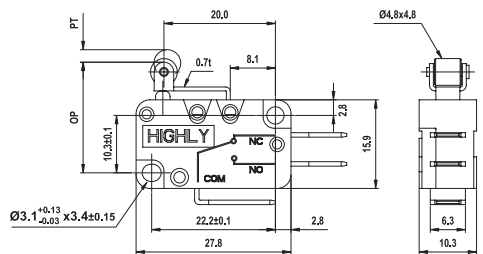

### VT1606



OF	max.	120g
RF	min.	10g
PT	max.	3.2 mm
OT	min.	1.8 mm
MD	max.	1.0 mm
OP		20.7 ± 1.5 mm

