

**WCN2-0040SR-A11****SPECIFICATION**

WCN			CUSTOMER Confirmed
Prepared by	Checked by	Approved by	

**REVISION: 01**

■ **Outer Dimension:**

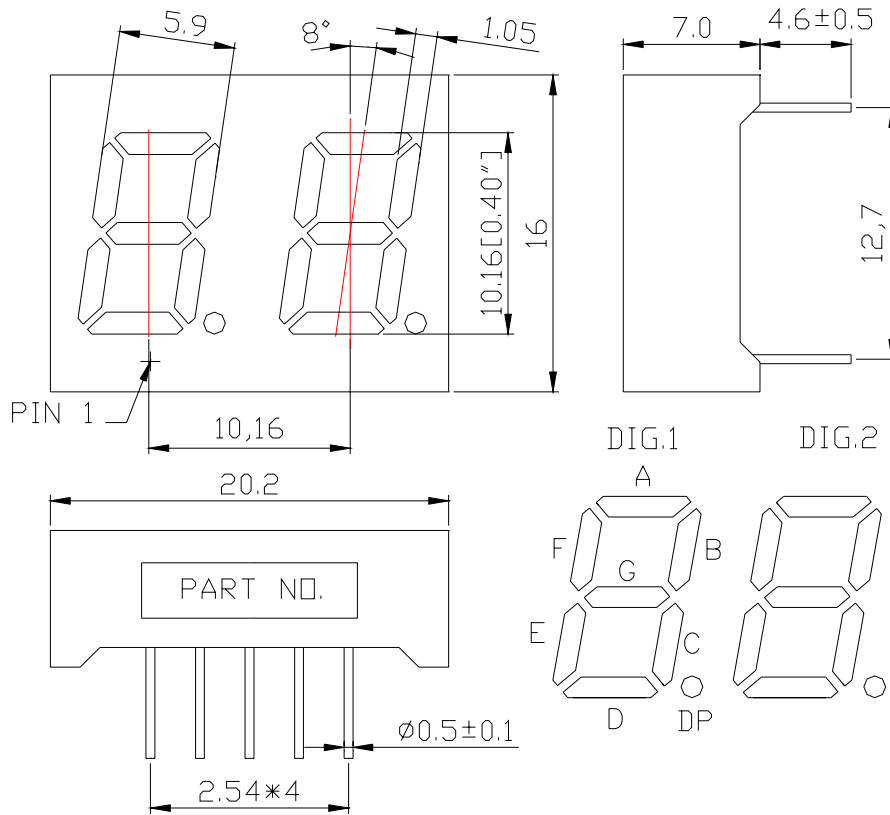

Notes: Unless otherwise stated, The tolerance is  $\pm 0.25\text{mm}$ .

■ **Circuit Diagram:**

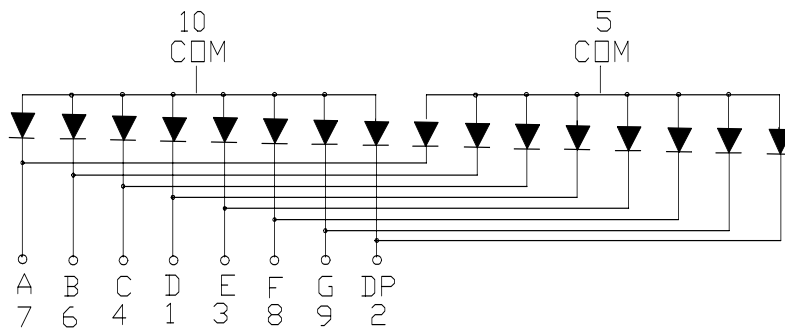

■ **Pin Connection:**

PIN NO.	CONNECTION	PIN NO.	CONNECTION
1	Cathode D	6	Cathode B
2	Cathode DP	7	Cathode A
3	Cathode E	8	Cathode F
4	Cathode C	9	Cathode G
5	Common Anode Dig.2	10	Common Anode Dig.1

**■ Features:**

- . High Reliability
- . Color: Red
- . Low Power Requirement
- . Easy Assembly

**■ Description:**

- . Dual Digit LED Display
- . Digit Height: 10.16mm(0.40" )
- . Black Face and Milky Segment

**■ Absolute Maximum Rating (Ta=25°C):**

Parameter Symbol	Condition	Color	Rating	Unit	
Power Dissipation Per Segment	Pd	—	Red 65	mW	
Forward Current Per Segment	IF	—	Red 25	mA	
Derating Of If Per Segment	$\Delta I_F$ Ta	$\geq 25^\circ\text{C}$	Red	0.30	mA/°C
Peak Forward Current Per Segment	IFP	1/10 Duty 10KHz	Red	100	mA
Reverse Voltage Per Segment	VR	—	Red 5	V	
Operating Temperature Range	Topr	—	— -35	~+85	°C
Storage Temperature Range	Tstg	—	— -35	~+85	°C

**■ Electrical/Optical Characteristics Rating(Ta=25°C):**

Item	Symbol	Test conditions	Location	Rating			Unit
				Min.	Typ.	Max.	
Forward Voltage	VF	IF=20mA	Per Segment	—	2.00	2.60	V
Reverse Current	IR	VR=5V Per	Segment	—	—	100	μA
Luminous Intensity	IV	IF=10mA	Per Segment	3201	6000	—	μcd
Wave Length	$\lambda_P$	IF=20mA	Per Segment	—	638	—	nm
	$\lambda_D$			—	633		
Spectral Line Half Width	$\Delta\lambda$	IF=20mA	Per Segment	—	20	—	nm
Luminous Intensity Matching Ratio (Segment to segment)	IV-m	IF=10mA	—	—	—	2:1	

**■ Luminous Intensity Sorting:( Luminous Intensity Tolerance is +/-10%)**

Rank	Symbol	Condition	Min	Max	Unit
J	J	IF=10mA	3201	5050	μcd
K K		IF=10mA	5051	8000	μcd
L L		IF=10mA	8001	12650	μcd

**■ Soldering Conditions: Soldering Temp.  $\leq +260^\circ\text{C}$ , Soldering Time.  $\leq 3\text{sec}$ .**

(at 2mm Distance from The Case of Reflector Edge)

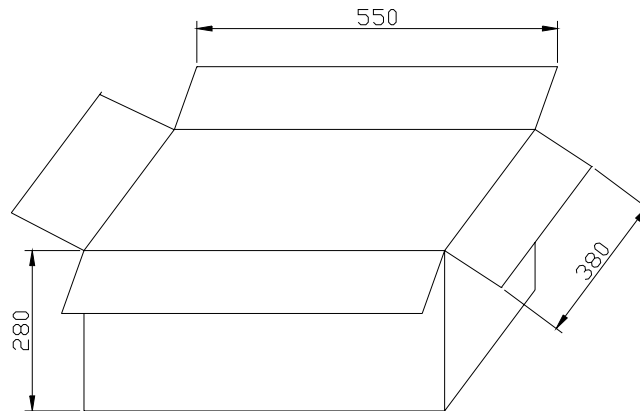
**Outer Carton Dimension:**

- Note:**
1. An Outer carton contained 6 Inner cartons and 6000 PCS products.
  2. Unless otherwise stated, the tolerance is +5mm / -0mm.
  3. The carton material is A=A Brown Paper.

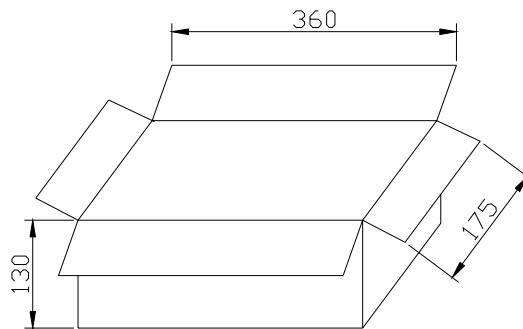
**Inner Carton Dimension:**

- Note:**
1. An Inner carton contained 7 PCS Foam Board and 1000 PCS products.
  2. Unless otherwise stated, the tolerance is  $\pm 3$  mm.

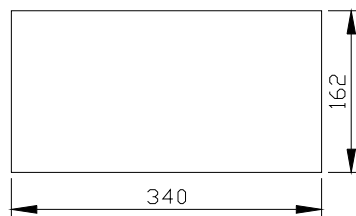
**Steamed Foam Dimension:**

- Note:**
1. A Steamed Foam contained 144 PCS products.
  2. Unless otherwise stated, The tolerance is  $\pm 2$  mm.