

3.96mm (0.156") PITCH CONNECTOR

Wire-to-Board
Crimp Terminal

YT396J

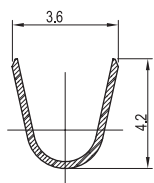
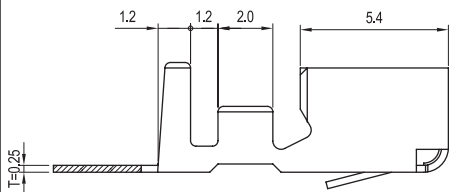
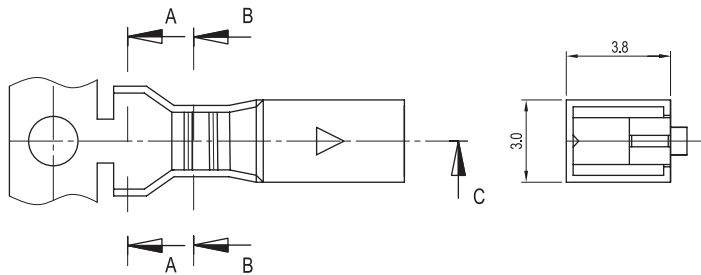
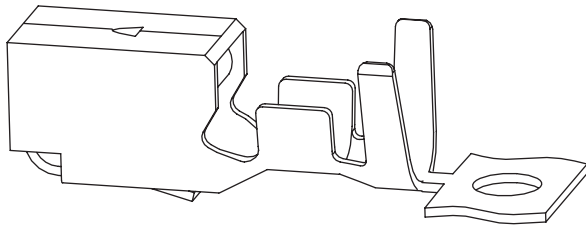

SECTION A-A

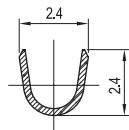

SECTION B-B

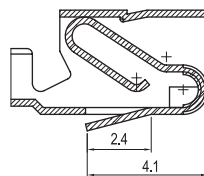

SECTION C-C

Material

| I/NO | DESCRIPTION | TITLE | AWG | MATERIAL | FINISH |
|------|-------------|--------|---------|----------|------------|
| 1 | TERMINAL | YT396J | #16~#24 | Brass | Tin-Plated |

Specification

| ITEM | SPEC |
|------------------------|----------------------|
| Voltage Rating | AC/DC 250V |
| Current Rating | AC/DC 7.5A |
| Operating Temperature | -25℃~+85℃ |
| Contact Resistance | 30mΩ MAX |
| Withstanding Voltage | AC1500V/1min |
| Insulation Resistance | 1000MΩ MIN |
| Applicable Wire | AWG #16~#24 |
| Applicable P.C.B | - |
| Applicable FPC/FFC | - |
| Solder Height | - |
| Crimp Tensile Strength | L-TYPE : AWG #16~#20 |
| | M-TYPE : AWG #20~#24 |
| | AWG #16 : 4.0kgfMIN |
| | AWG #18 : 3.5kgfMIN |
| | AWG #20 : 3.0kgfMIN |
| AWG #22 : 2.5kgfMIN | |
| AWG #24 : 2.0kgfMIN | |
| UL FILE NO | - |