

Coaxial Directional Coupler

NEW!
ZNDC-18-2G

50Ω 18dB 800 to 2000 MHz

Maximum Ratings

Operating Temperature	-55°C to 100°C
Storage Temperature	-55°C to 100°C
Power Input	3W Max.

Pin Connections

INPUT	1
OUTPUT	2
COUPLED	3

Outline Drawing

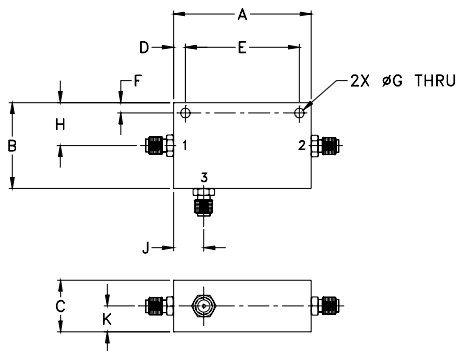

Outline Dimensions (inch mm)

A	B	C	D	E	F	G	H
2.00	1.25	.75	.17	1.656	.15	.140	.63
50.80	31.75	19.05	4.32	42.06	3.81	3.56	16.00

J	K	wt.
.44	.38	grams
11.18	9.65	57

Features

- excellent insertion loss, 0.5 dB typ.
- excellent VSWR, 1.15:1 typ.
- very flat coupling, ± 0.3 dB typ.

Applications

- cellular
- PCS
- ISM



CASE STYLE: FM587
PRICE: \$49.95 ea. QTY (1-9)

Directional Coupler Electrical Specifications

FREQ. RANGE (MHz)	COUPLING (dB)		MAINLINE LOSS (dB)		DIRECTIVITY (dB)		VSWR (:1)	POWER INPUT (W)
	Nom.	Max. Flatness	Typ.	Max.	Typ.	Min.		
800-2000								
800-1000	18.5 \pm 0.5	\pm 0.3	0.3	0.6	22	17	1.1	3
1000-1700	18.2 \pm 0.5	\pm 0.4	0.5	0.9	25	18	1.2	3
1700-2000	18.0 \pm 0.5	\pm 0.35	0.6	1.1	25	14	1.3	3

Typical Performance Data

Frequency (MHz)	Insertion Loss (dB) In-Out	Coupling (dB) In-Cpl	Directivity (dB)	Return Loss (dB)		
				In	Out	Cpl
800.00	0.35	18.76	23.37	21.37	21.29	21.05
900.00	0.36	18.64	24.53	22.59	22.52	21.97
1000.00	0.38	18.53	25.86	24.03	23.48	22.73
1100.00	0.41	18.42	27.49	25.01	24.10	23.40
1300.00	0.46	18.23	30.98	25.09	23.78	23.61
1500.00	0.53	18.09	39.09	23.97	22.61	21.52
1700.00	0.58	17.98	35.88	23.18	21.27	19.43
1800.00	0.63	17.96	29.68	22.92	20.69	18.20
1900.00	0.67	17.97	25.97	22.85	20.31	16.89
2000.00	0.70	17.98	22.69	23.35	20.36	15.85

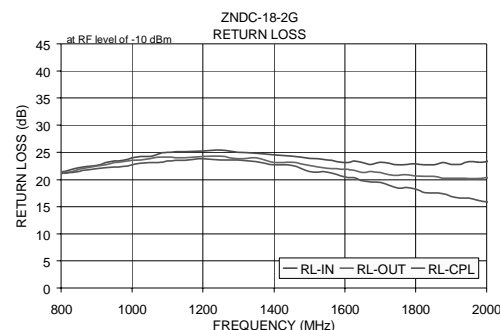
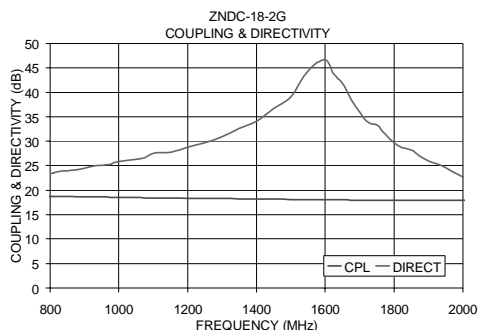
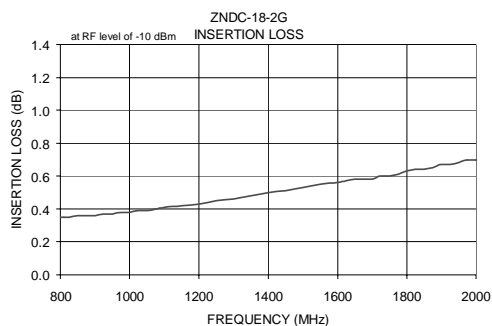

Distribution Centers NORTH AMERICA 800-654-7949 • 417-335-5935 • Fax 417-335-5945 • EUROPE 44-1252-832600 • Fax 44-1252-837010

INTERNET <http://www.minicircuits.com>

P.O. Box 350166, Brooklyn, New York 11235-0003 (718) 934-4500 Fax (718) 332-4661

ISO 9001 CERTIFIED

REV. A
M92341
ED-10022
ZNDC-18-2G
WZTD/CP
040510