

# Coaxial Amplifier

## ZX60-5916M+ ZX60-5916M

50Ω High Isolation 1.5 to 5.9 GHz

### Features

- from 2.8V to 5V operation
- wide bandwidth, 1.5 to 5.9 GHz
- high active directivity, 25 dB typ.
- output power, up to 14.5 dBm typ.
- protected by US patent 6,790,049

### Applications

- buffer amplifier
- LO amplifiers for mixers
- cellular
- PCN



CASE STYLE: GC957

Connectors	Model	Price	Qty.
SMA	ZX60-5916M-S(+)	\$59.95	(1-9)

**+ RoHS compliant in accordance with EU Directive (2002/95/EC)**

The +Suffix identifies RoHS Compliance. See our web site for RoHS Compliance methodologies and qualifications.

### Electrical Specifications T<sub>AMB</sub>=25°C

MODEL NO.	FREQ. (GHz)		DC VOLTS (V)	GAIN, dB Typical						MAXIMUM POWER (dBm)		DYNAMIC RANGE			VSWR (:1) Typ.		ACTIVE DIRECTIVITY (dB) (Isolation-Gain) Typ	DC OPERATING CURRENT @ Pin V+ (mA)	
	f <sub>L</sub>	f <sub>U</sub>		over frequency, GHz						Output (1 dB Comp.)		NF (dB) Typ.	IP3 (dBm) Typ.	In	Out	Typ		Typ	Max.
	1.5	2.0		3.5	5.0	5.9	Min. at 2 GHz	f <sub>L</sub>	f <sub>U</sub>	at 2 GHz	at 2 GHz								
ZX60-5916M(+)	1.5	5.9	5.0 2.8	17.0	17.7	17.2	18.0	13.8	15.5	14.5	15.7	6.4	28.3	28.9	2.2	1.2	20	73	96
				13.6	14.6	14.7	16.5	11.5	—	11.5	12.8	7.0	23.5	23.5	2.5	1.4	25	66	—

### Maximum Ratings

Operating Temperature	-40°C to 85°C
Storage Temperature	-55°C to 100°C
DC Voltage	7V
Input Power(no damage)	10 dBm
Power	500mW

### Outline Drawing

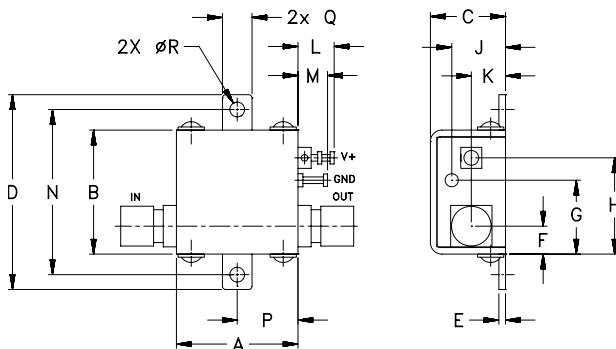

### Outline Dimensions (inch/mm)

A	B	C	D	E	F	G	H	J
.74	.75	.46	1.18	.04	.17	.45	.59	.33
18.8	19.1	11.7	30.0	1.02	4.32	11.43	15.0	8.38
K	L	M	N	P	Q	R		wt
.21	.22	.18	1.00	.37	.18	.09		grams
5.33	5.59	4.57	25.40	9.40	4.57	2.29		23.0



P.O. Box 350166, Brooklyn, New York 11235-0003 (718) 934-4500 Fax (718) 332-4661 For detailed performance specs & shopping online see Mini-Circuits web site



The Design Engineers Search Engine Provides ACTUAL Data Instantly From MINI-CIRCUITS At: [www.minicircuits.com](http://www.minicircuits.com)

RF/IF MICROWAVE COMPONENTS

REV. B  
M98898  
ZX60-5916M  
EDR-6128  
RVN/TD/CP/AM  
070118  
Page 1 of 2

# ZX60-5916M+ ZX60-5916M

## Typical Performance Data/Curves

FREQUENCY (MHz)	GAIN (dB)		DIRECTIVITY (dB)		VSWR IN (:1)		VSWR OUT (:1)		NOISE FIGURE (dB)		POUT at 1 dB COMPR. (dBm)	
	2.8V	5V	2.8V	5V	2.8V	5V	2.8V	5V	2.8V	5V	2.8V	5V
1500.00	13.96	17.17	56.17	43.10	4.75	4.59	1.54	1.44	8.59	7.95	10.65	14.88
2000.00	14.62	17.57	35.49	34.05	3.07	2.81	1.58	1.34	7.15	6.49	11.19	14.69
2500.00	14.52	17.17	29.52	27.98	2.51	2.30	1.52	1.22	6.77	6.09	10.47	14.40
3000.00	14.58	16.96	25.18	24.90	2.27	2.13	1.46	1.19	6.12	5.53	10.98	14.19
3500.00	14.72	17.05	22.78	22.37	2.15	2.11	1.38	1.17	6.18	5.62	10.71	13.82
4000.00	14.85	17.27	20.93	20.39	2.06	2.11	1.29	1.14	5.87	5.44	10.50	13.47
4400.00	15.50	17.75	19.31	19.04	1.97	2.05	1.23	1.14	5.40	5.02	10.55	13.15
5000.00	16.48	18.04	17.36	17.44	2.02	2.00	1.24	1.15	5.44	5.21	11.39	13.79
5600.00	14.10	15.78	18.86	18.78	1.83	1.70	1.24	1.33	5.04	4.91	12.10	14.60
5900.00	11.72	13.97	21.38	20.13	1.74	1.61	1.25	1.33	5.82	5.29	11.27	14.99

