

TRANSISTOR (NPN)

FEATURES

- * Low equivalent on-resistance
- * Halogen free

MAXIMUM RATINGS (T_a=25°C unless otherwise noted)

Symbol	Parameter	Value	Unit
V _{CB0}	Collector-Base Voltage	40	V
V _{CEO}	Collector-Emitter Voltage	40	V
V _{EBO}	Emitter-Base Voltage	7	V
I _C	Collector Current	1	A
I _{CM}	Peak Pulse Current	2	A
P _C	Collector Power Dissipation	500	mW
R _{θJA}	Thermal Resistance From Junction To Ambient	250	°CW
T _j	Junction Temperature	-55~+150	°C
T _{stg}	Storage Temperature	-55~+150	°C

SOT-23

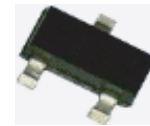
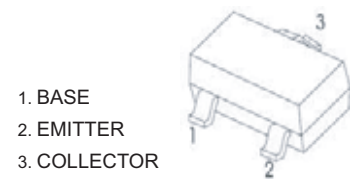

Marking :41A

ELECTRICAL CHARACTERISTICS (T_a=25°C unless otherwise specified)

Parameter	Symbol	Test conditions	Min	Typ	Max	Unit
Collector-base breakdown voltage	V _{(BR)CBO}	I _C =100μA, I _E =0	40			V
Collector-emitter breakdown voltage	V _{(BR)CEO} ¹	I _C =10mA, I _B =0	40			V
Emitter-base breakdown voltage	V _{(BR)EBO}	I _E =100μA, I _C =0	7			V
Collector cut-off current	I _{CBO}	V _{CB} =30V, I _{CES} =30V			0.1	μA
Emitter cut-off current	I _{EBO}	V _{EB} =5V, I _C =0			0.1	μA
DC current gain	h _{FE(1)}	V _{CE} =5V, I _C =1mA	300			
	h _{FE(2)} ¹	V _{CE} =5V, I _C =500mA	300		900	
	h _{FE(3)} ¹	V _{CE} =5V, I _C =1A	200			
	h _{FE(4)} ¹	V _{CE} =5V, I _C =2A	35			
Collector-emitter saturation voltage	V _{CE(sat)1} ¹	I _C =500mA, I _B =50mA			0.3	V
	V _{CE(sat)2} ¹	I _C =1A, I _B =100mA			0.5	V
Base-emitter saturation voltage	V _{BE(sat)} ¹	I _C =1A, I _B =100mA			1.1	V
Base-emitter voltage	V _{BE} ¹	V _{CE} =5V, I _C =1A			1	V
Transition frequency	f _T	V _{CE} =10V, I _C =50mA, f=100MHz	150			MHz
Collector output capacitance	C _{ob}	V _{CB} =10V, f=1MHz			10	pF

¹Measured under pulsed conditions, Pulse width=300μs, Duty cycle≤2%.

RATING AND CHARACTERISTICS CURVES (FMMT491A)

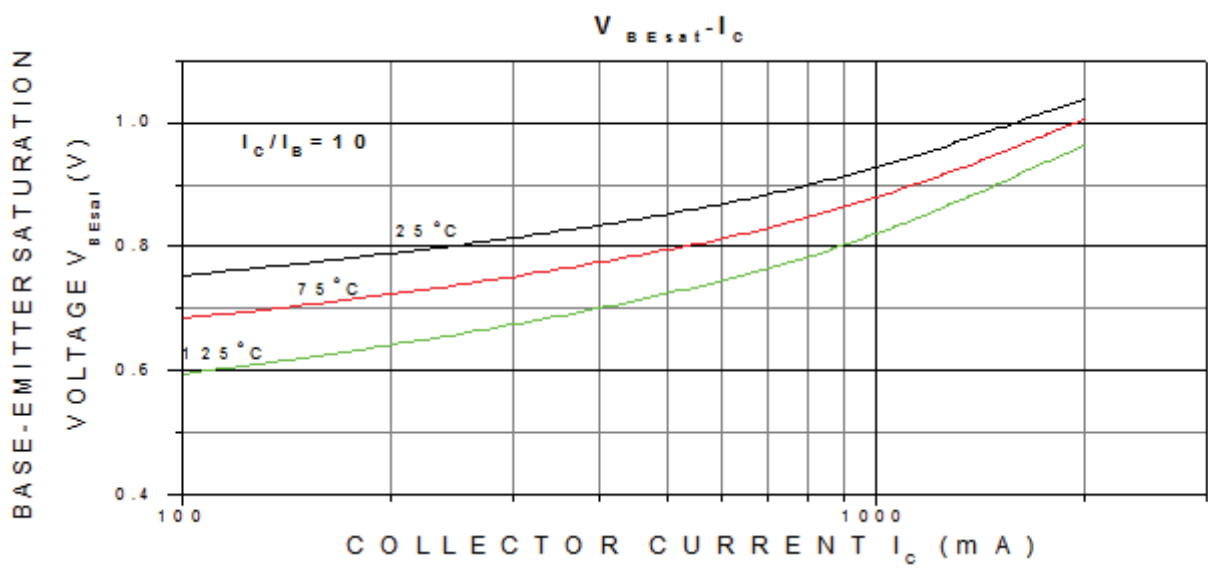
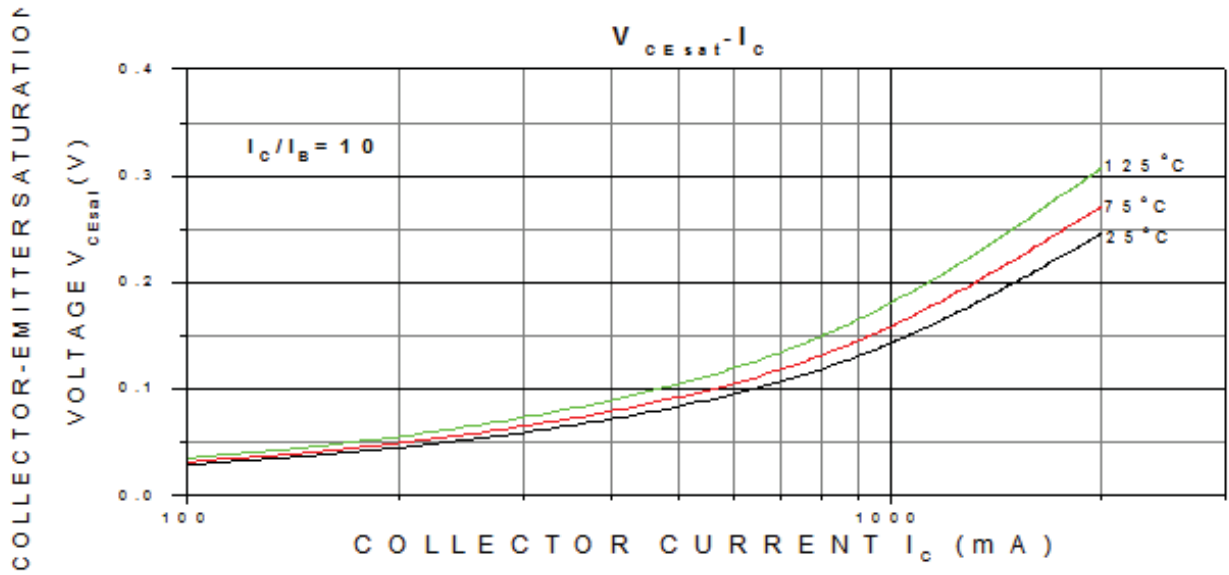

SOT-23 Package Outline Dimensions

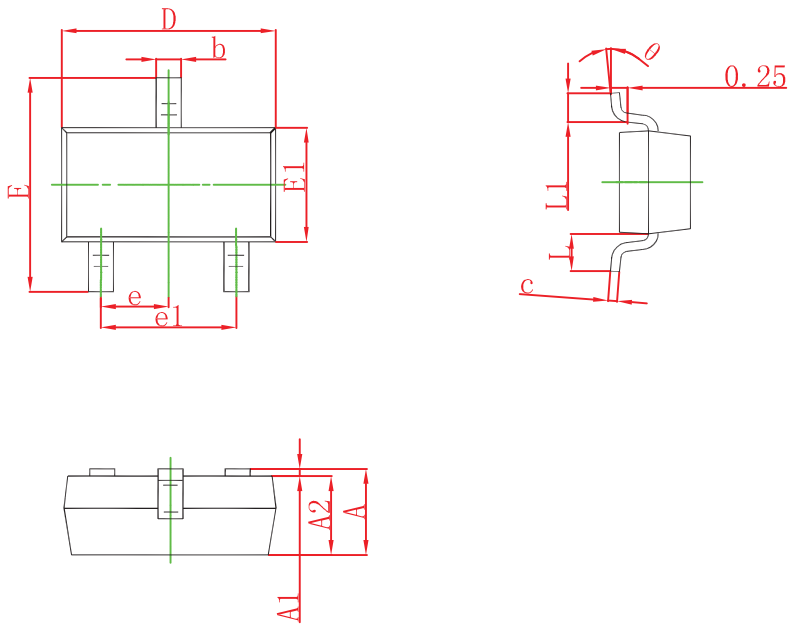

Symbol	Dimensions In Millimeters	
	Min	Max
A	0.900	1.150
A1	0.013	0.100
A2	1.050	1.150
b	0.300	0.510
c	0.090	0.200
D	2.800	3.040
E1	1.200	1.700
E	2.100	2.950
e	0.950	
e1	1.780	2.050
L	0.300	0.600
θ	0°	8°

SOT-23 Suggested Pad Layout

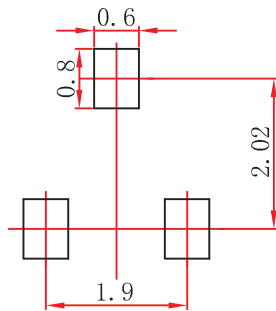

Note:

1. Controlling dimension: in millimeters.
2. General tolerance: $\pm 0.05\text{mm}$.
3. The pad layout is for reference purposes only.

SOT-23 Tape and Reel

SOT-23 Embossed Carrier Tape

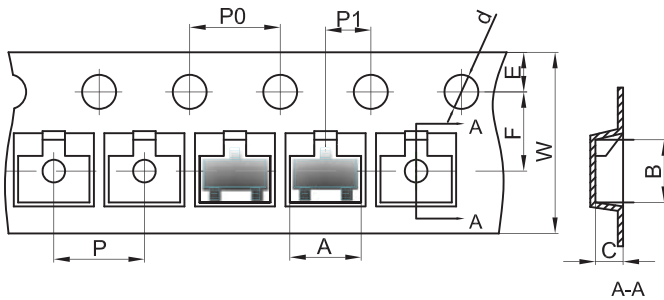

Packaging Description:

SOT-23 parts are shipped in tape. The carrier tape is made from a dissipative (carbon filled) polycarbonate resin. The cover tape is a multilayer film (Heat Activated Adhesive in nature) primarily composed of polyester film, adhesive layer, sealant, and anti-static sprayed agent. These reeled parts in standard option are shipped with 3,000 units per 7" or 17.8cm diameter reel. The reels are clear in color and is made of polystyrene plastic (anti-static coated).

Dimensions are in millimeter										
Pkg type	A	B	C	d	E	F	P0	P	P1	W
SOT-23	3.15	2.77	1.22	Ø1.50	1.75	3.50	4.00	4.00	2.00	8.00

SOT-23 Tape Leader and Trailer

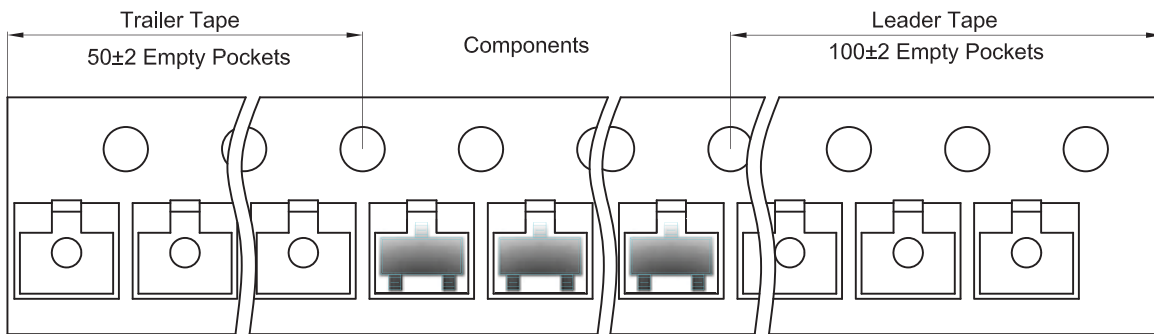

SOT-23 Reel

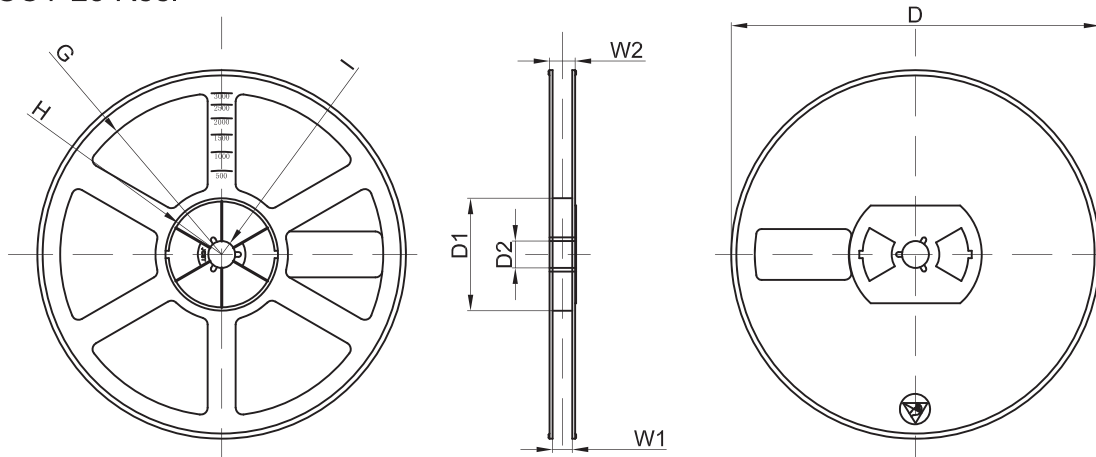

Dimensions are in millimeter								
Reel Option	D	D1	D2	G	H	I	W1	W2
7" Dia	Ø178.00	54.40	13.00	R78.00	R25.60	R6.50	9.50	12.30
REEL	Reel Size	Box	Box Size(mm)	Carton	Carton Size(mm)	G.W.(kg)		
3000 pcs	7 inch	45,000 pcs	203×203×195	180,000 pcs	438×438×220			

DISCLAIMER NOTICE

Rectron Inc reserves the right to make changes without notice to any product specification herein, to make corrections, modifications, enhancements or other changes. Rectron Inc or anyone on its behalf assumes no responsibility or liability for any errors or inaccuracies. Data sheet specifications and its information contained are intended to provide a product description only. "Typical" parameters which may be included on RECTRON data sheets and/ or specifications can and do vary in different applications and actual performance may vary over time. Rectron Inc does not assume any liability arising out of the application or use of any product or circuit.

Rectron products are not designed, intended or authorized for use in medical, life-saving implant or other applications intended for life-sustaining or other related applications where a failure or malfunction of component or circuitry may directly or indirectly cause injury or threaten a life without expressed written approval of Rectron Inc. Customers using or selling Rectron components for use in such applications do so at their own risk and shall agree to fully indemnify Rectron Inc and its subsidiaries harmless against all claims, damages and expenditures.