

PCK SERIES

High Ripple Current, Low Buzz

◆FEATURES

- High ripple current by special structure.
- High current correspondence by low ESR.
- Reduced a buzz by optimization of the production condition.
- Coated with flame-retardant (UL94 V-0) epoxy resin.
- RoHS compliance.



◆SPECIFICATIONS

Category Temperature Range	-40~+105°C (Derate the voltage as shown CAUTION FOR PROPER USE OF FILM CAPACITORS when using the capacitor beyond 85°C)
Rated Voltage (U _R)	450Vdc, 630Vdc, 800Vdc, 1000Vdc, 1250Vdc, 1600Vdc, 2000Vdc
Capacitance Tolerance	±5%(J), ±10%(K)
tanδ	0.001max at 1kHz
Voltage Proof	U _R ×150% 60s
Insulation Resistance	C≤0.33μF: 25000MΩmin C>0.33μF: 7500ΩFmin
Reference Standard	JIS C5101-16, JIS C5101-1

◆OUTLINE

(mm)

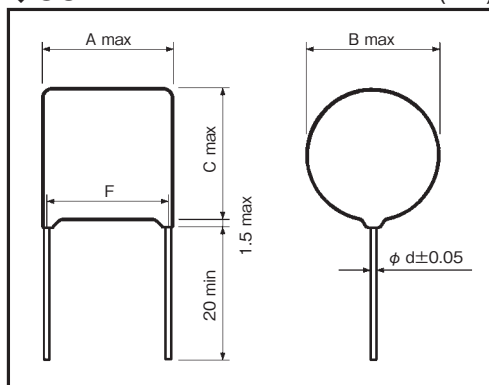

◆PART NUMBER

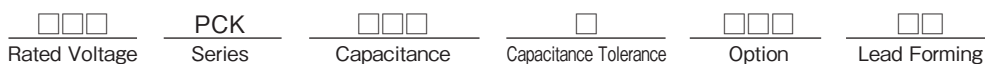

◆ STANDARD SIZE

□ : Capacitance Tolerance ** : Lead Forming

Rated Voltage	cap(μF)	Dimensions (mm)						Typical Packing Quantity (pcs)		Permissible Current (100kHz) (Arms)	Part No.
		A	B	C	F±1.0	LS±0.5	d	Long Lead type			
								Bag	Carton		
450 Vdc	2.2	21.0	16.5	18.5	17.5	—	1.0	100	500	4.8	450PCK225□**
	3.3	21.0	19.0	21.0	17.5	—	1.0	100	500	5.5	450PCK335□**
	4.7	26.0	19.0	21.0	22.5	—	1.0	100	400	6.5	450PCK475□**
	6.8	26.0	22.0	24.0	22.5	—	1.2	100	300	7.2	450PCK685□**
	10	26.0	25.5	27.5	22.5	—	1.2	50	250	8.0	450PCK106□**
	15	26.0	30.0	32.0	22.5	—	1.2	50	200	9.8	450PCK156□**
	22	26.0	35.5	37.5	22.5	—	1.2	40	160	10.8	450PCK226□**
630 Vdc	33	36.0	35.0	37.0	32.5	—	1.2	20	100	11.2	450PCK336□**
	1	21.0	16.0	18.0	17.5	—	1.0	100	800	4.8	630PCK105□**
	1.5	21.0	19.0	21.0	17.5	—	1.0	100	500	5.6	630PCK155□**
	2.2	21.0	22.0	24.0	17.5	—	1.0	100	400	7.2	630PCK225□**
	3.3	26.0	23.0	25.0	22.5	—	1.2	100	300	8.0	630PCK335□**
	4.7	26.0	26.0	28.0	22.5	—	1.2	50	300	8.5	630PCK475□**
	6.8	26.0	30.0	32.0	22.5	—	1.2	50	200	9.0	630PCK685□**
800 Vdc	10	36.0	30.0	32.0	32.5	—	1.2	40	160	10.0	630PCK106□**
	15	36.0	34.0	36.0	32.5	—	1.2	40	120	10.4	630PCK156□**
	0.68	21.0	18.0	20.0	17.5	—	1.0	100	500	4.6	800PCK684□**
	1	21.0	21.0	23.0	17.5	—	1.0	100	500	5.4	800PCK105□**
	1.5	21.0	24.5	26.5	17.5	—	1.0	100	300	6.7	800PCK155□**
	2.2	21.0	28.5	30.5	17.5	—	1.2	50	250	8.6	800PCK225□**
	3.3	26.0	30.0	32.0	22.5	—	1.2	50	200	8.7	800PCK335□**
1000 Vdc (101)	4.7	26.0	35.0	37.0	22.5	—	1.2	40	160	10.0	800PCK475□**
	6.8	36.0	34.0	36.0	32.5	—	1.2	40	120	9.3	800PCK685□**
	10	36.0	40.0	42.0	32.5	—	1.2	20	80	10.0	800PCK106□**
	0.68	21.0	22.5	24.5	17.5	—	1.0	100	300	6.5	101PCK684□**
	1	21.0	26.5	28.5	17.5	—	1.2	100	300	8.2	101PCK105□**
	1.5	26.0	26.5	28.5	22.5	—	1.2	50	200	8.5	101PCK155□**
	2.2	26.0	31.5	33.5	22.5	—	1.2	50	200	10.0	101PCK225□**
1250 Vdc (121)	3.3	36.0	30.5	32.5	32.5	—	1.2	40	160	10.0	101PCK335□**
	4.7	36.0	36.0	38.0	32.5	—	1.2	20	100	10.5	101PCK475□**
	0.22	21.0	19.0	21.0	17.5	—	1.0	100	500	5.5	121PCK224□**
	0.33	21.0	22.5	24.5	17.5	—	1.0	100	300	6.0	121PCK334□**
	0.47	21.0	26.0	28.0	17.5	—	1.0	100	300	7.0	121PCK474□**
	0.68	21.0	30.5	32.5	17.5	—	1.2	50	200	7.6	121PCK684□**
	1	26.0	29.5	31.5	22.5	—	1.2	50	200	8.0	121PCK105□**
1600 Vdc (161)	1.5	26.0	35.5	37.5	22.5	—	1.2	40	160	10.0	121PCK155□**
	2.2	36.0	33.5	35.5	32.5	—	1.2	40	120	9.4	121PCK225□**
	3.3	36.0	40.0	42.0	32.5	—	1.2	20	80	10.4	121PCK335□**
	0.1	29.0	23.0	25.0	25.0	—	1.2	50	300	6.0	161PCK104□**
	0.15	29.0	27.0	29.0	25.0	—	1.2	50	200	7.0	161PCK154□**
	0.22	35.0	25.0	27.0	31.5	—	1.2	50	200	6.0	161PCK224□**
	0.33	35.0	29.0	31.0	31.5	—	1.2	40	200	8.0	161PCK334□**
2000 Vdc (201)	0.47	35.0	34.0	36.0	31.5	—	1.2	40	120	9.0	161PCK474□**
	0.01	29.0	17.0	19.0	25.0	—	1.0	100	500	2.8	201PCK103□**
	0.015	29.0	19.0	21.0	25.0	—	1.0	100	300	3.9	201PCK153□**
	0.022	29.0	22.0	24.0	25.0	—	1.2	100	300	5.0	201PCK223□**
	0.033	29.0	25.5	27.5	25.0	—	1.2	50	200	6.3	201PCK333□**
	0.047	29.0	30.0	32.0	25.0	—	1.2	50	200	7.4	201PCK473□**
	0.068	35.0	22.0	24.0	31.5	—	1.2	50	250	5.3	201PCK683□**
	0.1	35.0	25.5	27.5	31.5	—	1.2	50	200	6.8	201PCK104□**
0.15	35.0	30.0	32.0	31.5	—	1.2	40	160	7.8	201PCK154□**	
0.22	45.0	31.0	33.0	41.5	—	1.2	20	100	8.7	201PCK224□**	

•For details, please consult our sales offices.

•AC type is also available.